

DETAILS

Product Number	C13353_LEILA-R-CLIP16
Family	Leila
Type	Reflector
Color	white
Diameter	21,6 mm
Height	13 mm
Style	round
Optic Material	HRPC
Holder Material	
Fastening	clips
Status	production ready
ROHS Compliant	Yes
Date Updated	19/02/2013



OPTICAL PROPERTIES

LED	Viewing Angle	Light Beam	Efficiency	cd/lm	Connector
XM-L	77 deg	WWW-class	90 %	0.600	-
XT-E	72 deg	WWW-class	93 %	0.700	-
XB-D	73 deg	WWW-class	92 %	0.700	-
XM-L2	79 deg	WWW-class	92 %	0.600	-
XP-G2	77 deg	WWW-class	92 %	0.600	-
XP-L HI	74 deg	WWW-class	92 %	0.640	-
LUXEON Rebel ES	74 deg	WWW-class	93 %	0.600	-
LUXEON Rebel	73 deg	WWW-class	92 %	0.700	-
LUXEON R	74 deg	WWW-class	93 %	0.600	-
LUXEON A	75 deg	WWW-class	93 %	0.600	-
LUXEON Z ES	73 deg	WWW-class	92 %	0.800	-
LUXEON Q	70 deg	WWW-class	88 %	0.700	-
LUXEON C	76 deg	WWW-class	92 %	0.680	-
NCSxx19A	72 deg	WWW-class	93 %	0.600	-
NVSxx19A	73 deg	WWW-class	93 %	0.600	-
NS9x383	74 deg	WWW-class	91 %	0.600	-
NF2x757A	75 deg	WWW-class	92 %	0.700	-
Oslon Square PC	74 deg	WWW-class	93 %	0.600	-
Z8Y19	71 deg	WWW-class	91 %	0.686	-
Z8Y15	71 deg	WWW-class	91 %	0.714	-

Relative intensity of C13353_LEILA-R-CLIP16_(Luxeon Z ES)

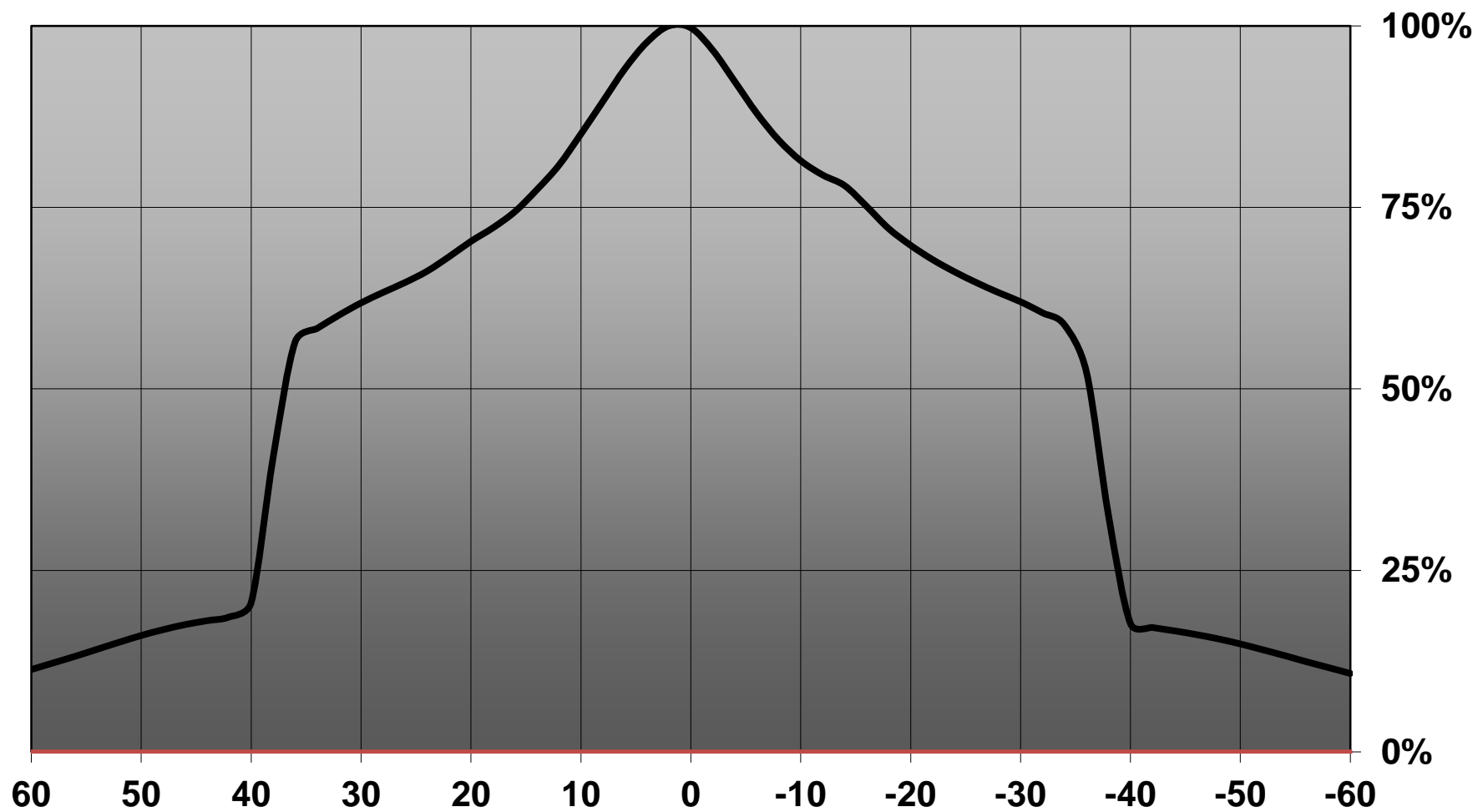

Relative intensity of C13353_LEILA-R-CLIP16_(Luxeon_C_White)

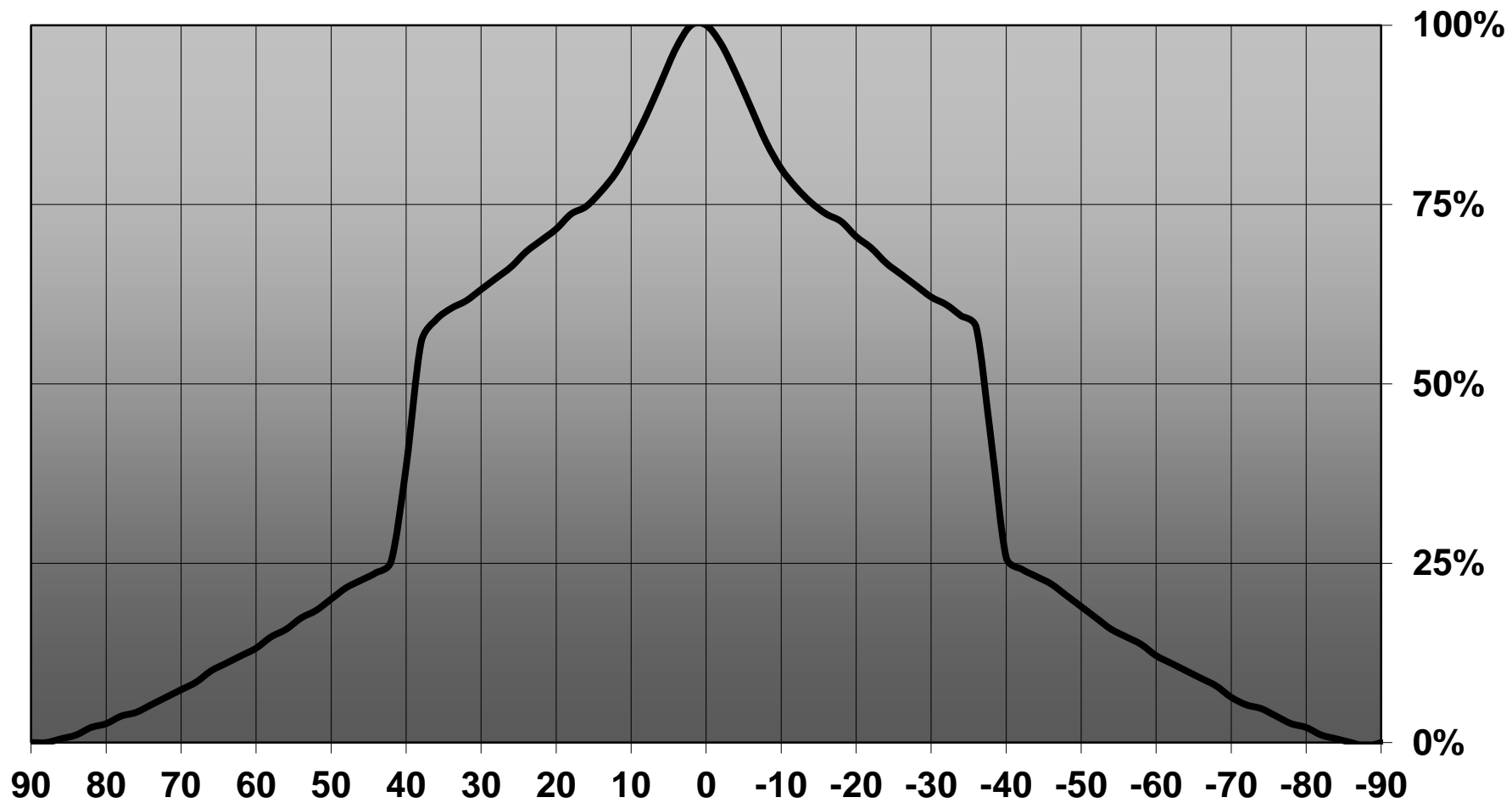

Relative intensity of C13353_LEILA-R-CLIP16_(NF2x757A)

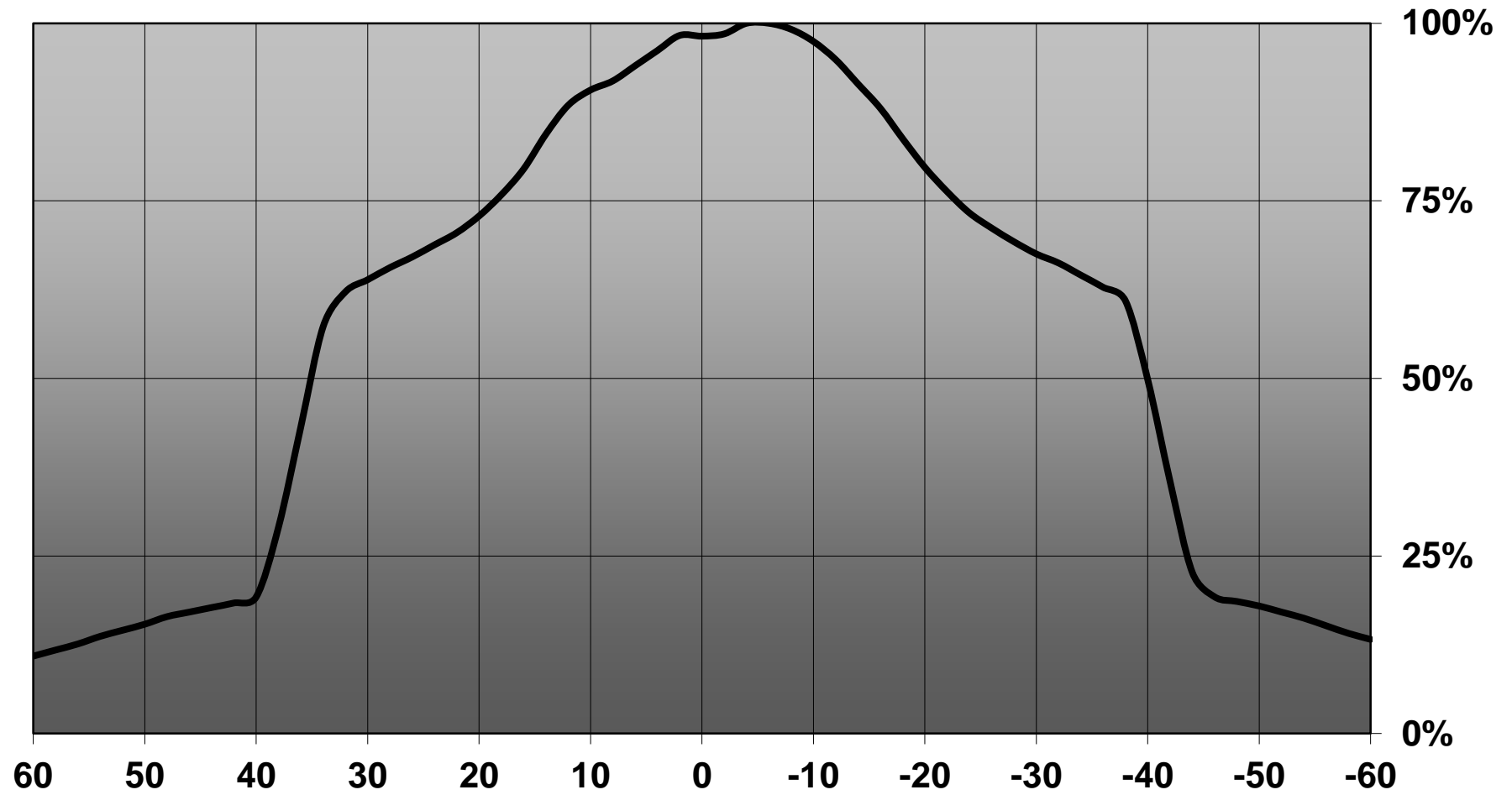

Relative intensity of C13353_LEILA-R-CLIP16_(SZ8_Y19)

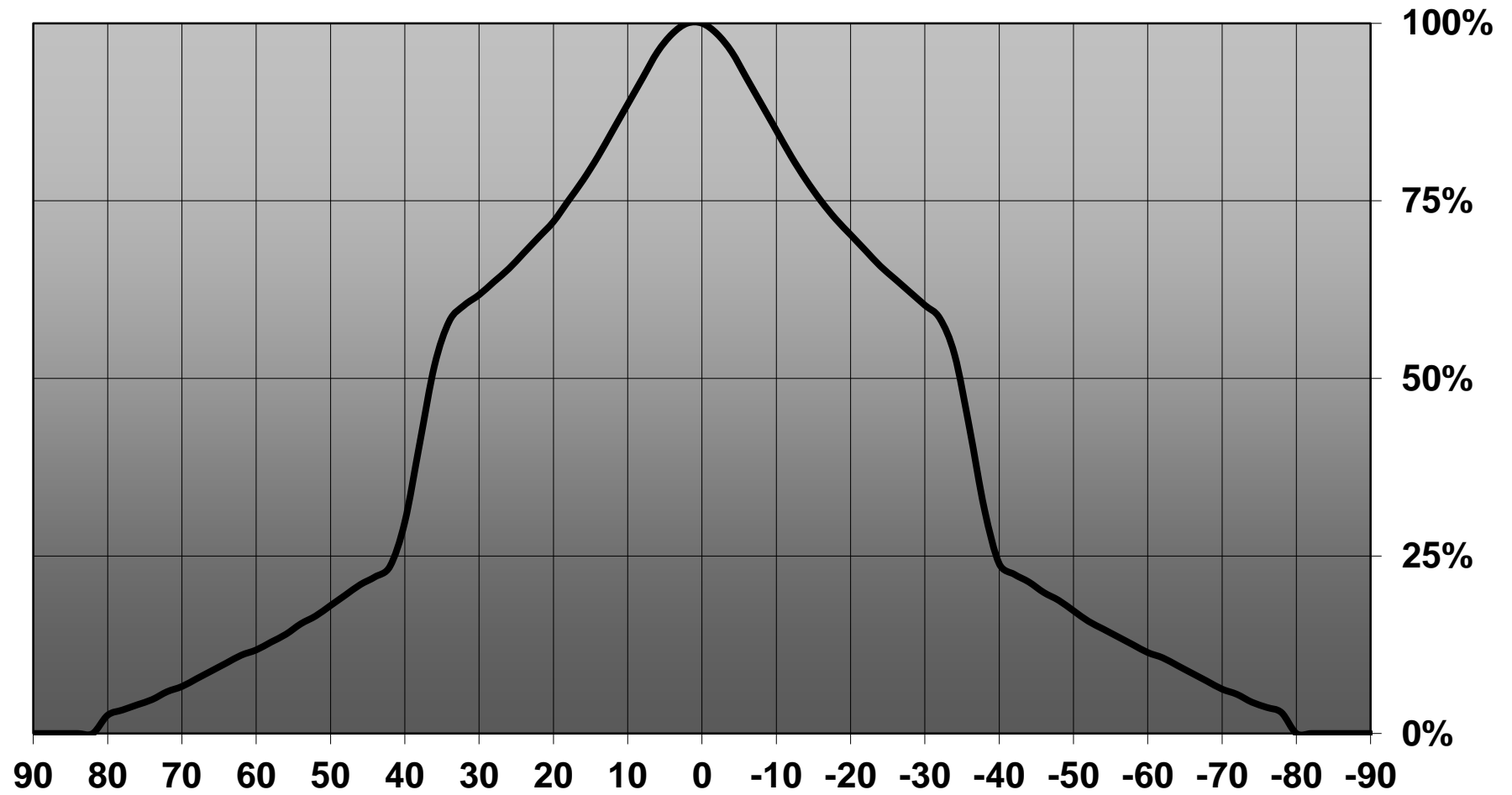

Relative intensity of C13353_LEILA-R-CLIP16_(SZ8_Y15)

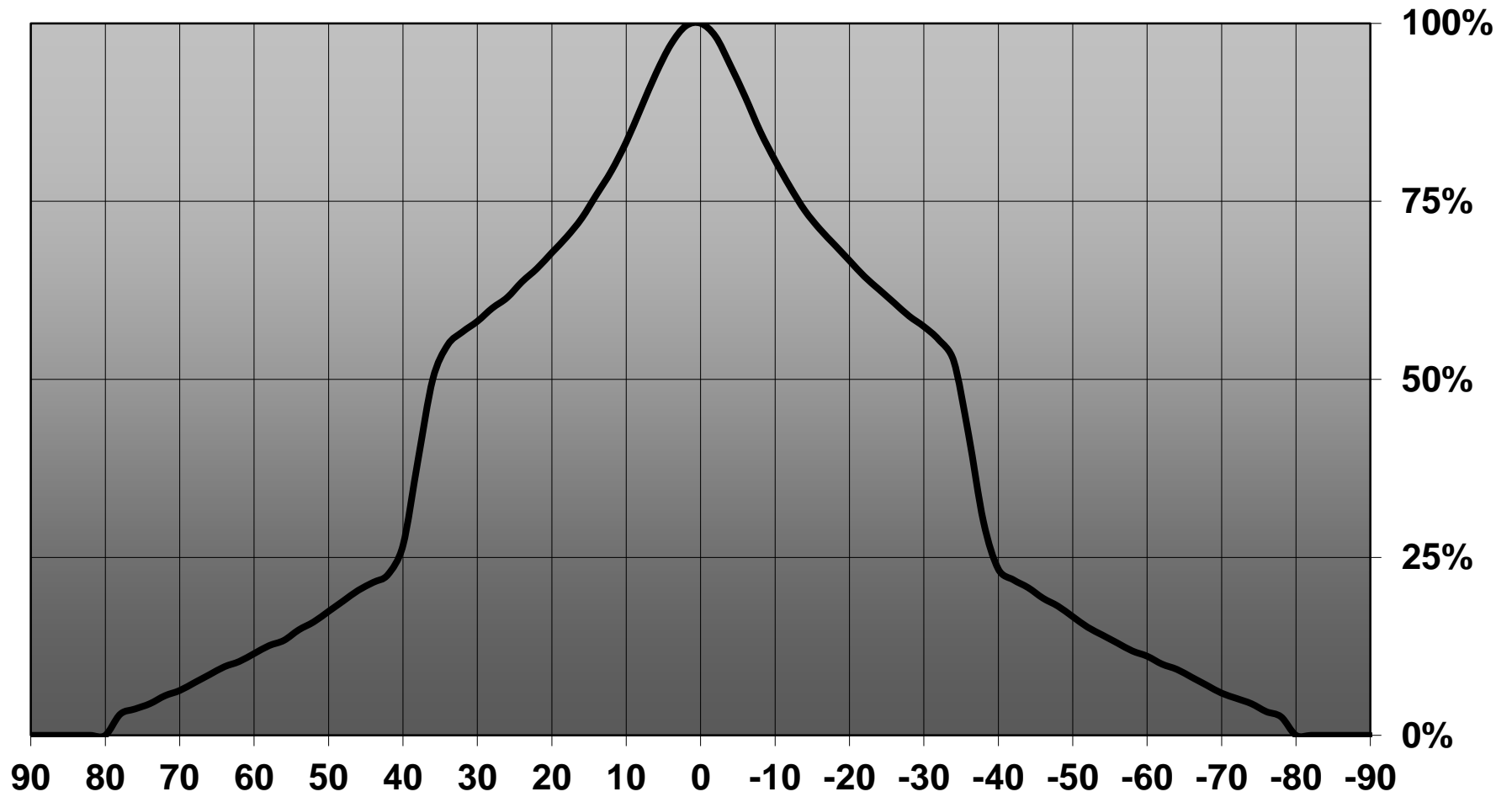

H G F E D C B A

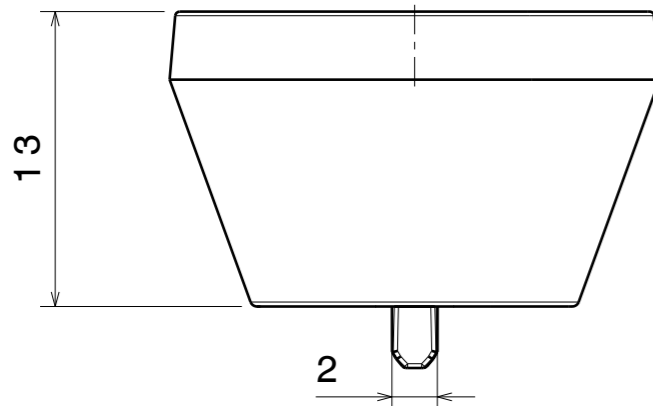

Front view

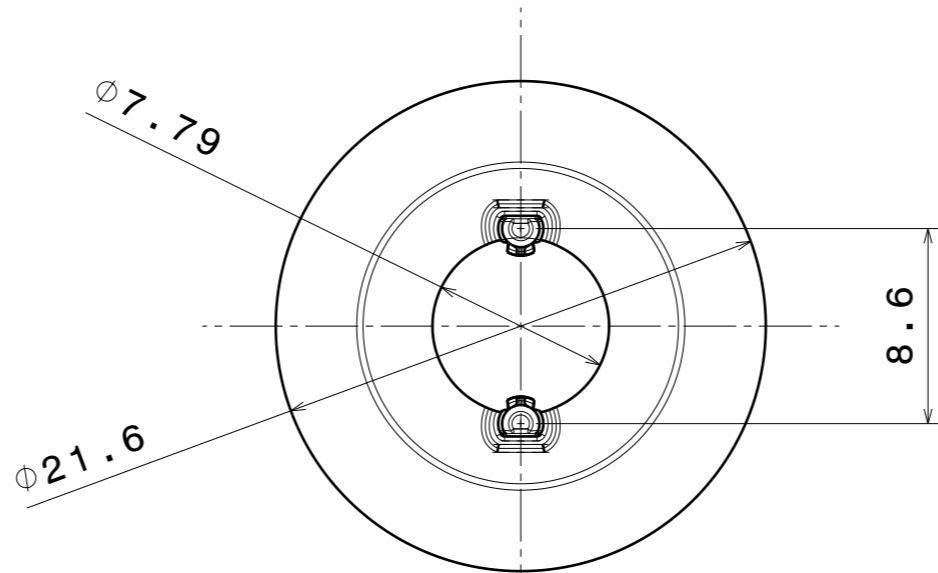

Bottom view

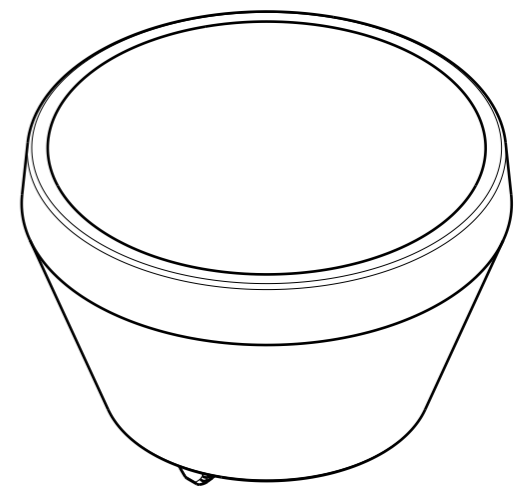

Isometric view

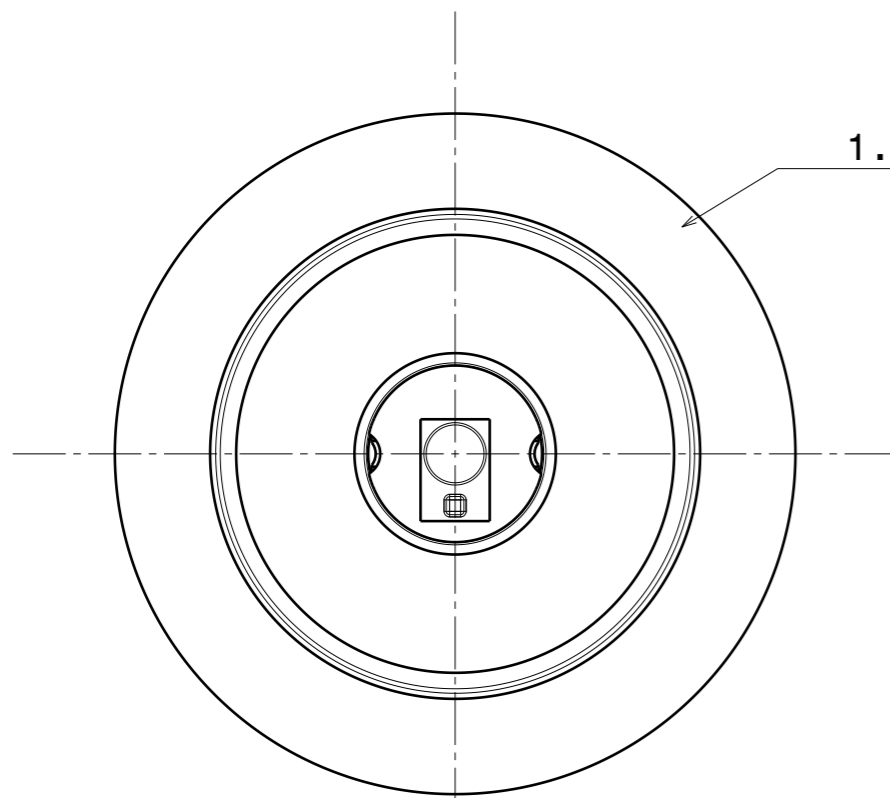

Top view

1.6 mm PCB

INDEX	PART NO	DESCRIPTION	MATERIAL	COLOUR
1	C13353	LEILA-R-CLIP16	pc, high reflectivity	white

Tolerances if not otherwise shown
 According to DIN ISO 2768-1
 Linear measures:
 Up to 30mm class M, otherwise class C.
 According to DIN ISO 2768-2
 Form and position: class L

LEDiL LediL Oy
 Salorankatu 10
 FIN 24240 SALO
 Finland

THIRD ANGLE PROJECTION:

DRAWING TITLE
C13353_LEILA-R-CLIP16

This drawing is the property of LEDiL Oy. It may not be reproduced, copied or communicated without a written agreement with LEDiL Oy."

SIZE	PART NUMBER
A3	C13353

SCALE	3:1	WEIGHT	-	SHEET	1/1
-------	-----	--------	---	-------	-----

H G B A

Luminaire: LEDiL Oy C13353_LEILA-R-CLIP16
Lamps: 1 x Cree XML 90.6lm @ 250mA

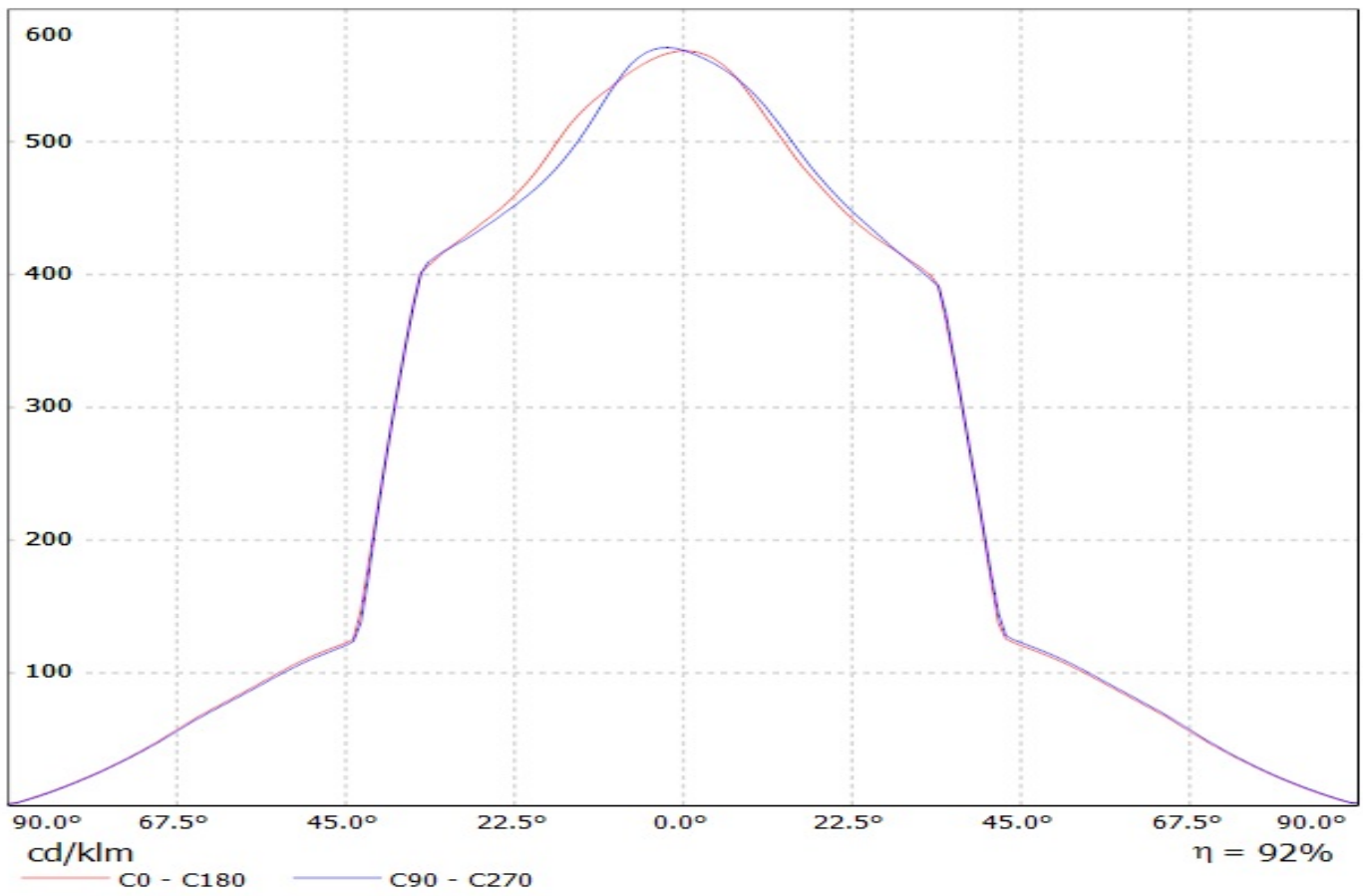

Luminaire: LEDiL Oy C13353_LEILA-R-CLIP16
Lamps: 1 x Cree XTE 100lm @ 250mA

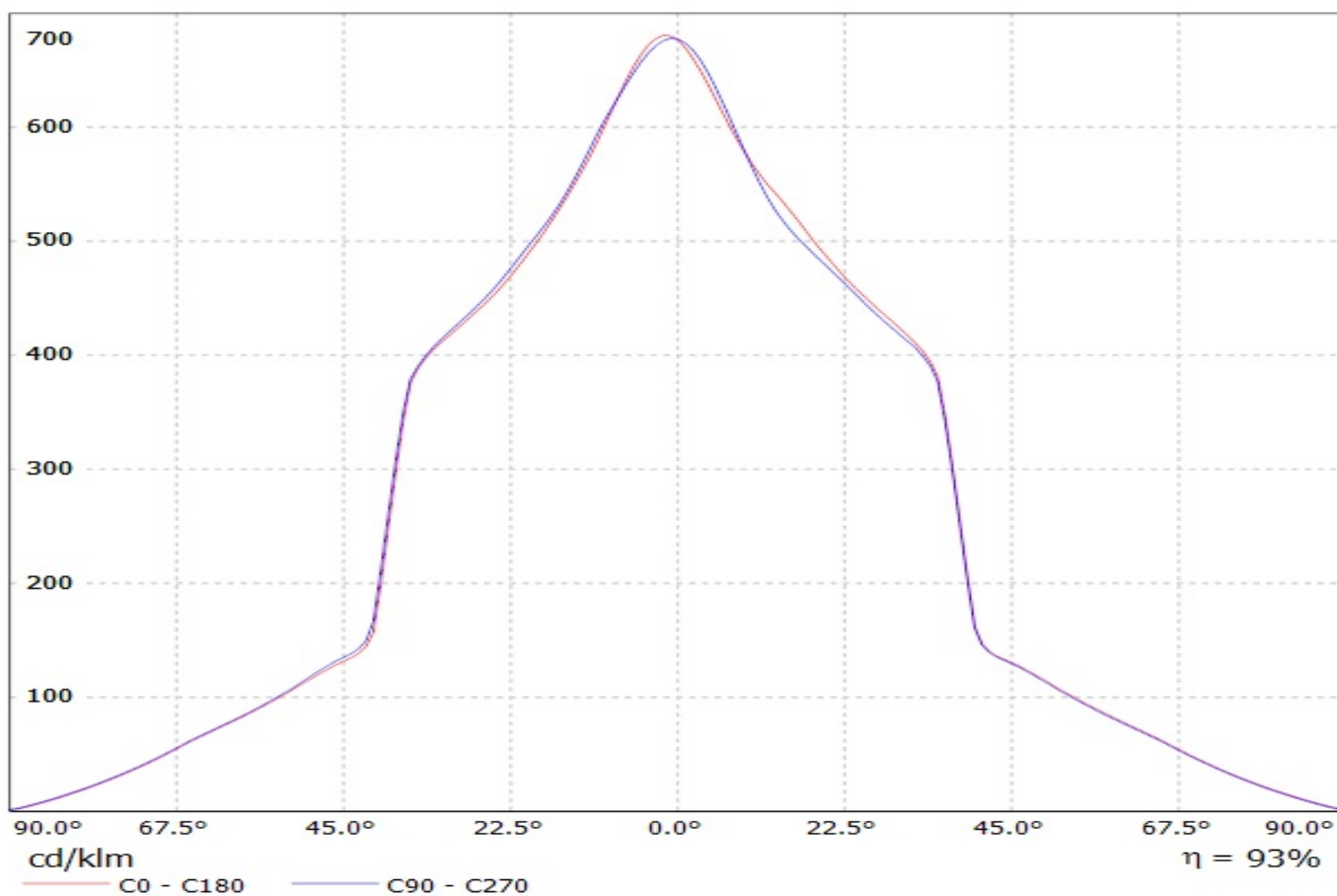

Luminaire: LEDiL Oy C13353_LEILA-R-CLIP16
Lamps: 1 x Cree XBD 92.5lm @ 250mA

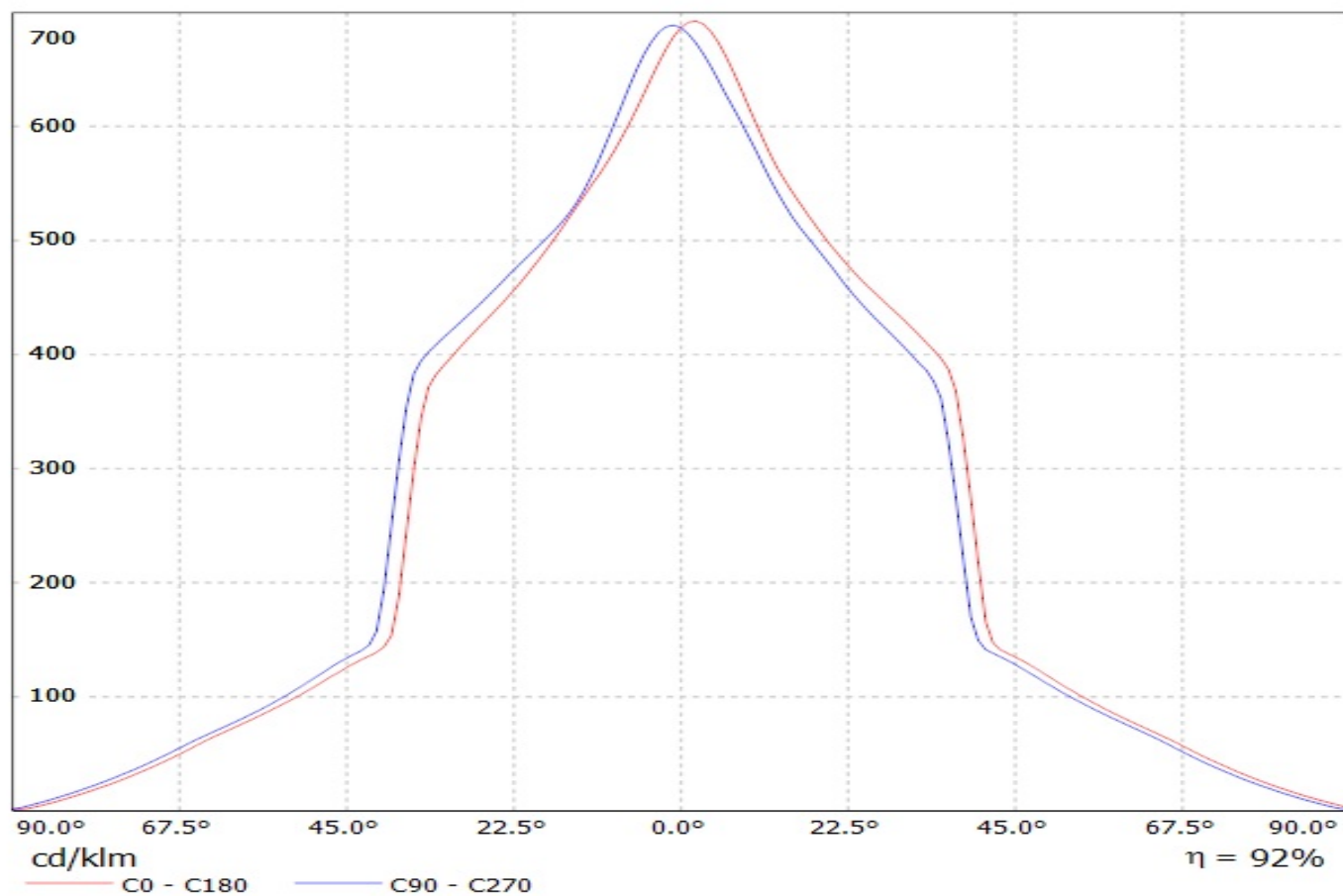

Luminaire: LEDil Oy C13353_LEILA-R-CLIP16_(XM-L2) Efficiency=92%
Lamps: 1 x Cree XM-L2 (XMLBWT-0-7B4-T30-0L-0001) 91lm @ 250mA CCT=3200K P=0.7W I=250mA

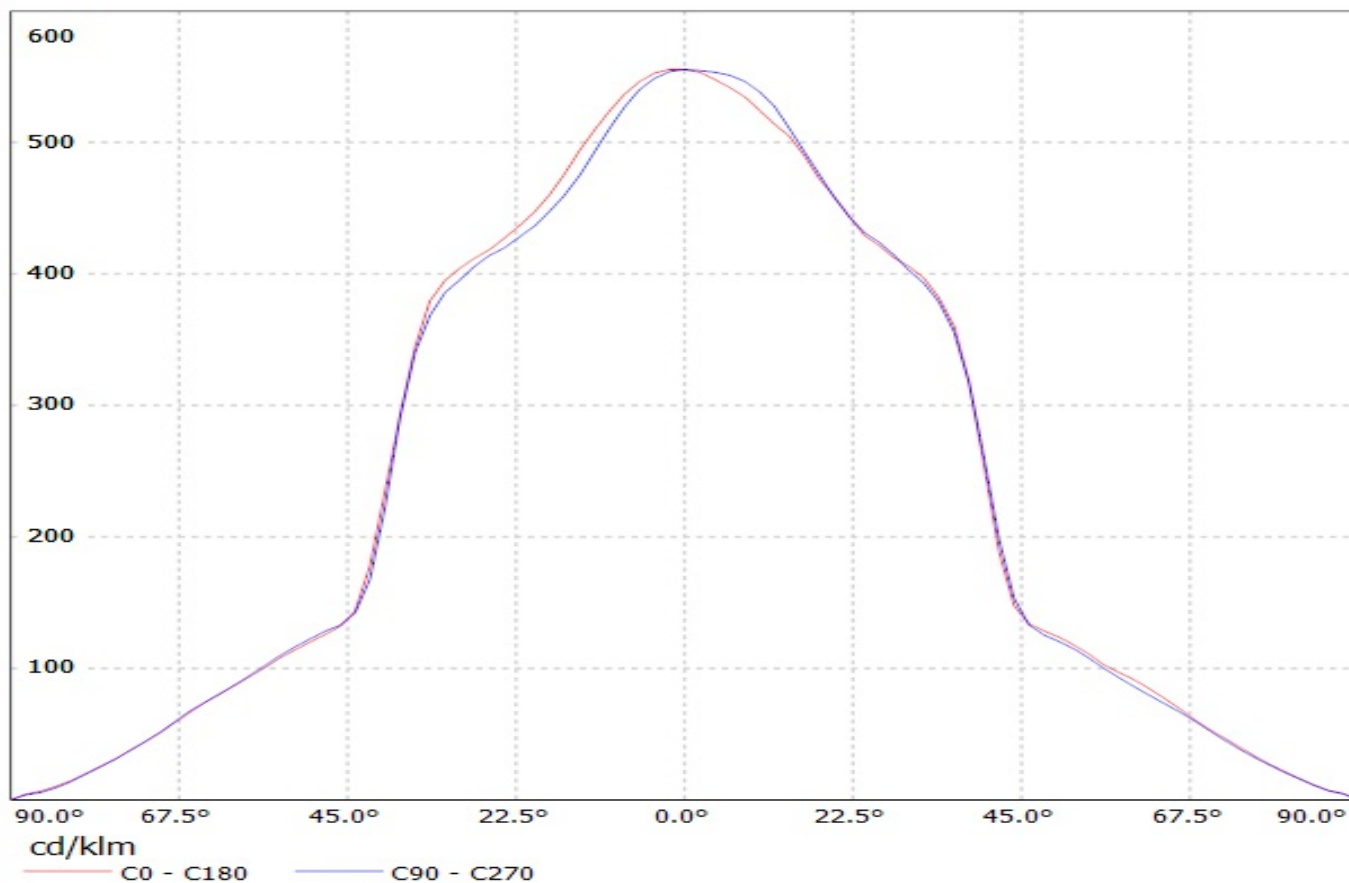

Luminaire: LEDil Oy C13353_LEILA-R-CLIP16_(XP-G2) Efficiency=92%
Lamps: 1 x CREE XP-G2 (XPGBWT-L1-0000-00FE4) 101lm @ 250mA CCT=6600K P=0.7W I=250mA

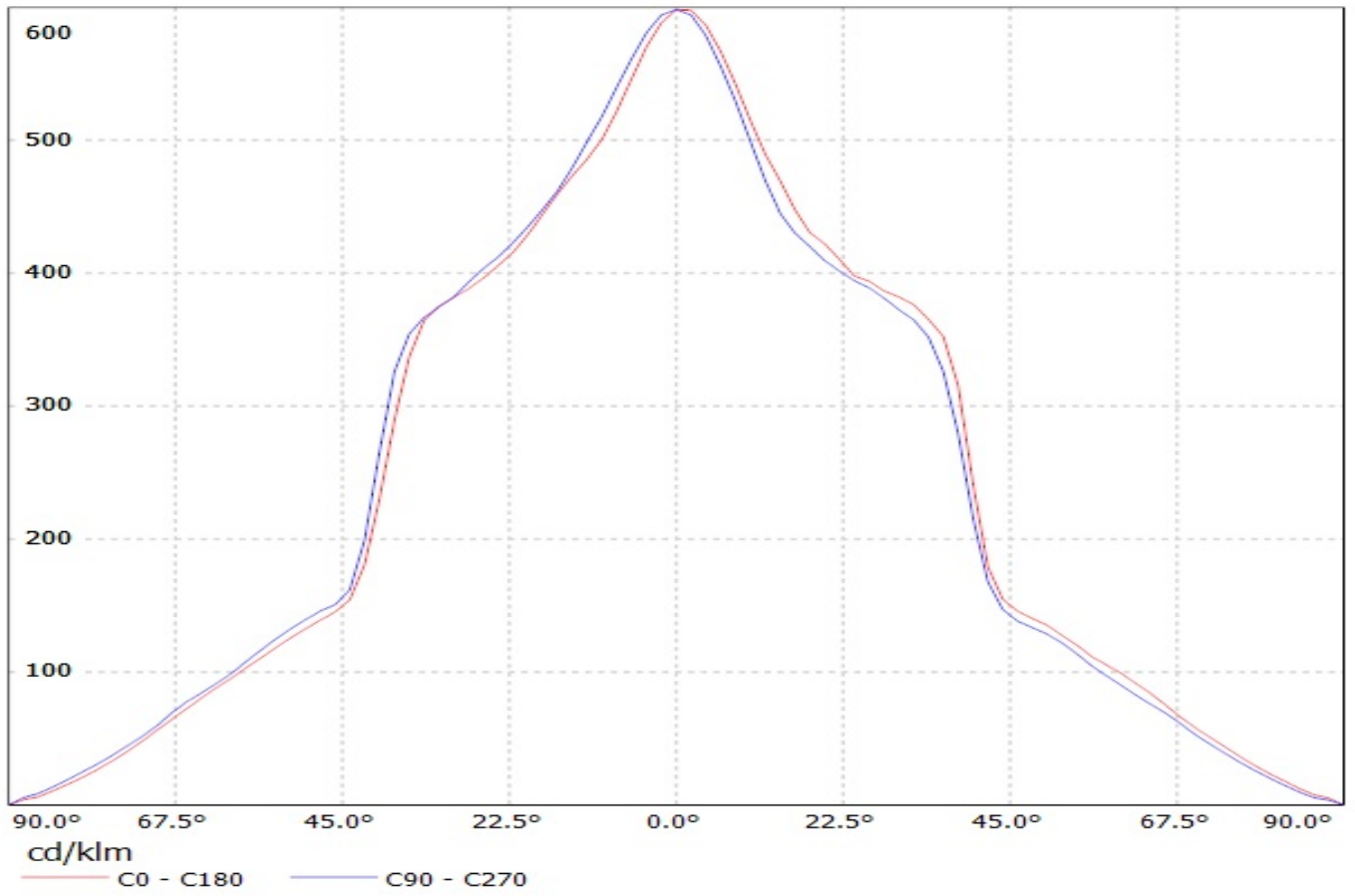

Ledil C13353_LEILA-R-CLIP16_(XP-L_HI) / LDC (Linear)

Luminaire: Ledil C13353_LEILA-R-CLIP16_(XP-L_HI)

Lamps: 1 x CREE_XP-L_HI_116.971lm@250mA_P=0.75W_I=0.25A

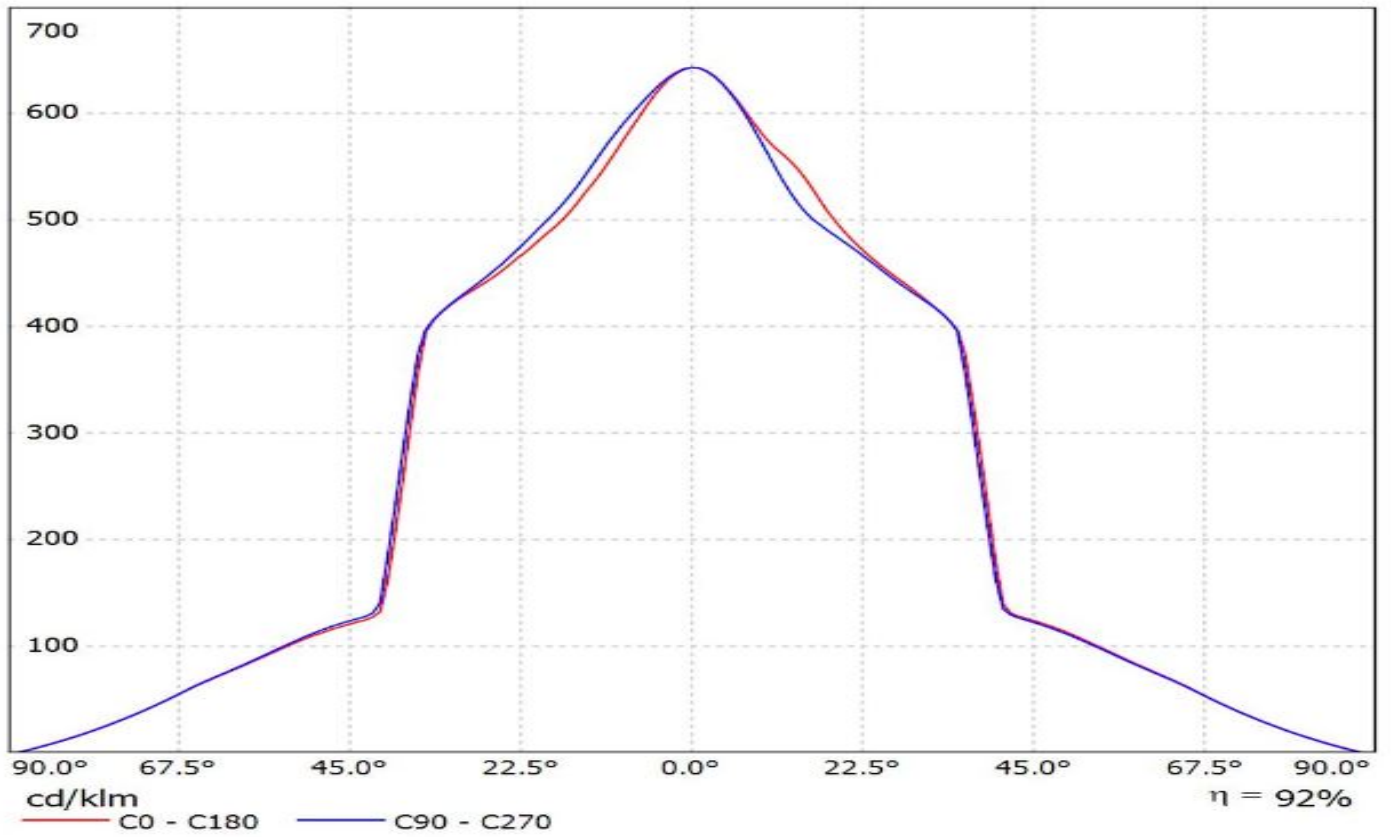

Luminaire: LEDiL Oy C13353_LEILA-R-CLIP16
Lamps: 1 x Luxeon Rebel-ES 91lm @ 250mA

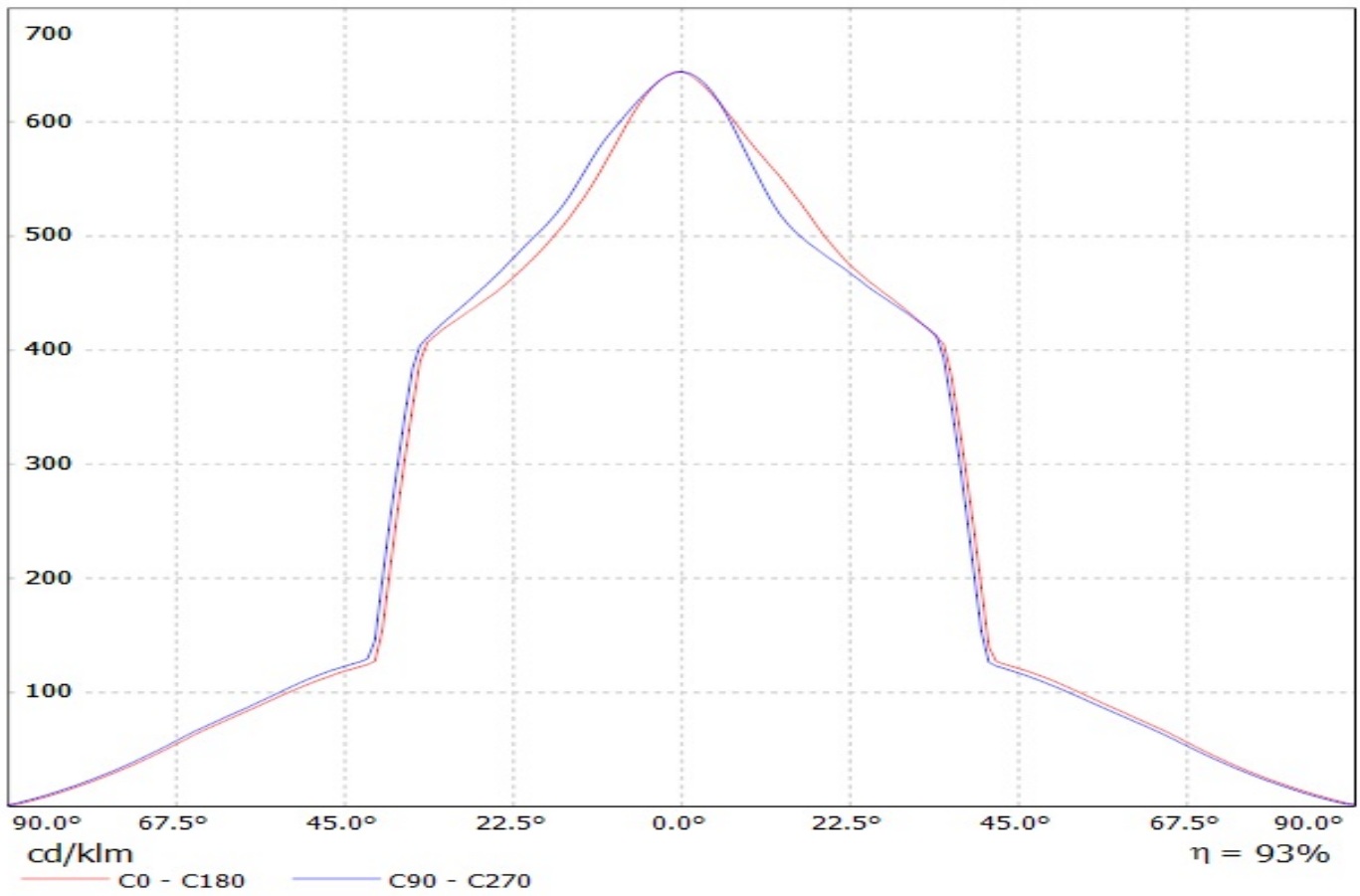

Luminaire: LEDiL Oy C13353_LEILA-R-CLIP16
Lamps: 1 x Luxeon Rebel 80.7lm @ 250mA

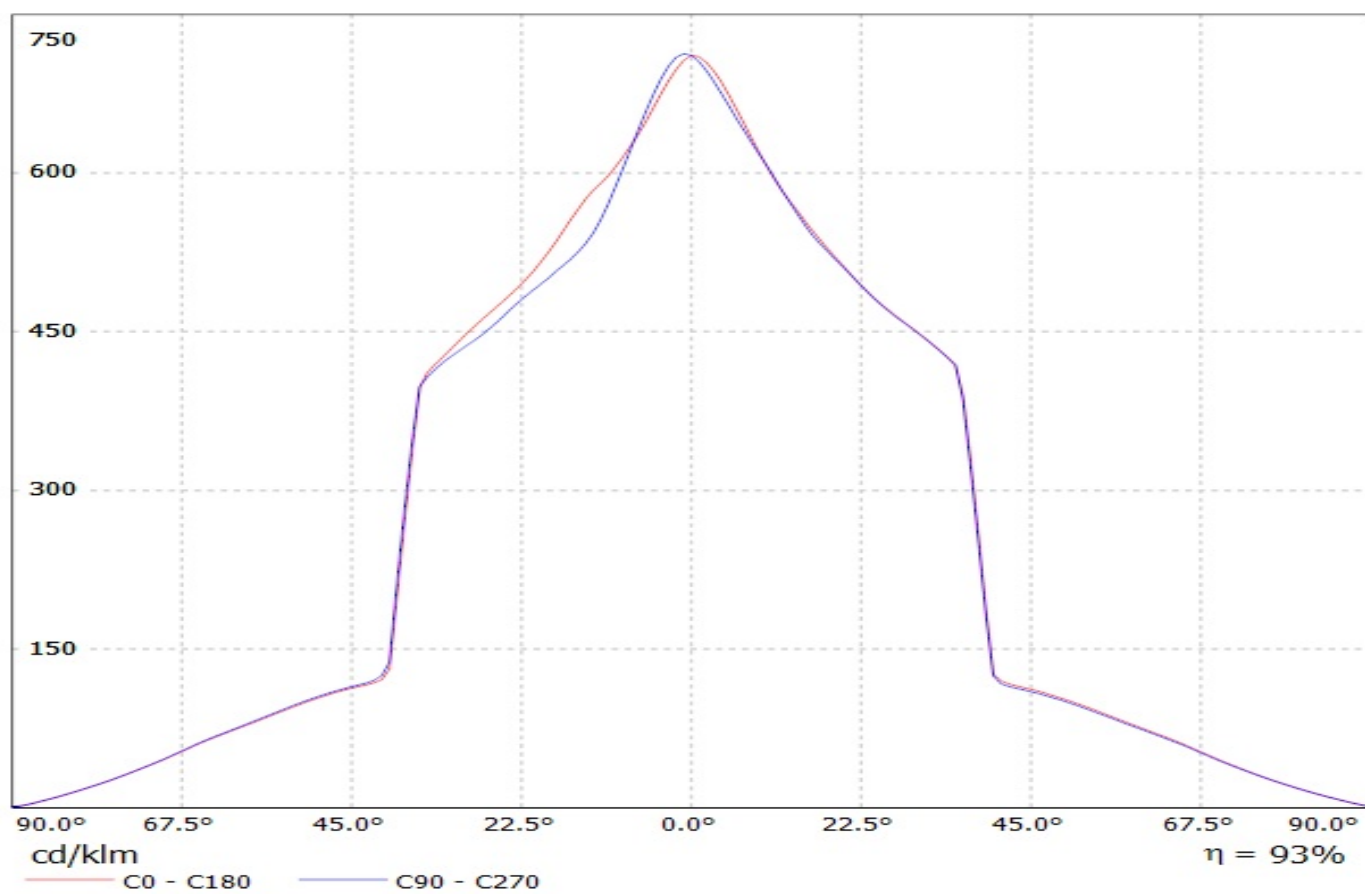

Luminaire: LEDiL Oy C13353_LEILA-R-CLIP16
Lamps: 1 x Luxeon R 85lm @ 250mA

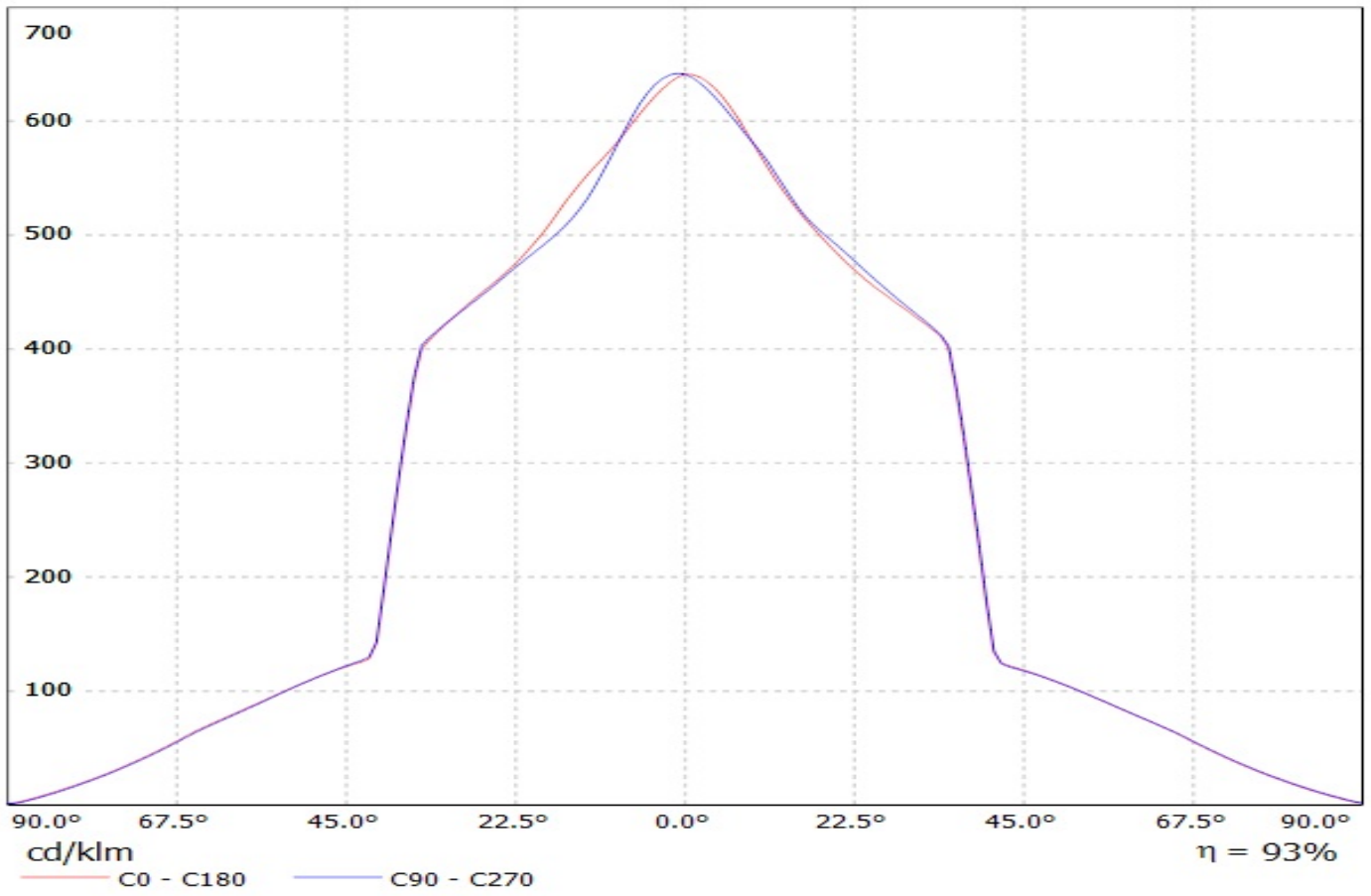

Luminaire: LEDiL Oy C13353_LEILA-R-CLIP16
Lamps: 1 x Luxeon A 65.7lm @ 250mA

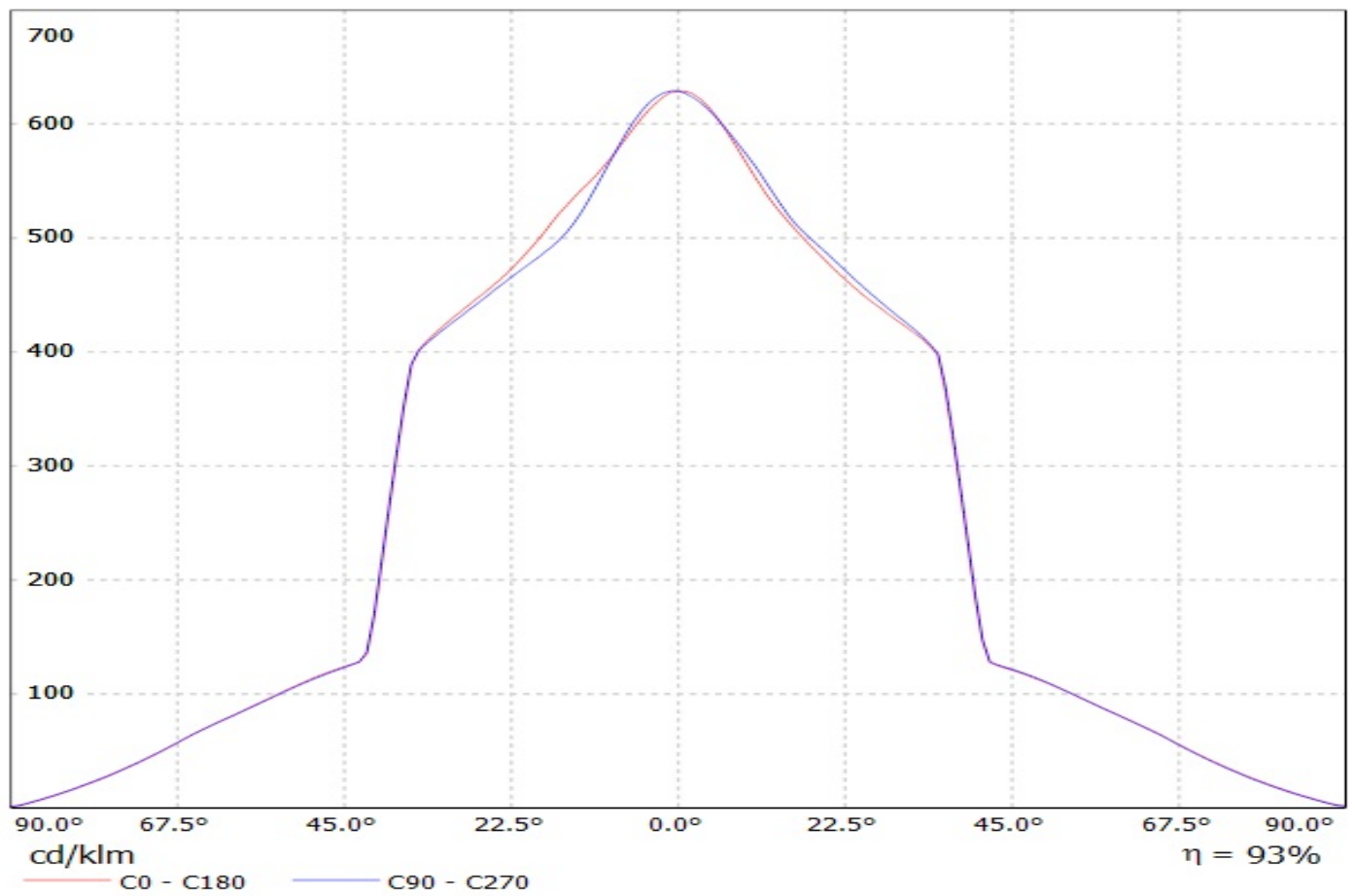

Luminaire: LEDiL Oy C13353_LEILA-R-CLIP16_(LUXEON_Q) Eff: 88%
Lamps: 1 x LUXEON_Q_(LHQ-3080)_76.0112lm@250mA_P=0.753249W_I=249.9mA

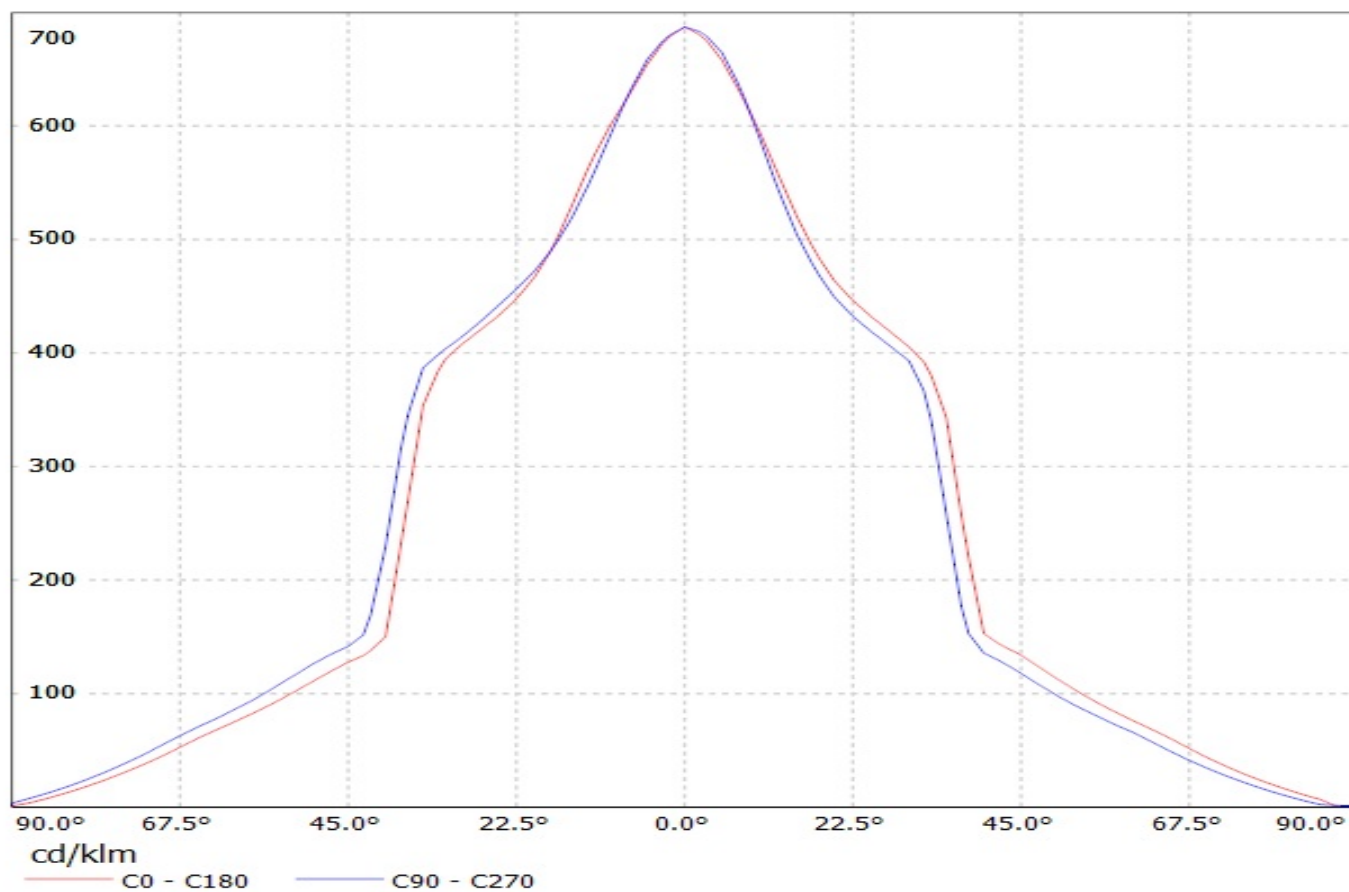

Luminaire: LEDiL Oy C13353_LEILA-R-CLIP16
Lamps: 1 x Nichia NCS19 88lm 2 250mA

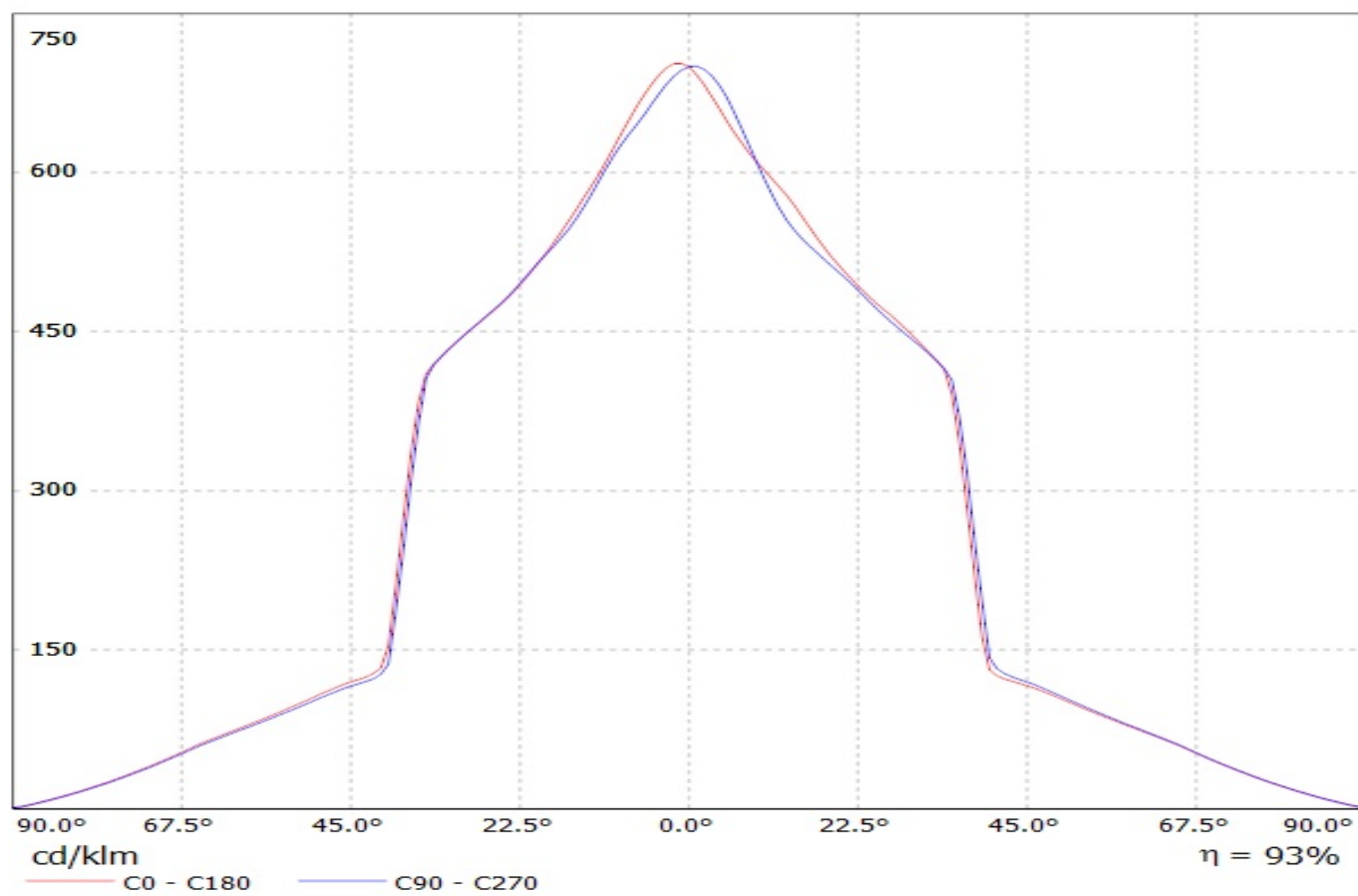

Luminaire: LEDiL Oy C13353_LEILA-R-CLIP16
Lamps: 1 x Nichia NVS 97.6lm @ 250mA

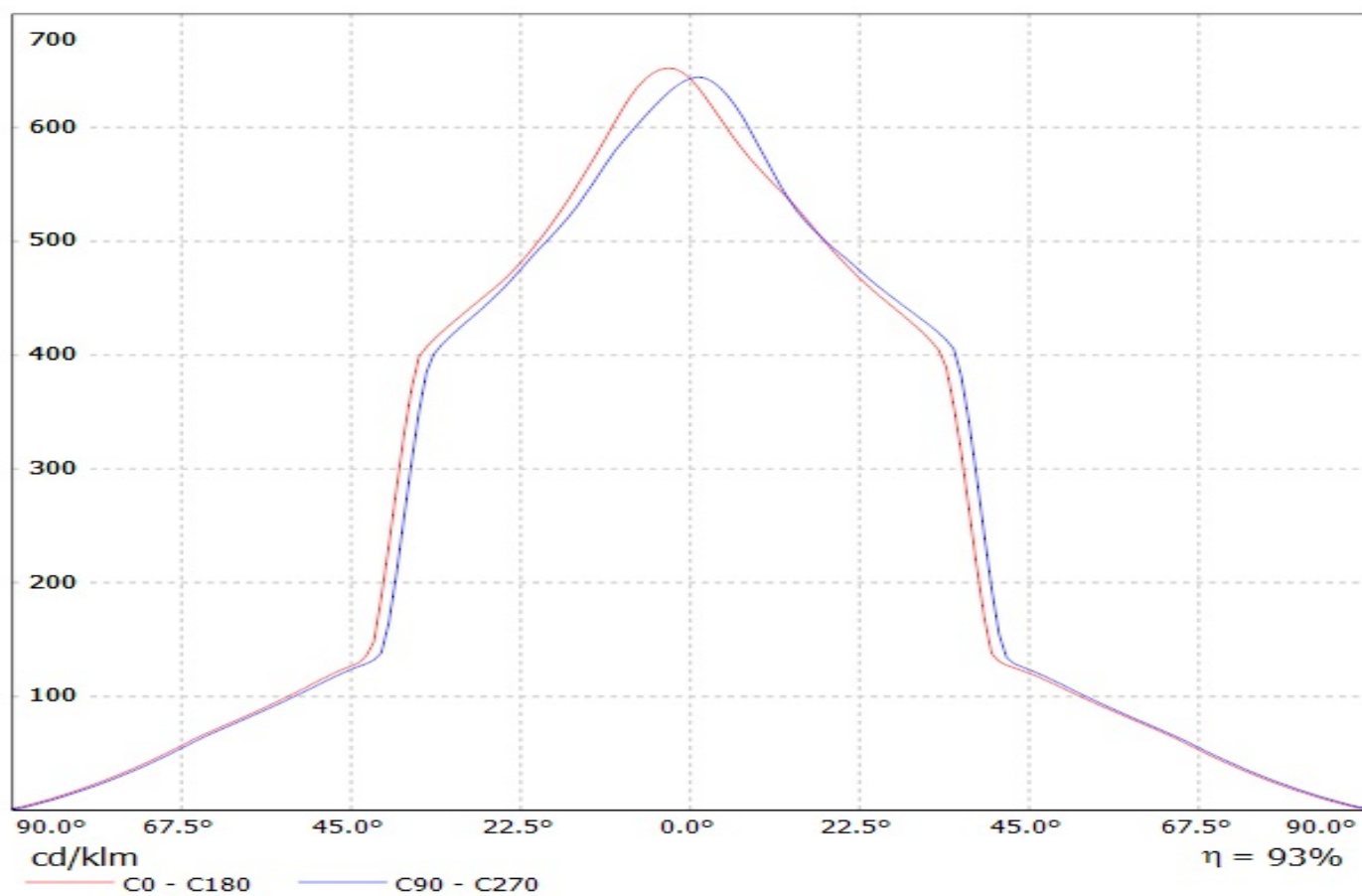

Luminaire: LEDiL Oy C13353_LEILA-R-CLIP16_(NS9x383) Eff. 90,9%
Lamps: 1 x Nichia NS9x383 (105lm@250mA)

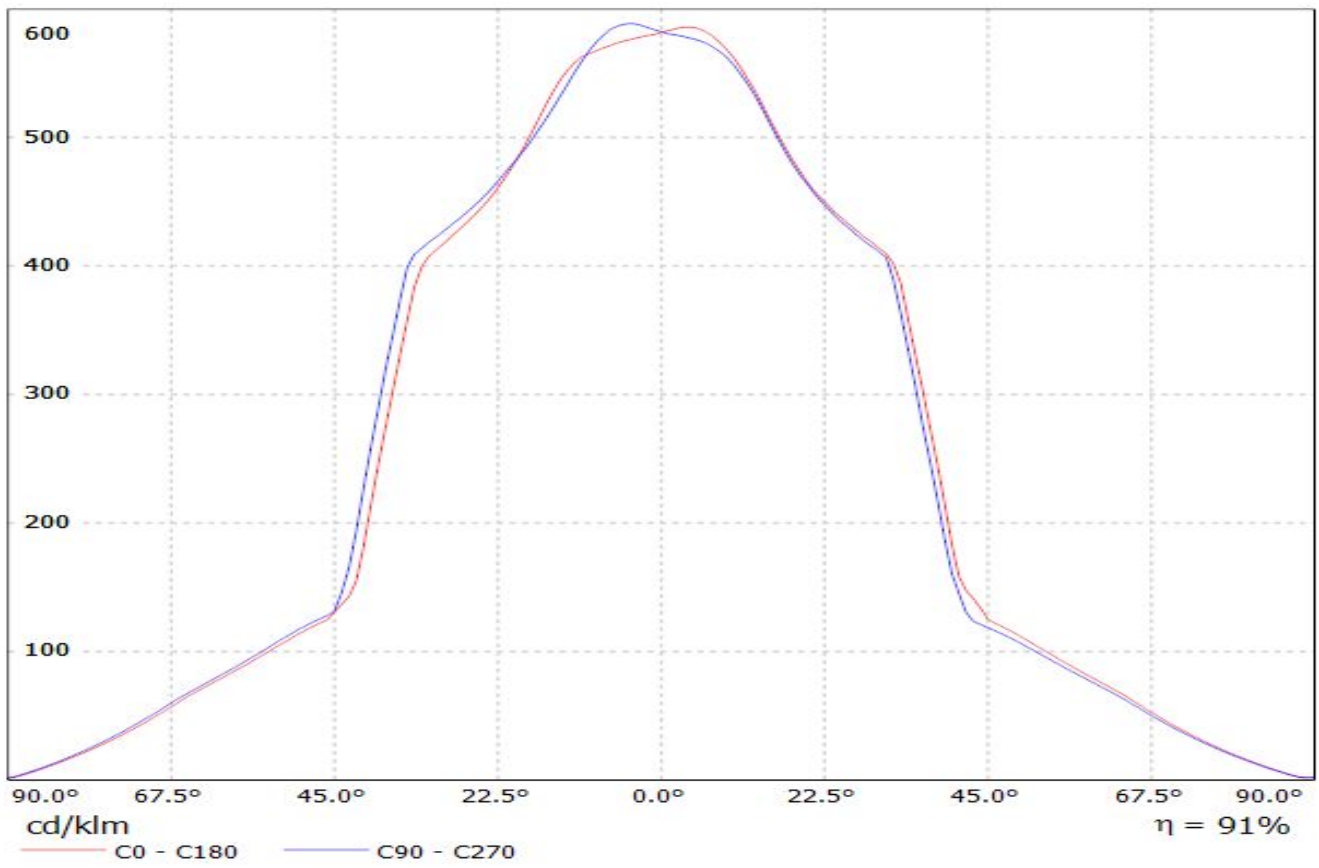

Luminaire: LEDiL Oy C13353_LEILA-R-CLIP16
Lamps: 1 x Osram Square PC 79lm @ 250mA

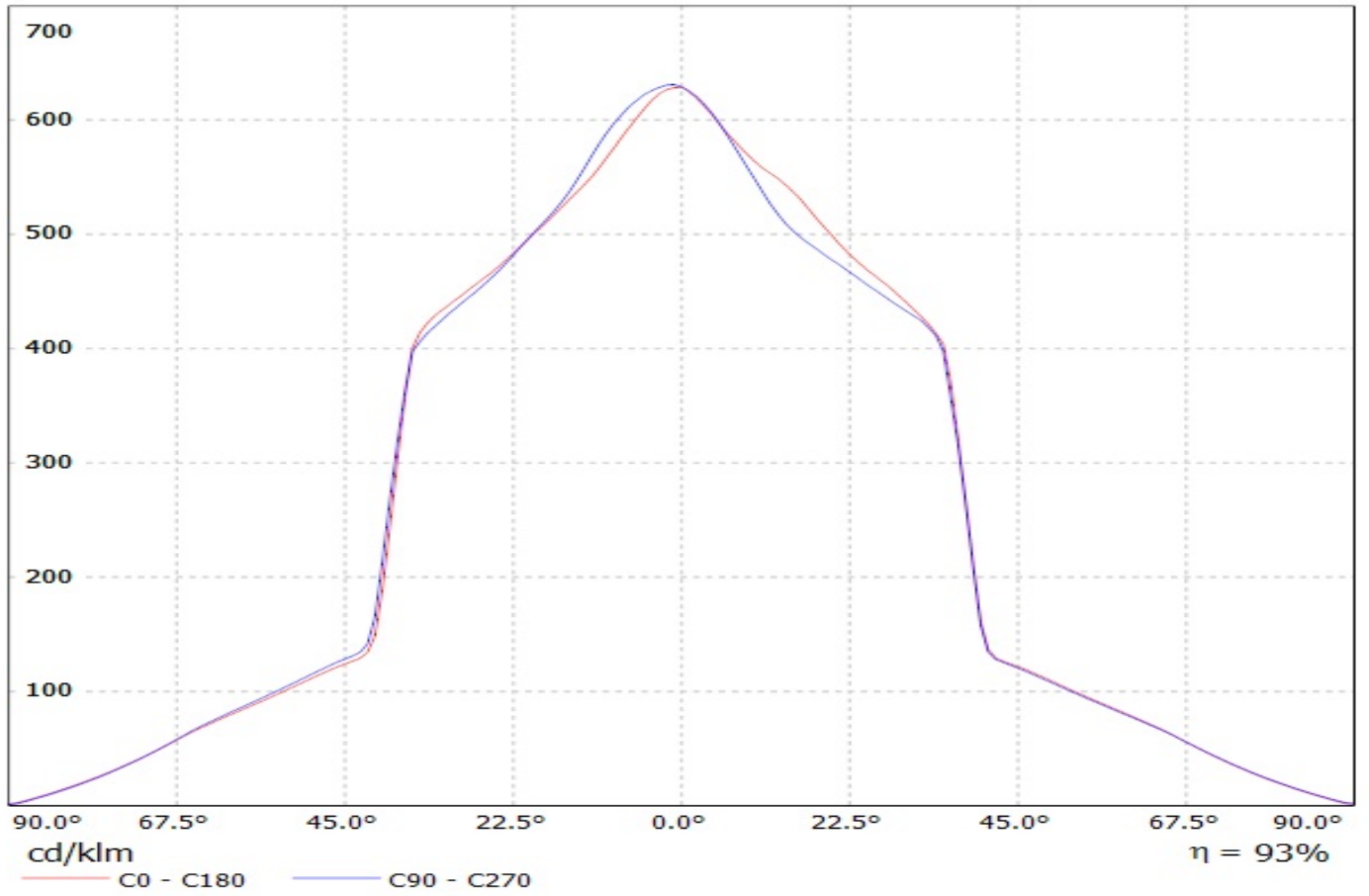

Luminaire: Ledil C13353_LEILA-R-CLIP16_(Z8Y19)

Lamps: 1 x Seoul_Z8Y19_111.337lm@250mA_P=0.7402W_I=0.25

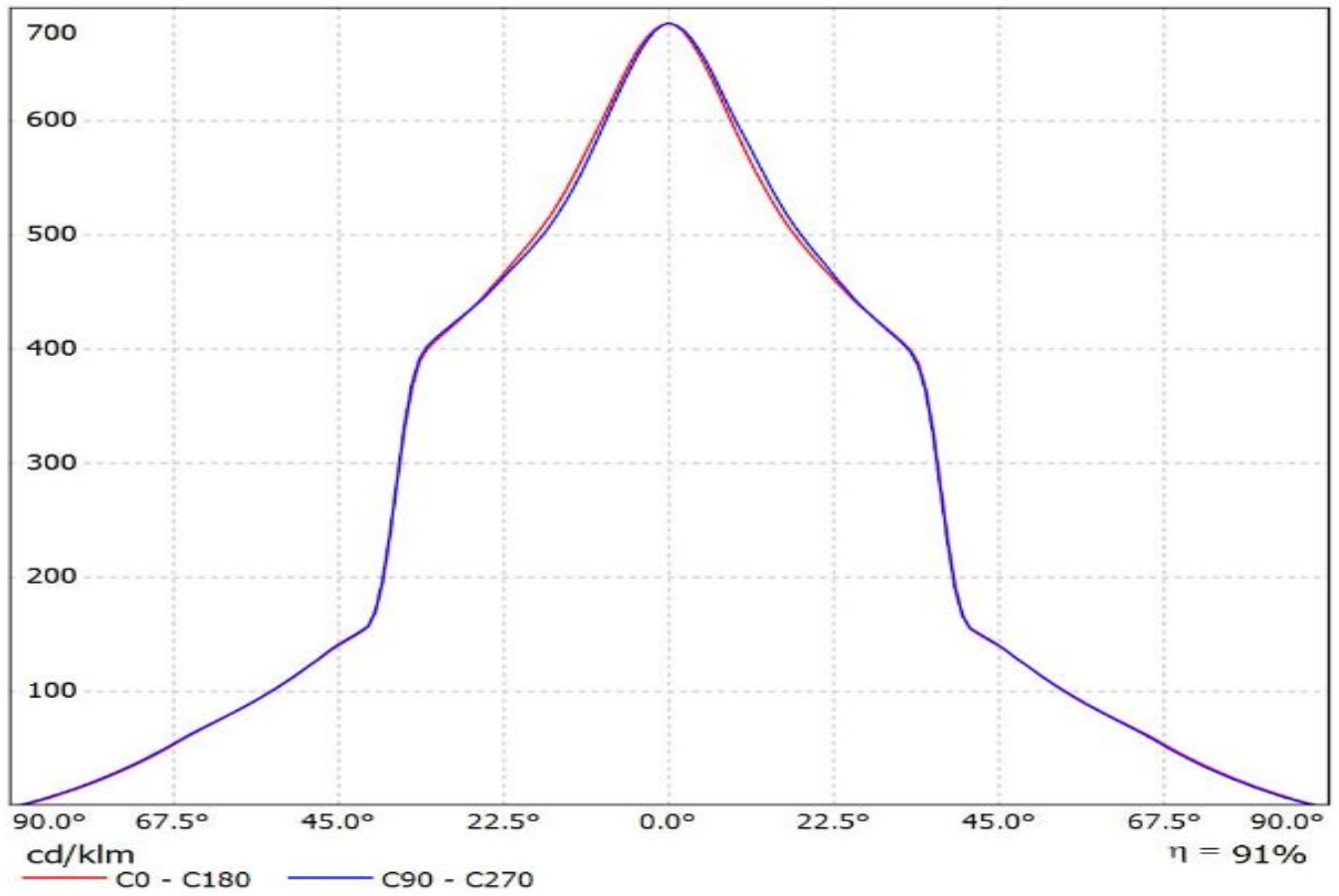

Luminaire: Ledil C13353_LEILA-R-CLIP16_(Z8Y15)
Lamps: 1 x Seoul_Z8Y15_99.8967lm@250mA_P=0.7569W_I=0.25A

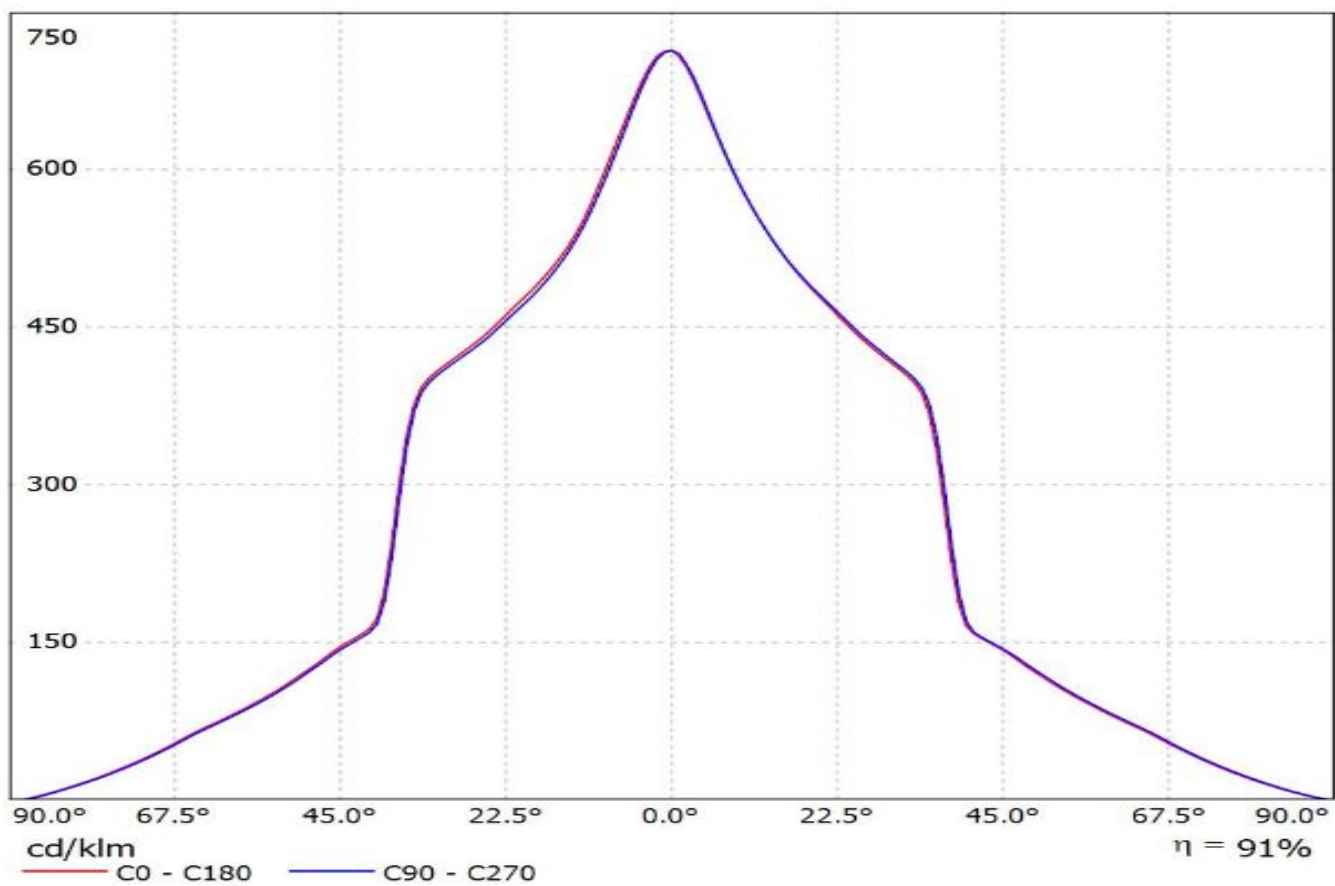

Luminaire: LEDiL Oy C13353_LEILA-R-CLIP16
Lamps: 1 x Cree XML 90.6lm @ 250mA

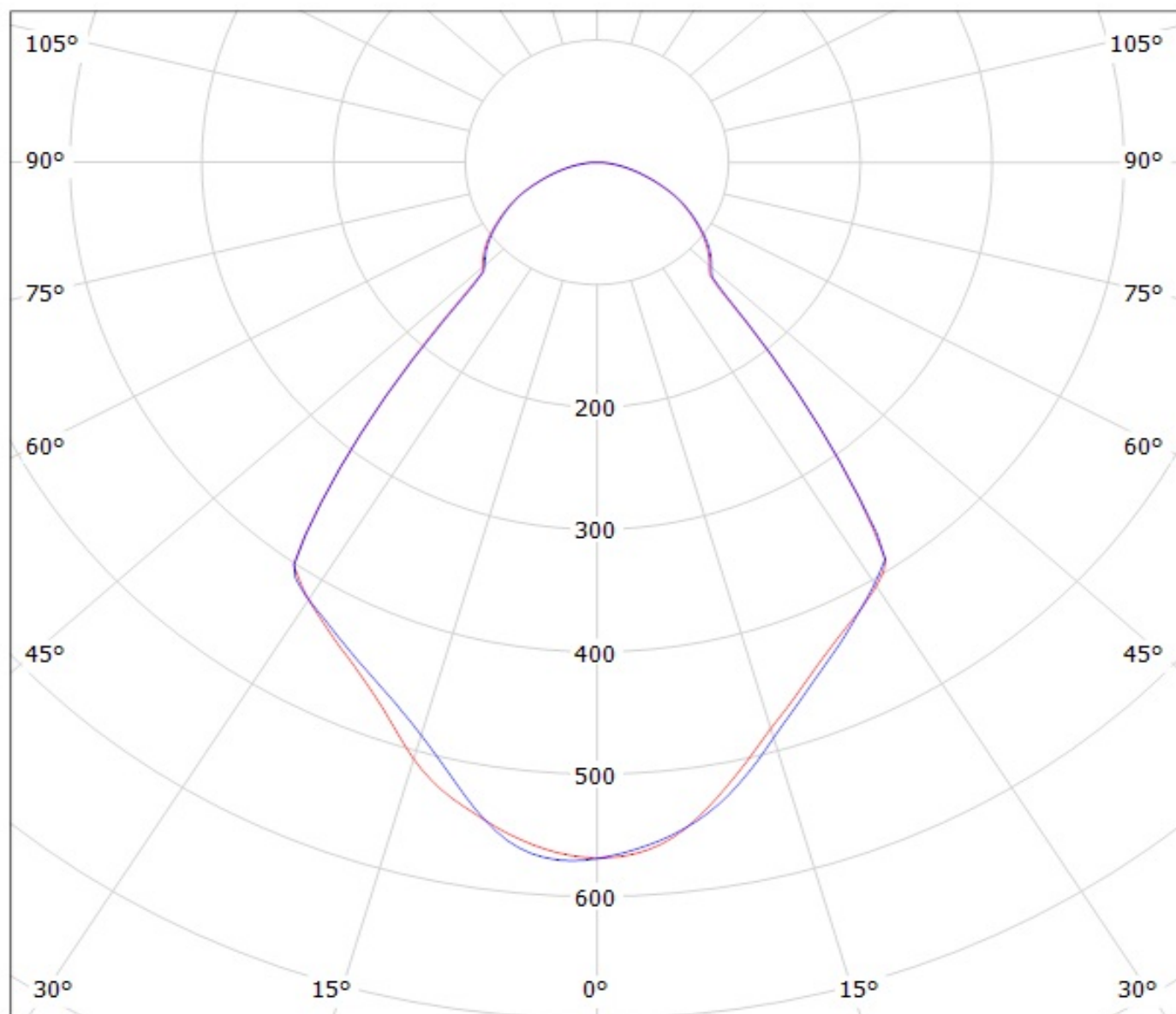

cd/klm

— C0 - C180

— C90 - C270

$\eta = 92\%$

Luminaire: LEDiL Oy C13353_LEILA-R-CLIP16
Lamps: 1 x Cree XTE 100lm @ 250mA

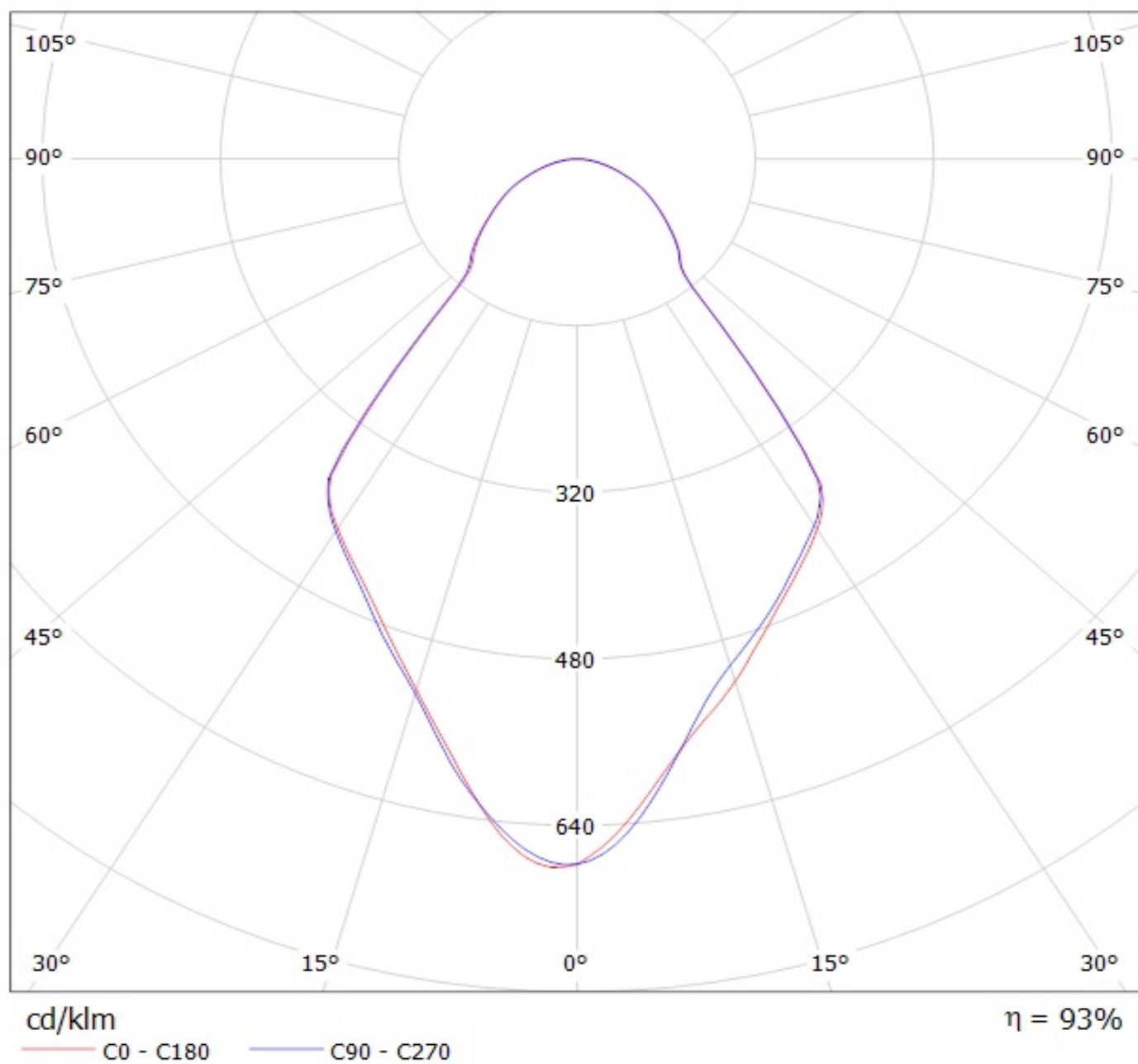

Luminaire: LEDiL Oy C13353_LEILA-R-CLIP16
Lamps: 1 x Cree XBD 92.5lm @ 250mA

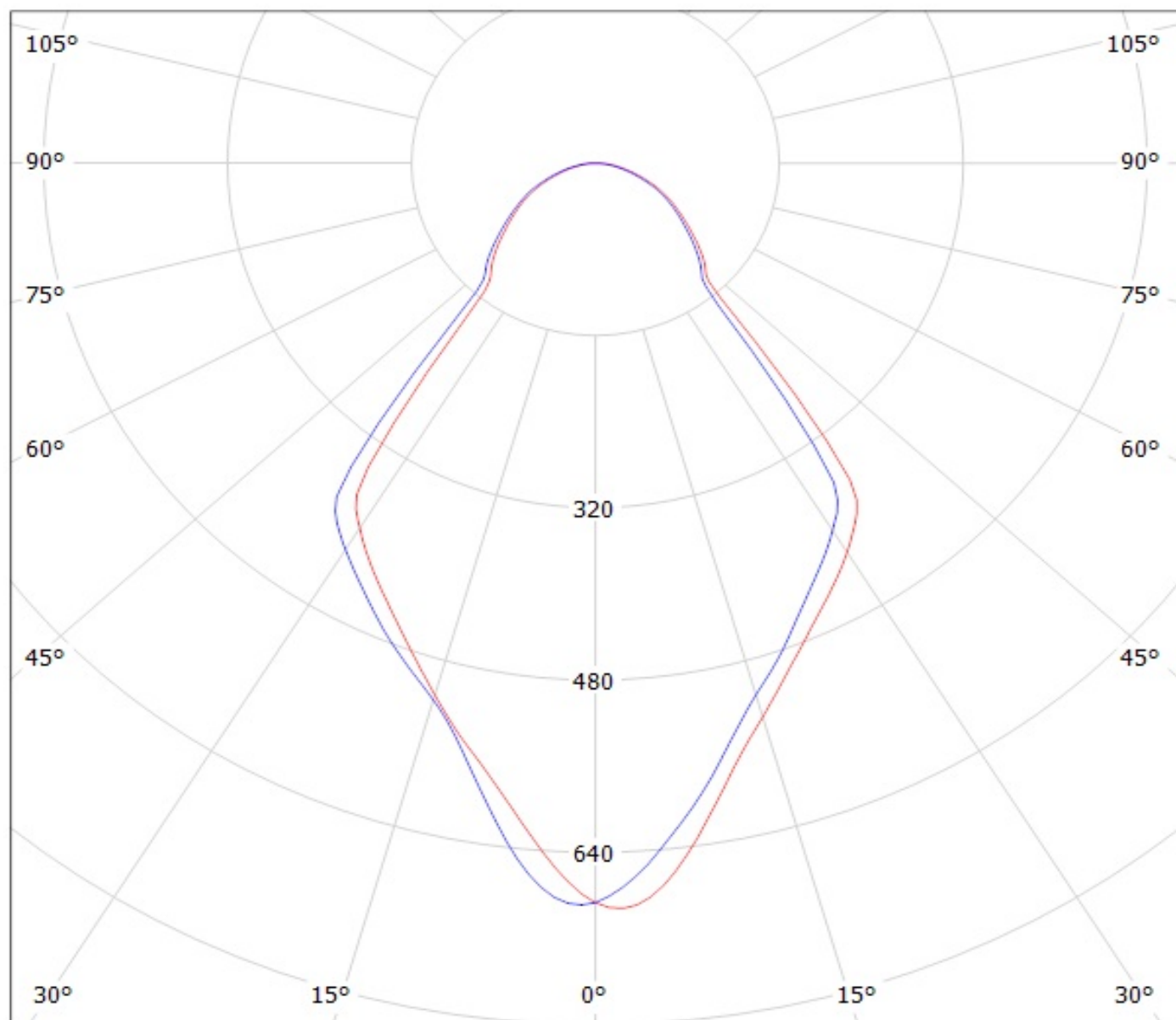

cd/klm

— C0 - C180 — C90 - C270

$\eta = 92\%$

Luminaire: LEDil Oy C13353_LEILA-R-CLIP16_(XM-L2) Efficiency=92%
Lamps: 1 x Cree XM-L2 (XMLBWT-0-7B4-T30-0L-0001) 91lm @ 250mA CCT=3200K P=0.7W I=250mA

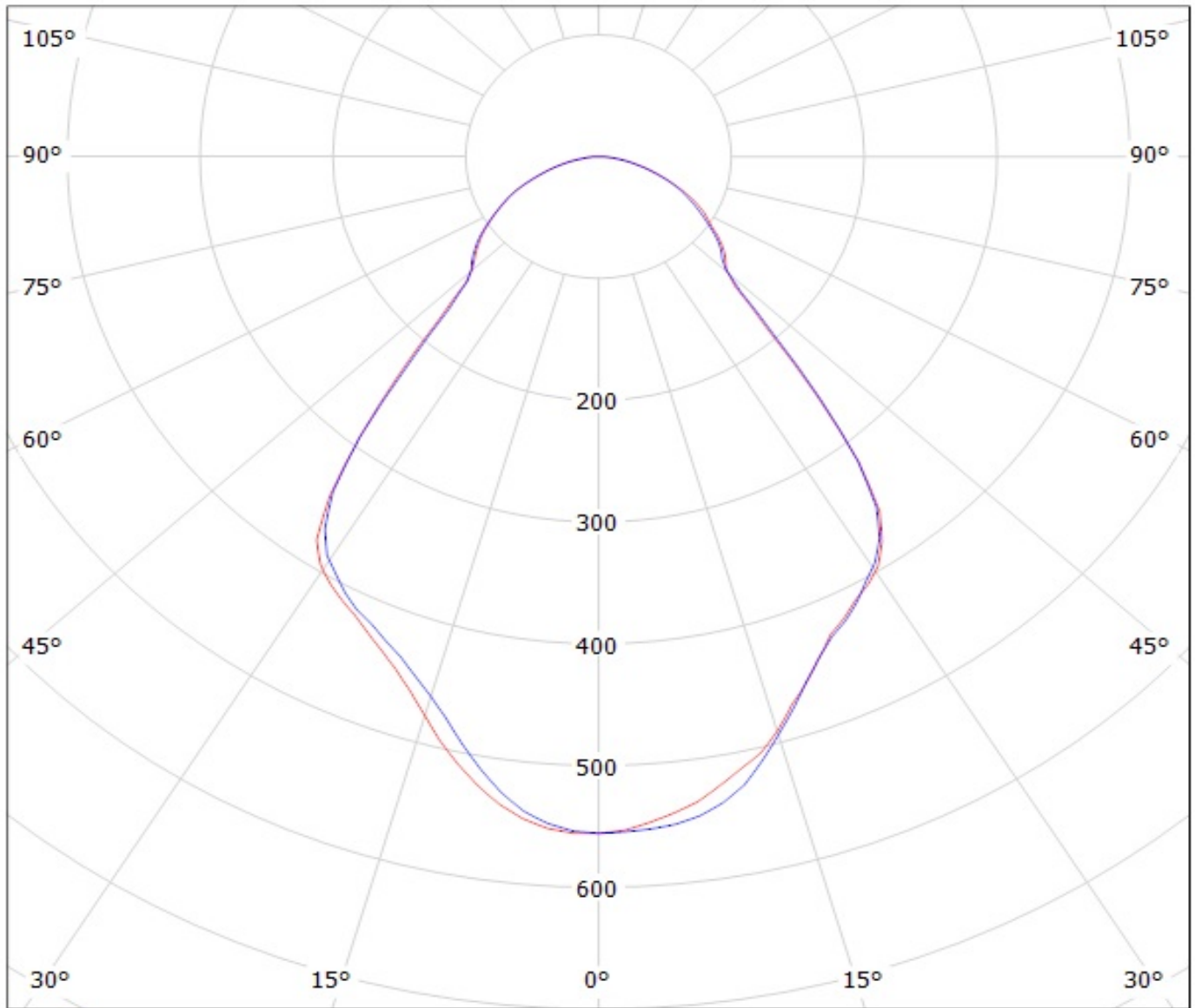

cd/klm
— C0 - C180 — C90 - C270

Luminaire: LEDil Oy C13353_LEILA-R-CLIP16_(XP-G2) Efficiency=92%

Lamps: 1 x CREE XP-G2 (XPGBWT-L1-0000-00FE4) 101lm @ 250mA CCT=6600K P=0.7W I=250mA

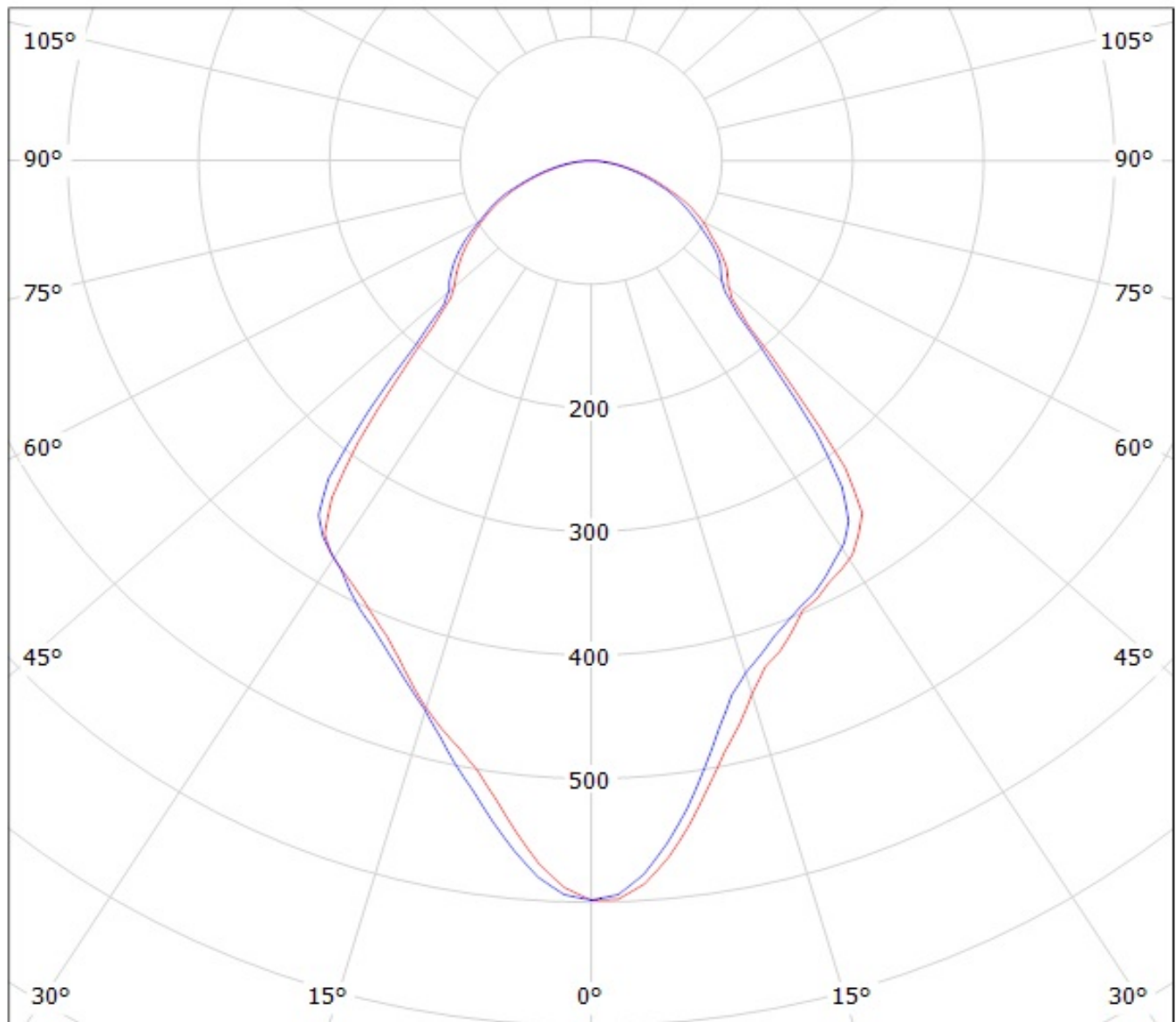

cd/klm

— C0 - C180

— C90 - C270

Ledil C13353_LEILA-R-CLIP16_(XP-L_HI) / LDC (Polar)

Luminaire: Ledil C13353_LEILA-R-CLIP16_(XP-L_HI)

Lamps: 1 x CREE_XP-L_HI_116.971lm@250mA_P=0.75W_I=0.25A

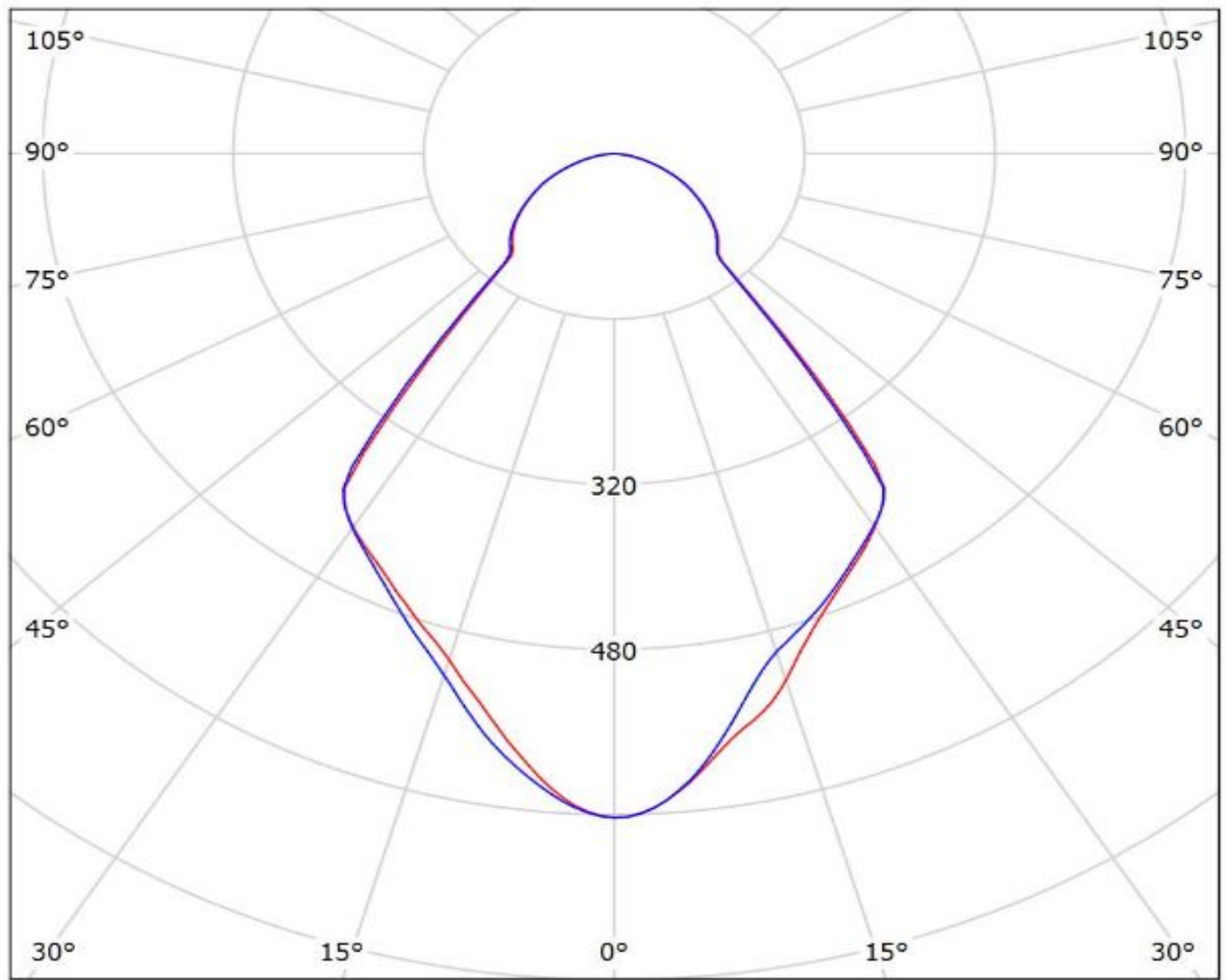

cd/klm

— C0 - C180 — C90 - C270

$\eta = 92\%$

Luminaire: LEDiL Oy C13353_LEILA-R-CLIP16
Lamps: 1 x Luxeon Rebel-ES 91lm @ 250mA

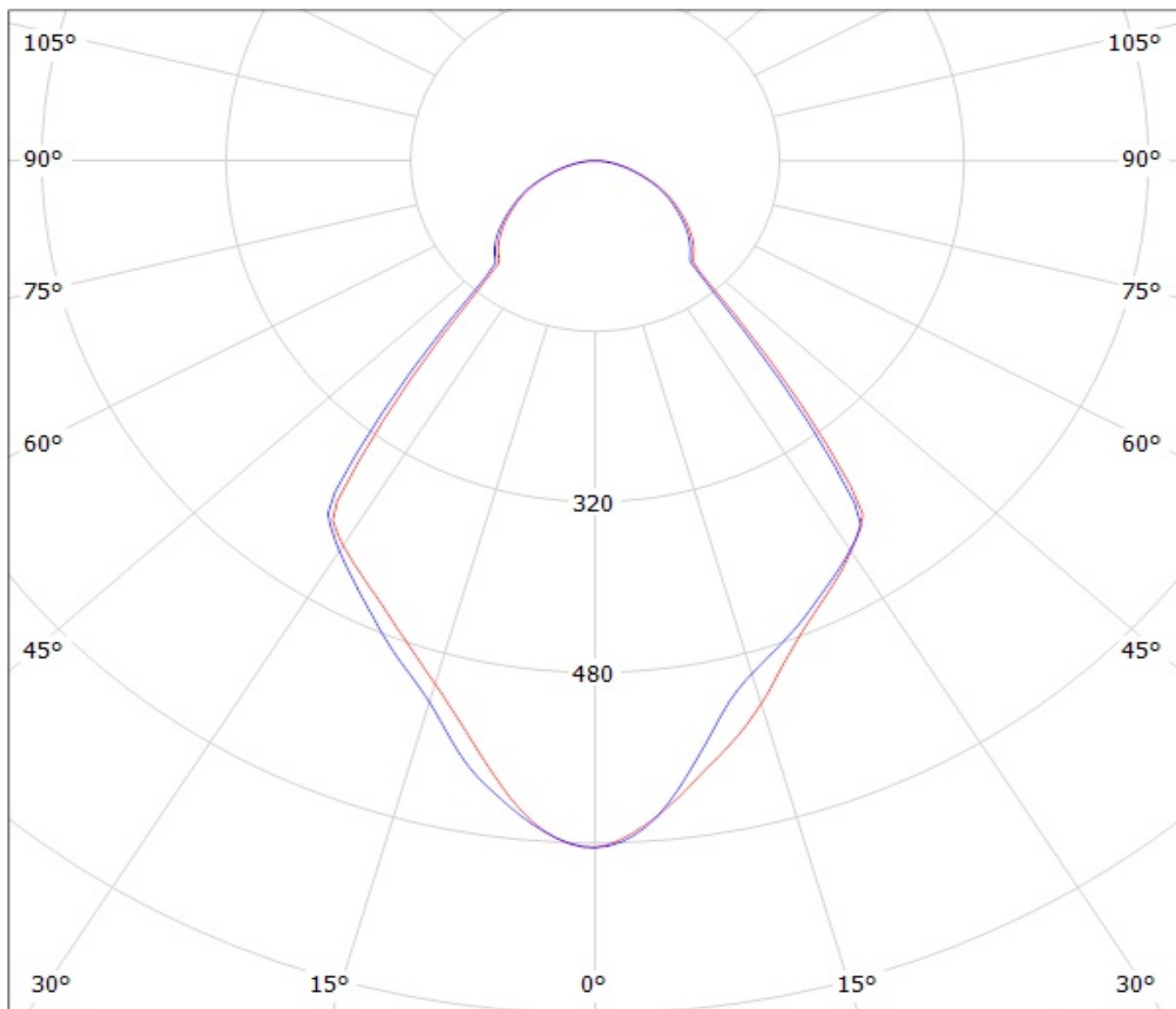

cd/klm

— C0 - C180 — C90 - C270

$\eta = 93\%$

Luminaire: LEDiL Oy C13353_LEILA-R-CLIP16
Lamps: 1 x Luxeon Rebel 80.7lm @ 250mA

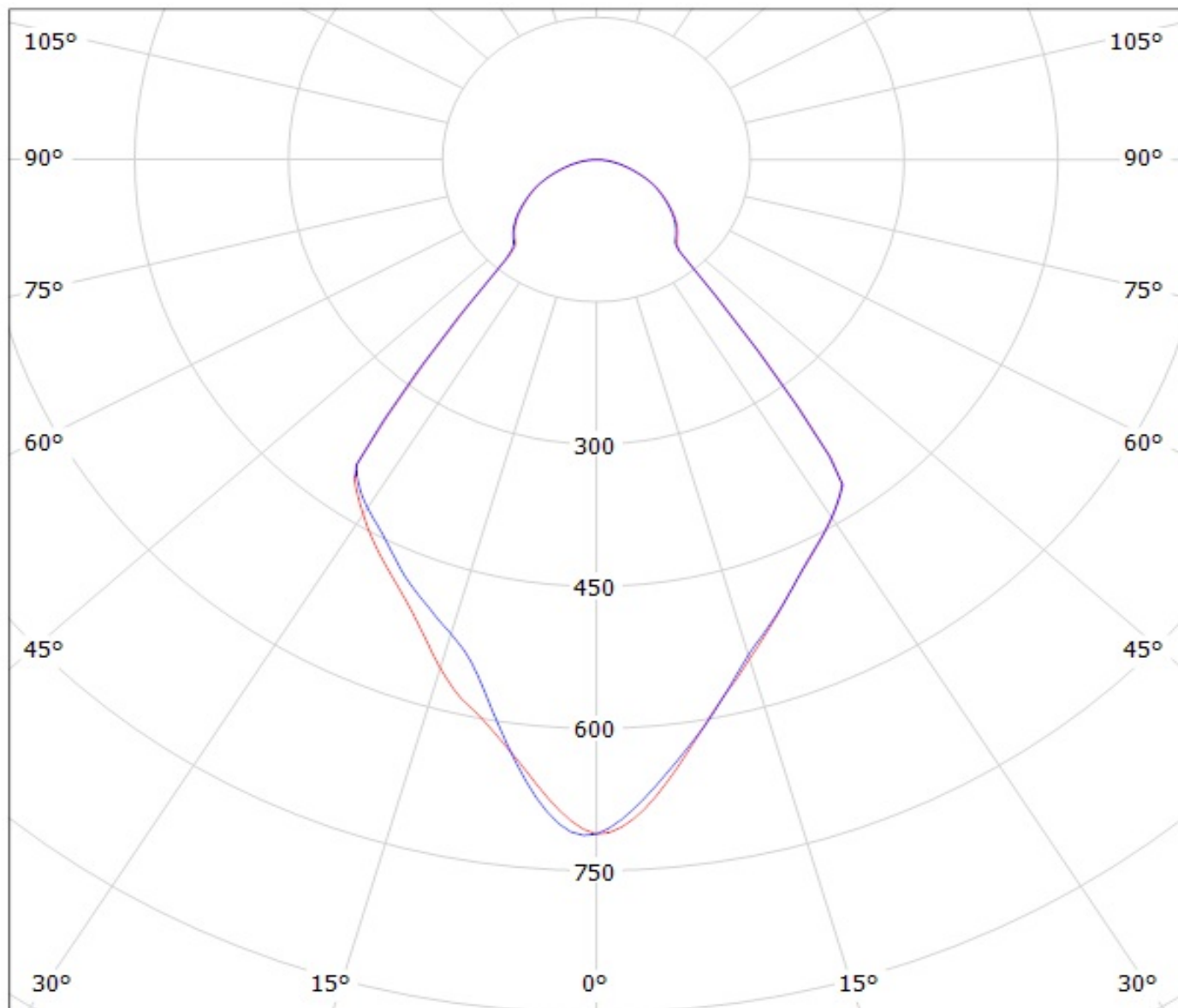

$\eta = 93\%$

— C0 - C180 — C90 - C270

Luminaire: LEDiL Oy C13353_LEILA-R-CLIP16
Lamps: 1 x Luxeon R 85lm @ 250mA

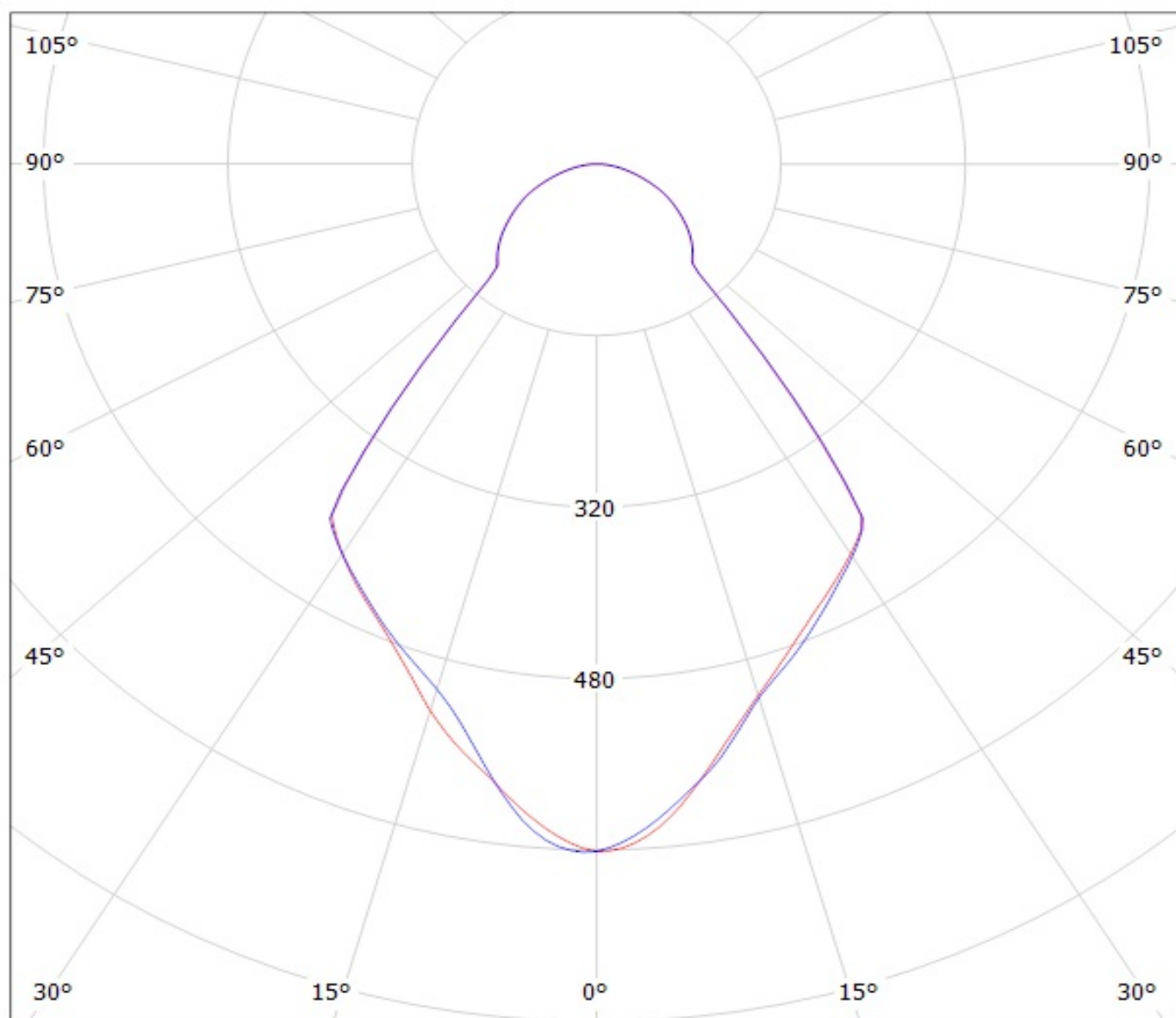

cd/klm

— C0 - C180 — C90 - C270

$\eta = 93\%$

Luminaire: LEDiL Oy C13353_LEILA-R-CLIP16
Lamps: 1 x Luxeon A 65.7lm @ 250mA

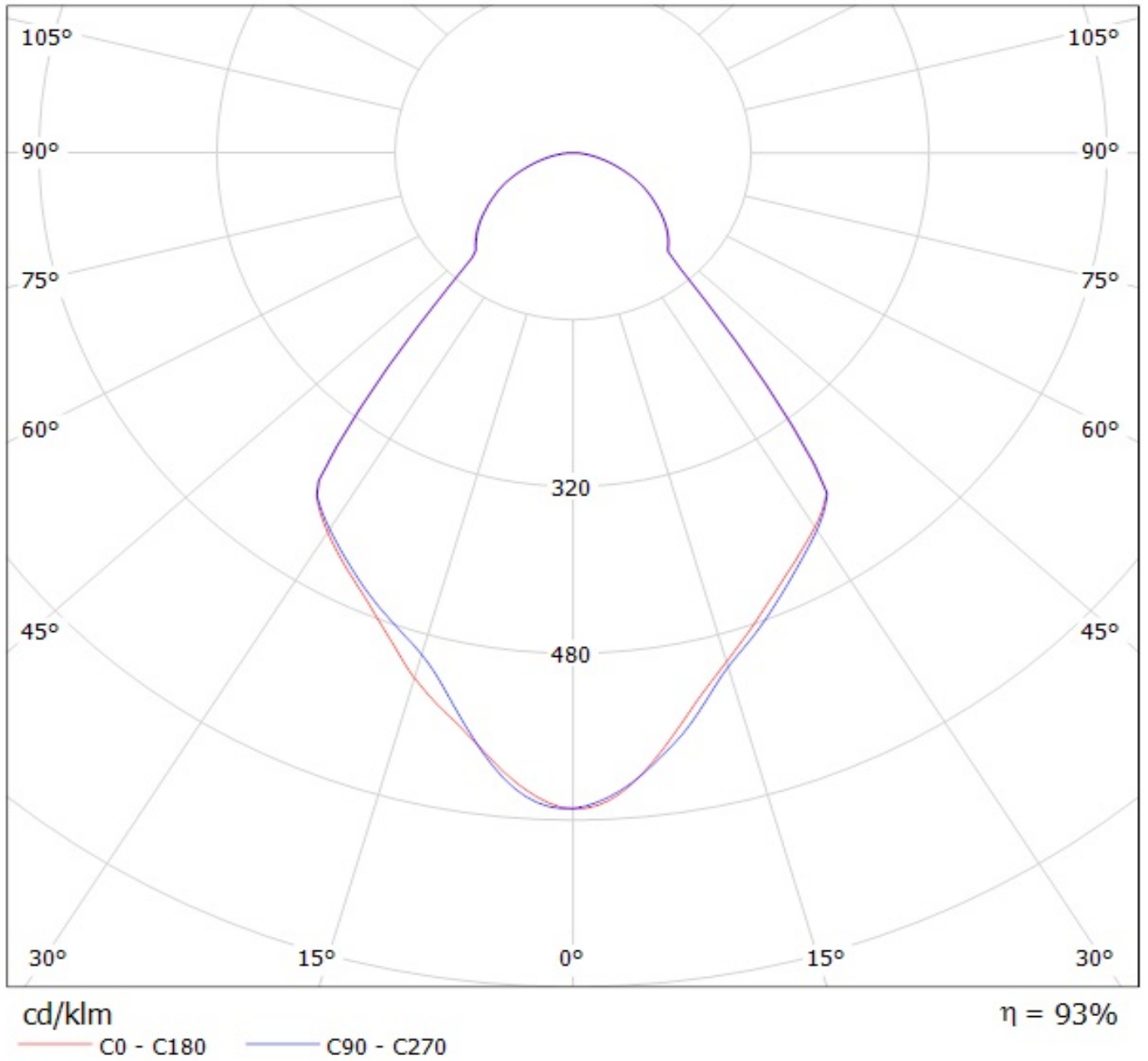

Luminaire: LEDiL Oy C13353_LEILA-R-CLIP16_(LUXEON_Q) Eff: 88%
Lamps: 1 x LUXEON_Q_(LHQ-3080)_76.0112lm@250mA_P=0.753249W_I=249.9mA

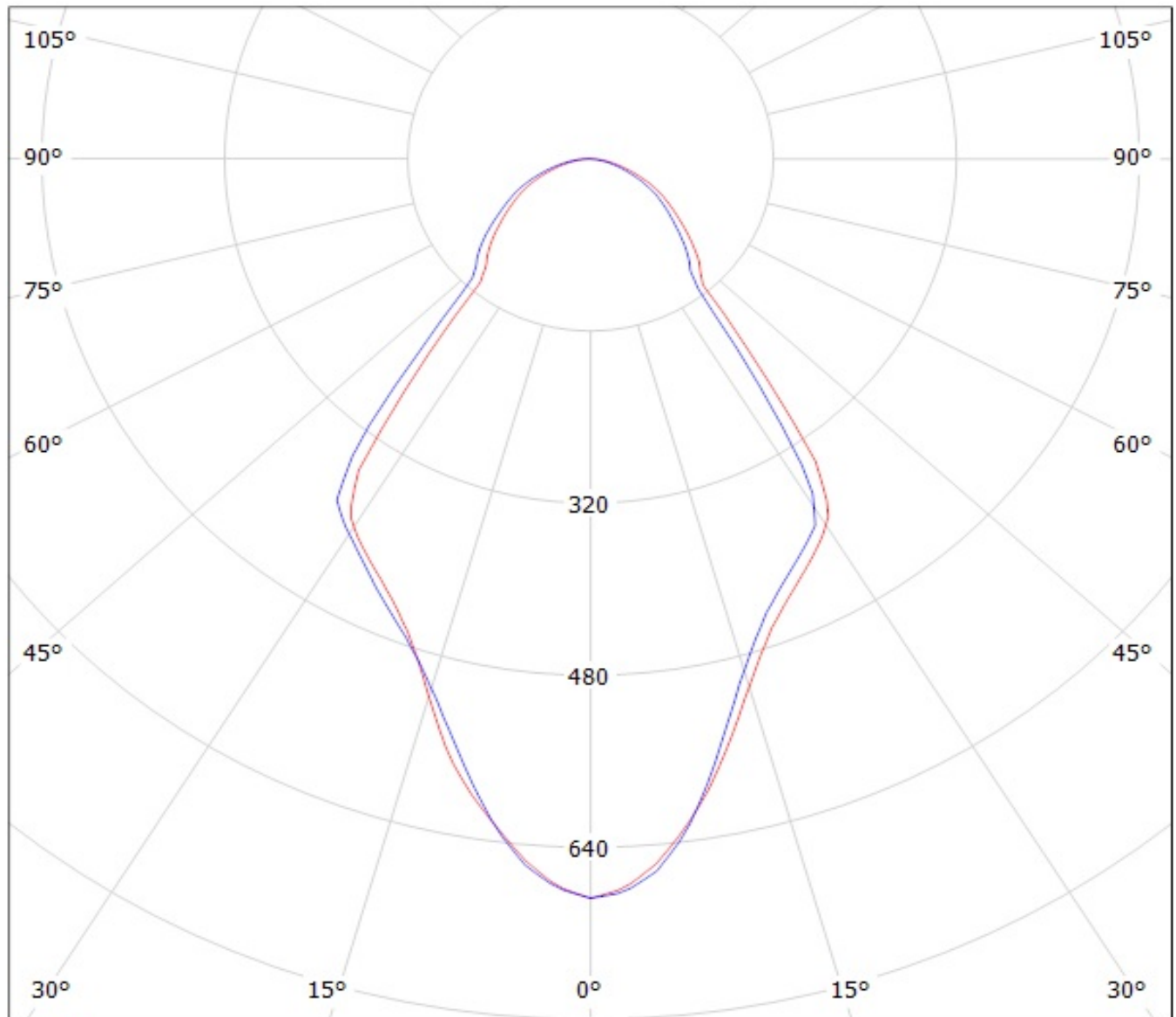

cd/klm

— C0 - C180 — C90 - C270

Luminaire: LEDiL Oy C13353_LEILA-R-CLIP16
Lamps: 1 x Nichia NCS19 88lm 2 250mA

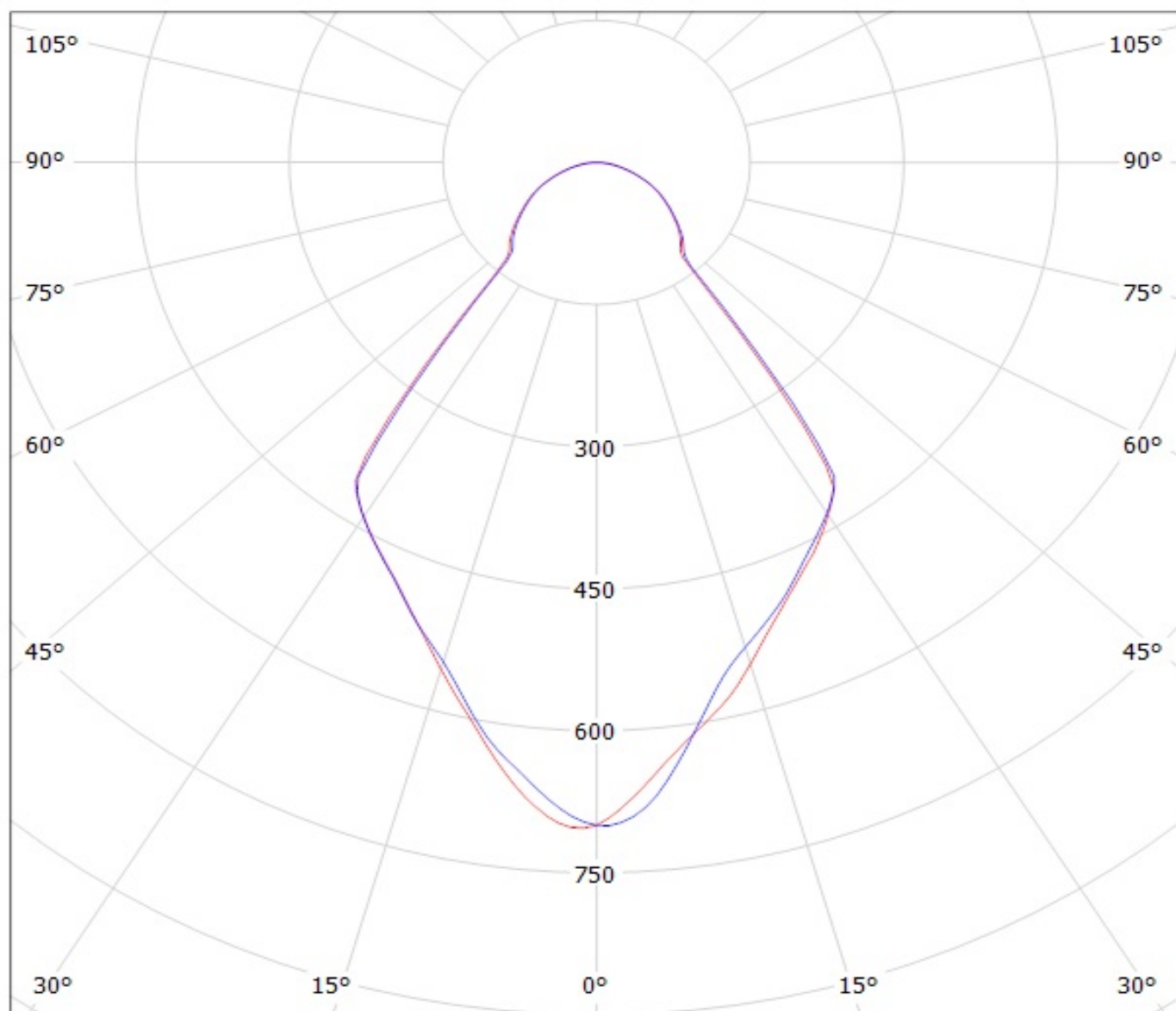

cd/klm

— C0 - C180 — C90 - C270

$\eta = 93\%$

Luminaire: LEDiL Oy C13353_LEILA-R-CLIP16
Lamps: 1 x Nichia NVS 97.6lm @ 250mA

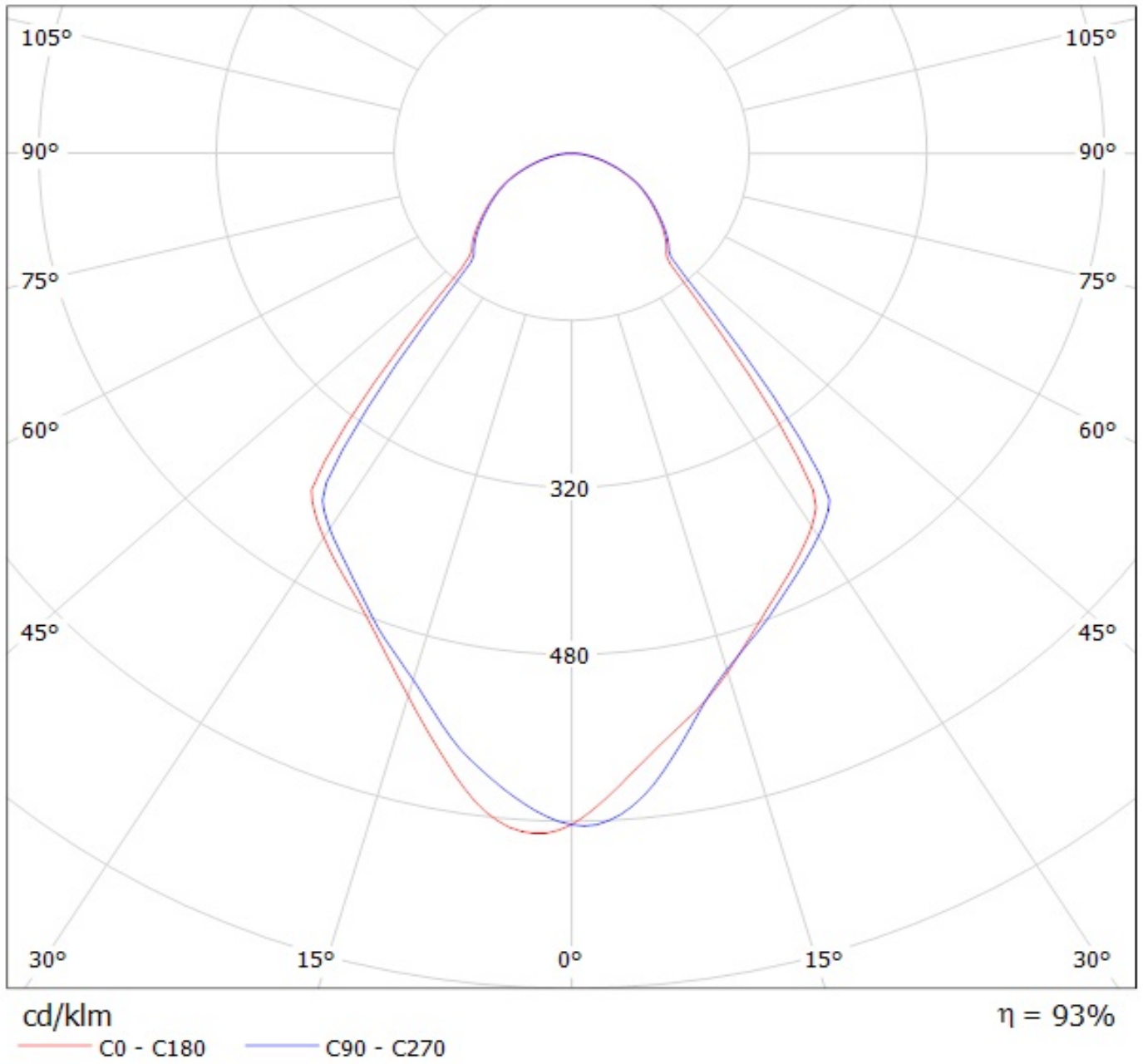

Luminaire: LEDiL Oy C13353_LEILA-R-CLIP16_(NS9x383) Eff. 90,9%
Lamps: 1 x Nichia NS9x383 (105lm@250mA)

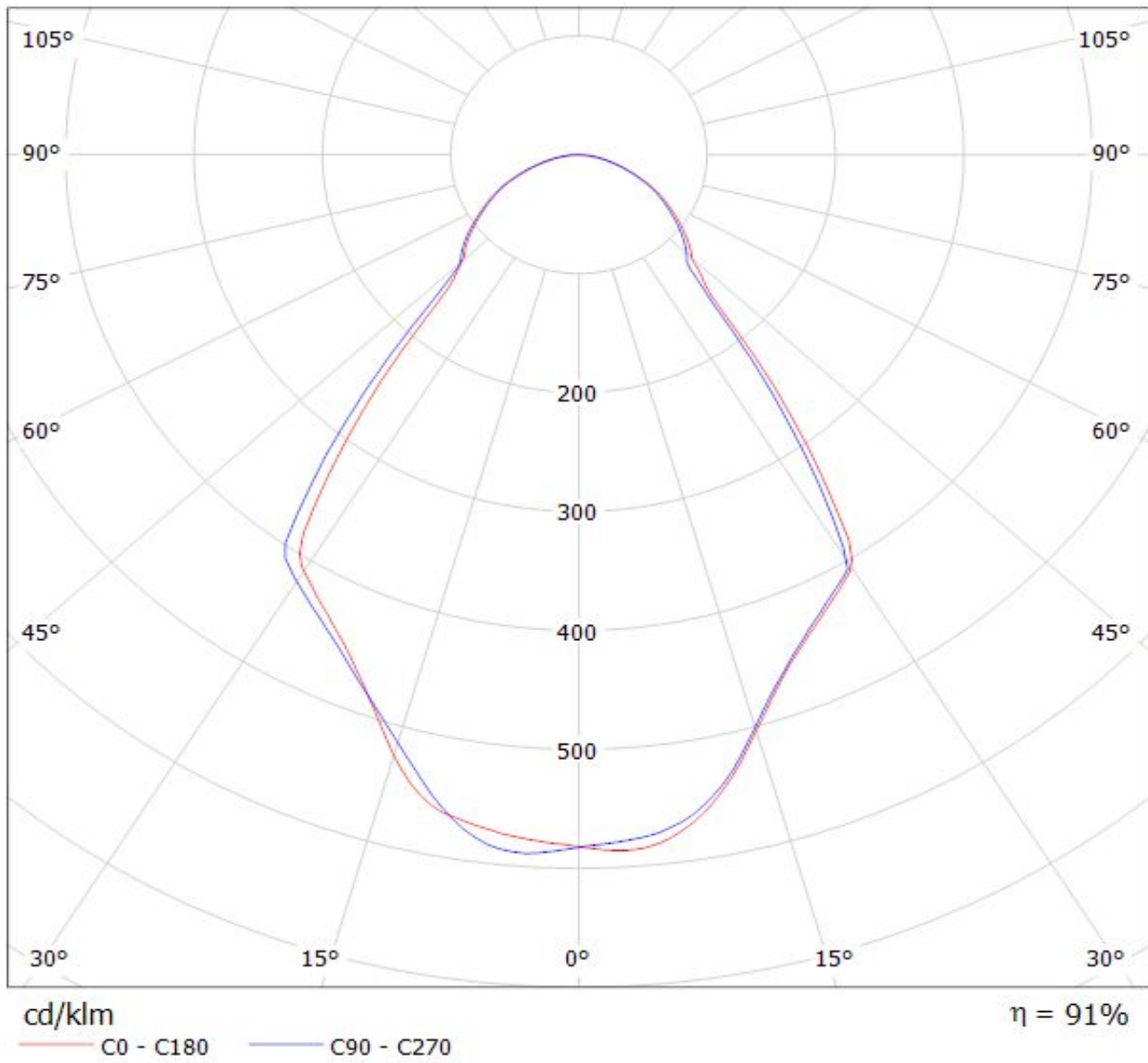

Luminaire: LEDiL Oy C13353_LEILA-R-CLIP16
Lamps: 1 x Osram Square PC 79lm @ 250mA

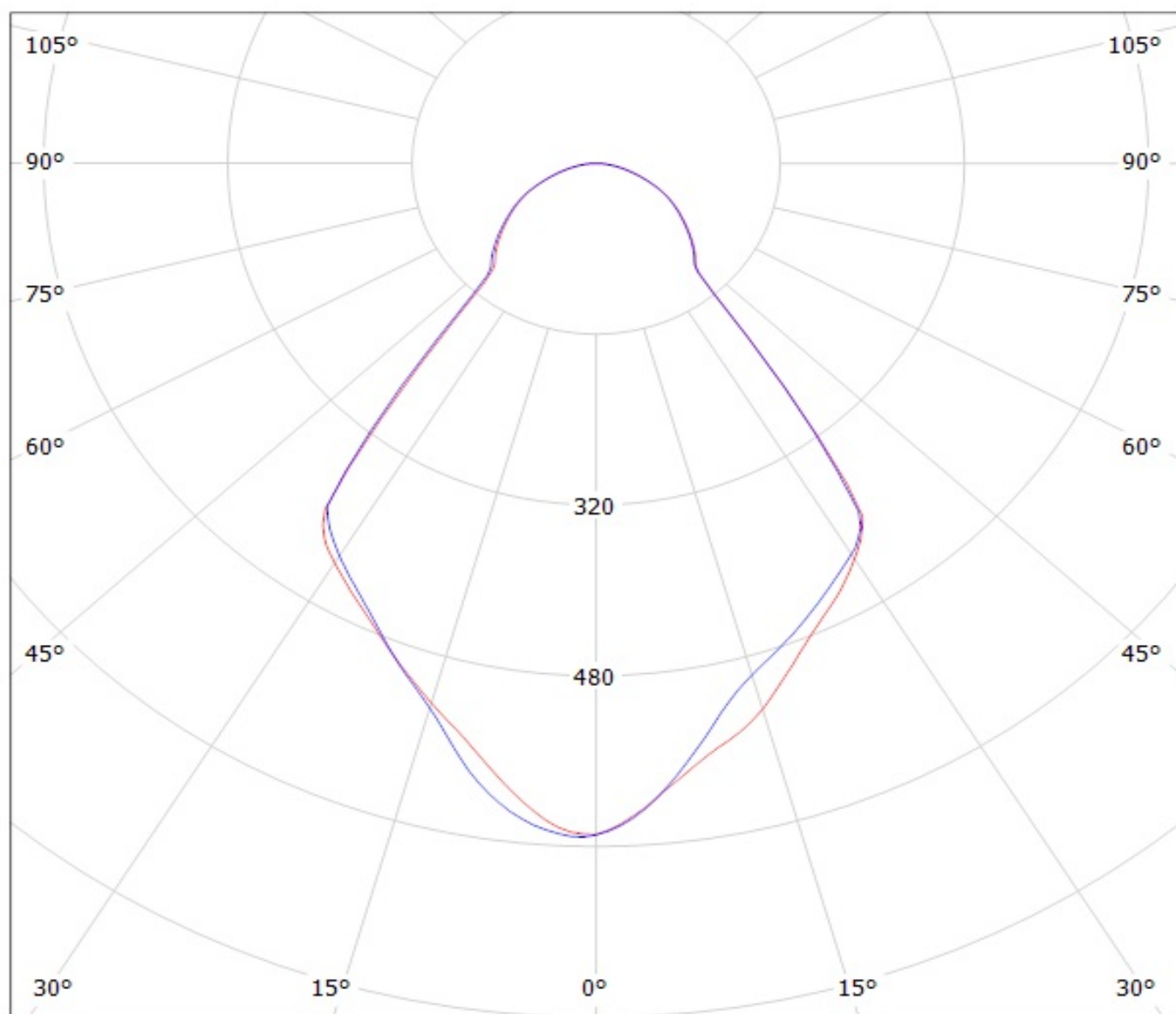

cd/klm

— C0 - C180

— C90 - C270

$\eta = 93\%$

Luminaire: Ledil C13353_LEILA-R-CLIP16_(Z8Y19)

Lamps: 1 x Seoul_Z8Y19_111.337lm@250mA_P=0.7402W_I=0.25

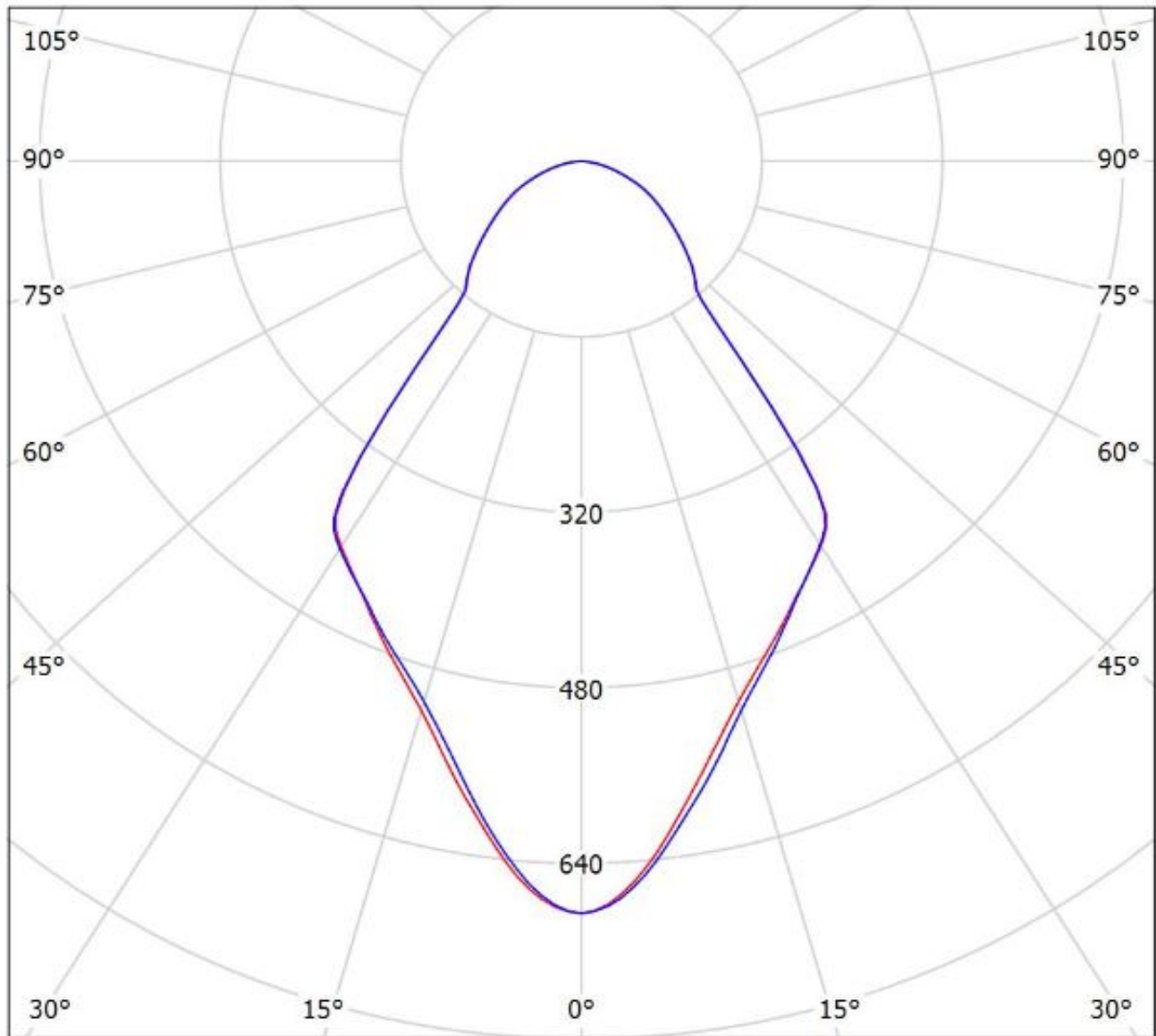

cd/klm

— C0 - C180

— C90 - C270

$\eta = 91\%$

Luminaire: Ledil C13353_LEILA-R-CLIP16_(Z8Y15)

Lamps: 1 x Seoul_Z8Y15_99.8967lm@250mA_P=0.7569W_I=0.25A

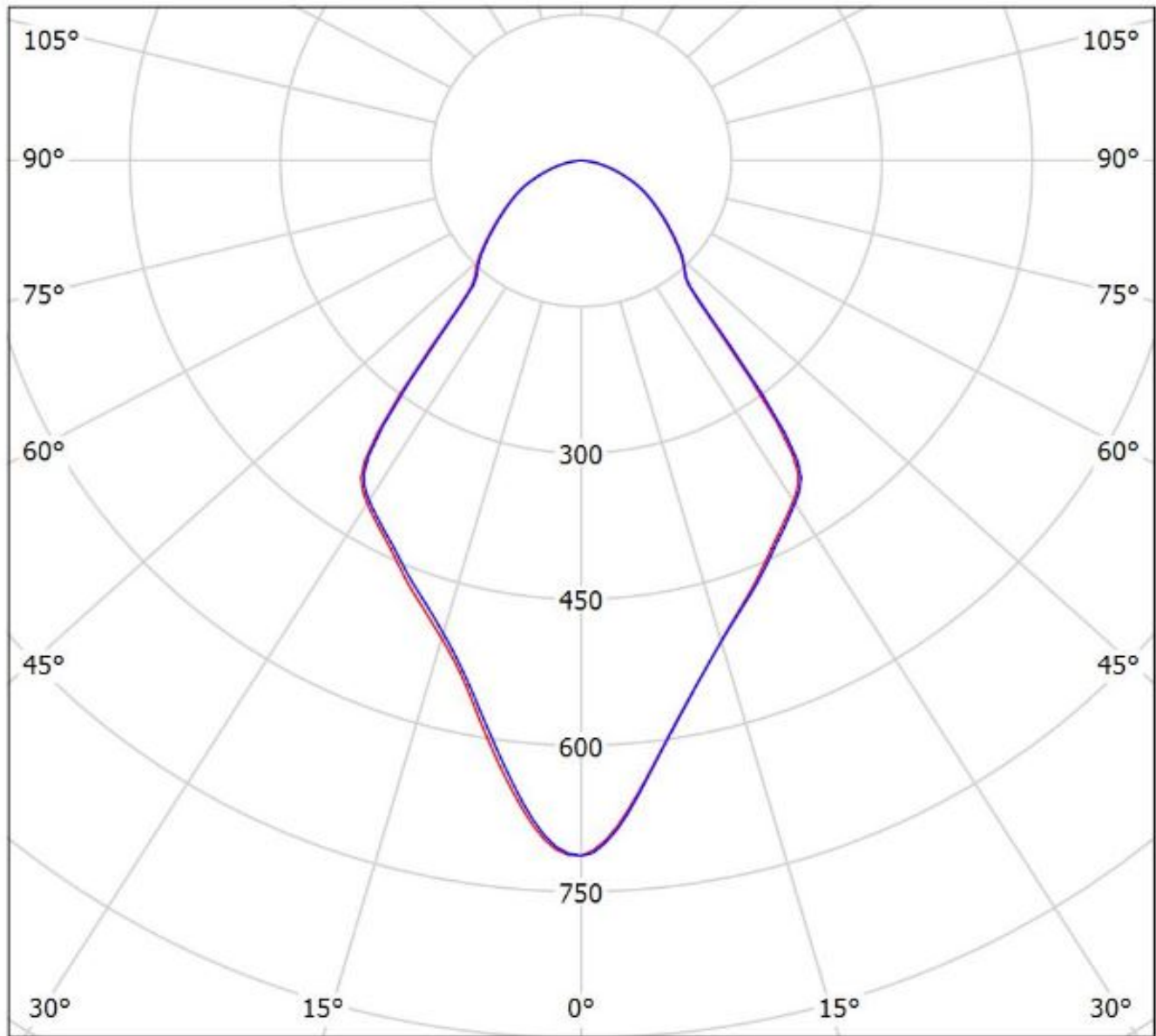

cd/klm

— C0 - C180

— C90 - C270

$\eta = 91\%$

NOTE: The typical divergence will be changed by different color, chip size and chip position tolerance. The typical total divergence is the full angle measured where the luminous intensity is half of the peak value.