

| REVISIONS | | | |
|-----------|-----|---------------------------|---------|
| EC | REV | DESCRIPTION | DATE |
| | A2 | REVISED PER ECO-11-005140 | 25MAR11 |

8. ITEMS PROVIDED TO THIS SPECIFICATION TO BE PERMANENTLY IDENTIFIED PER THE FOLLOWING IDENTIFIER:

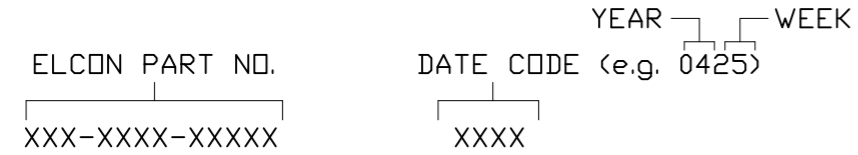

7. RECOMMENDED PRESSING FIXTURE: FIX00058 FOR COMPLIANT APPLICATION IS AVAILABLE. PLEASE CONSULT FACTORY.

6. EXAMPLE PCB CONFIGURATION.

5. THIS CONFIGURATION WITH 2-SEGMENT POWER CONNECTOR IS SHOWN FOR REFERENCE ONLY. COMBINATION OF MULTIPLE NUMBERS OF 2 AND 3 SEGMENT MODULES COULD BE USED PER USER PREFERENCE. OVERALL COMBINATION SHOULD NOT EXCEED 8.0" IN LENGTH.

4. SOCKETS ACCEPT 1.6 [.062] ± 10% THICK PC BOARD.

3. FINISHES:

CONTACTS: SELECTIVE GOLD PER MIL-G-45204, .000030" MIN. THK, OVER NICKEL PER QQ-N-290

TERMINALS: SELECTIVE TIN PER ASTM B-545, OVER NICKEL PER QQ-N-290

2. MATERIALS:

INSULATORS: THERMOPLASTIC, GLASS REINFORCED, COLOR-BLACK UL94V-0 FLAMMABILITY RATED.

POWER CONTACTS: COPPER ALLOY

1. PART NUMBER CHANGES AND OR DESIGN CHANGES AFFECTING ITEM INTERCHANGEABILITY REQUIRE PRIOR ELCON APPROVAL AND AUTHORIZATION BY REVISION TO THIS DRAWING.

NOTES: UNLESS OTHERWISE SPECIFIED;

10. OBSOLETE PARTS: OBSOLETE CIS STREAMLINING PER D.RENAUD/D.SINISI

9. PART NUMBER INFORMATION

| | CONNECTOR | REFERENCE PART NO | ELCON PART NUMBER | TERMINATION TYPE | PC TAIL LENGTH DIM "A" | RECOMMENDED MOUNTING BOARD | MATING BOARD |
|----------------|-----------|----------------------|-------------------|------------------------|----------------------------|----------------------------|------------------|
| 10 OBSOLETE | SOCKET | 6650534-2 | 287-0022-12100 | SOLDER TAIL (SHORT) | 3.56 [.140] 2.54 [.100] | 1.6 [.062] THICK | 1.6 [.062] THICK |
| | SOCKET | 6650534-3 | 287-0022-12300 | SOLDER TAIL (STANDARD) | 5.08 [.200] 4.06 [.160] | 3.2 [.125] OR THINNER | 1.6 [.062] THICK |
| | SOCKET | 6650534-1 | 287-0022-11300 | COMPLIANT TAIL | 5.08 [.200] 4.06 [.160] | 2.3 [.093] OR THICKER | 1.6 [.062] THICK |

| | | | | | | | | |
|---|--------------------------------------|------------------|---------------|-----------------|--|-------------|------|-----------|
| <p>THIRD ANGLE PROJECTION</p> <p>UNLESS OTHERWISE SPECIFIED DIMENSIONS ARE IN METRIC [INCHES]</p> <p>TOLERANCES</p> <p>ANGLES ± .5°</p> <p>DECIMALS</p> <p>.XX ± .25 [.010]</p> <p>.X ± .5 [.020]</p> | <p>← MM OR MM [INCH]</p> <p>INCH</p> | DRAWN | DATE | TE Connectivity | | | | |
| | HA NGUYEN | 06/24/04 | CHECKED | | <p>TITLE</p> <p>SOCKET CONNECTOR, CROWNEDGE</p> <p>PN: 287-0022-12100/287-0022-12300</p> <p>PN: 287-0022-11300</p> | | | |
| | APPROVED | | APPROVED | | | | | |
| | APPROVED | 06/25/04 | D. CHAU | | | DATE | | |
| | | DCA APPROVED | 07/21/04 | M. ALIM | SIZE | DWG NUMBER | REV. | |
| | | ACAD FILE NUMBER | C6650534A.DWG | | B | C = 6650534 | A2 | |
| | | | | | | DWG SCALE | 2=1 | SH 1 OF 5 |

4

3

2

1

REVISIONS

| EC | REV | DESCRIPTION | DATE |
|----|-----|-------------|------|
| | | SEE SHEET 1 | |

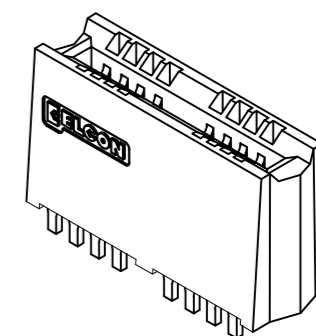
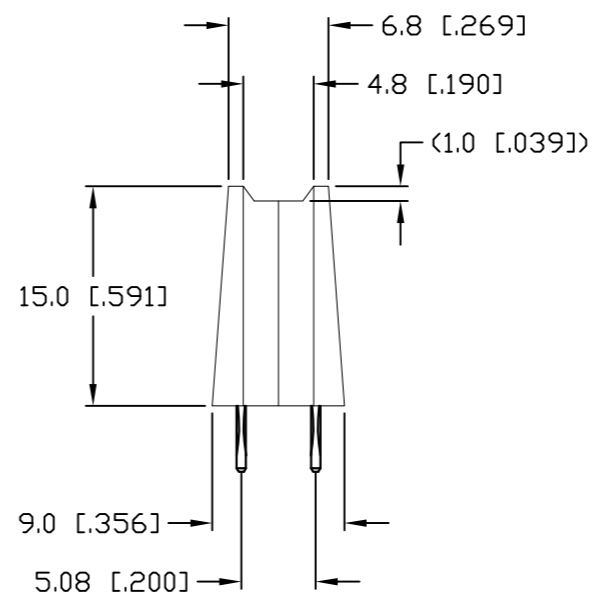
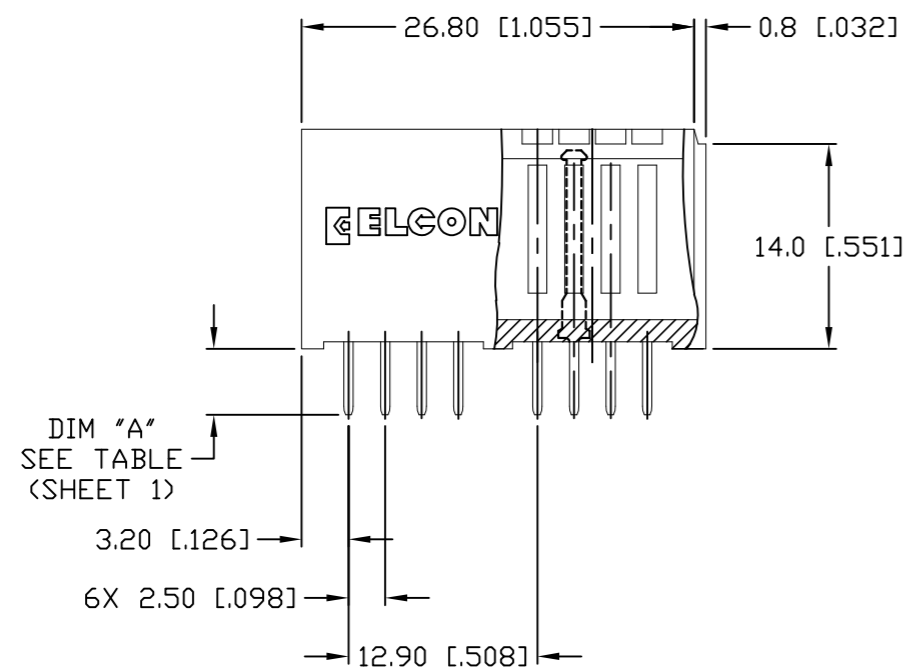
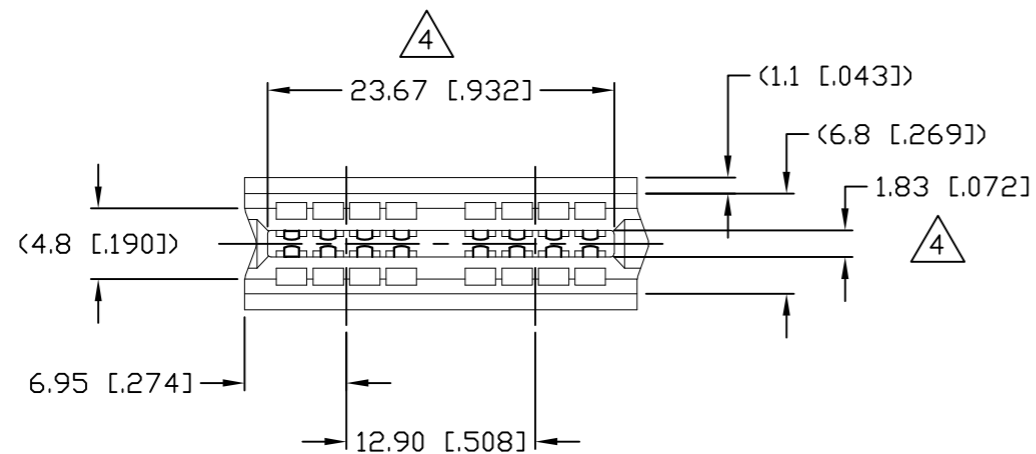

| | | | | | | |
|--|--|--|--|-----------------------------|---|--|
| <p>← MM OR MM [INCH]</p> <p>INCH</p> <p>THIRD ANGLE PROJECTION</p> <p>UNLESS OTHERWISE SPECIFIED DIMENSIONS ARE IN METRIC [INCHES]</p> <p>TOLERANCES</p> <p>ANGLES ± .5°</p> <p>DECIMALS</p> <p>.XX ± .25 [.010]</p> <p>.X ± .5 [.020]</p> | <p>DRAWN</p> <p>HA NGUYEN</p> | <p>DATE</p> <p>06/24/04</p> | <p>STE TE Connectivity</p> | | | |
| | <p>CHECKED</p> | | | | <p>TITLE</p> <p>SOCKET CONNECTOR, CROWNEDGE STRAIGHT, 2 SEG, 16 SIGNAL, SOLDER</p> <p>PN: 287-0022-12100/287-0022-12300</p> | |
| | <p>APPROVED</p> | | <p>APPROVED</p> <p>D. CHAU</p> <p>06/25/04</p> | <p>SIZE</p> <p>B</p> | | |
| | <p>APPROVED</p> <p>M. ALIM</p> <p>07/21/04</p> | <p>ACAD FILE NUMBER</p> <p>C6650534A.DWG</p> | | <p>DWG SCALE</p> <p>2=1</p> | <p>SH</p> <p>2 OF 5</p> | |

4

3

2

1

4

3

2

1

REVISIONS

| EC | REV | DESCRIPTION | DATE |
|-------------|-----|-------------|------|
| SEE SHEET 1 | | | |

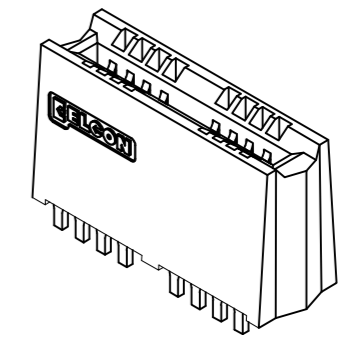
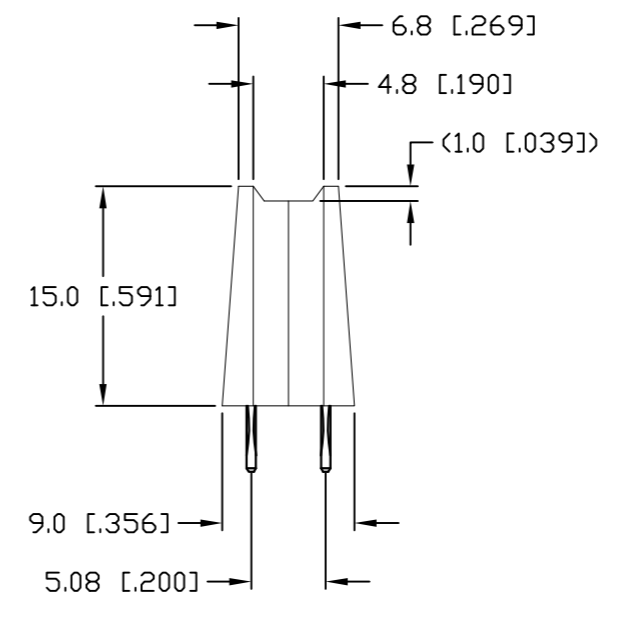
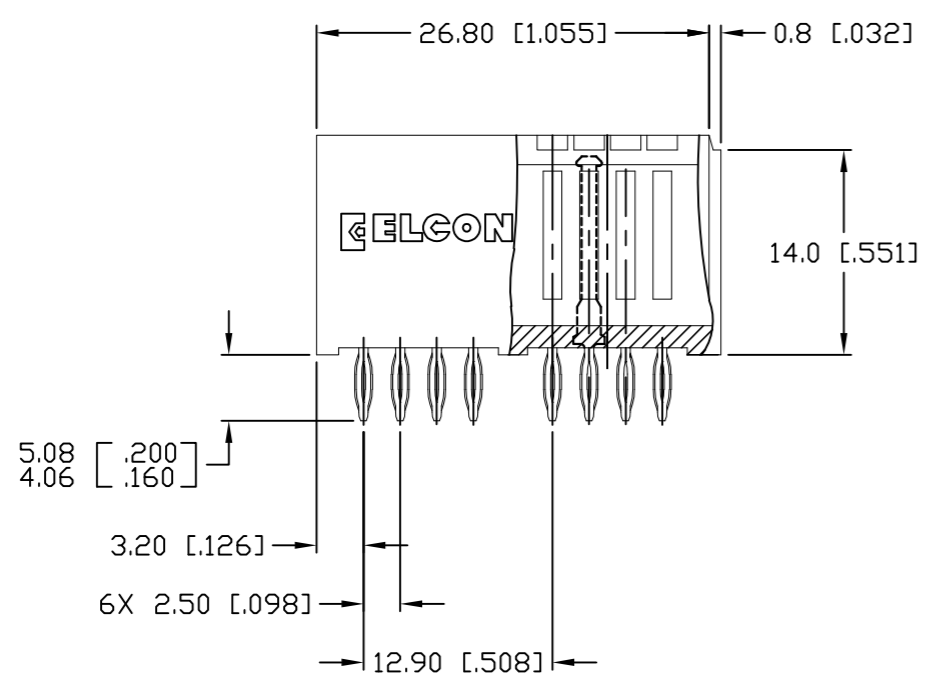
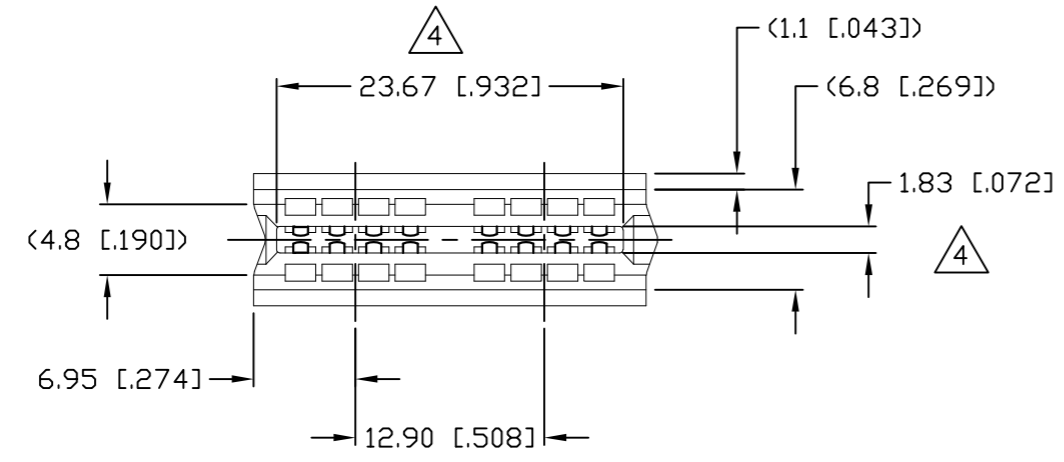

| | | | | | |
|--|------------------------------------|-----------------------------|---------------------------------------|--------------------------------------|--|
| <p>← MM OR MM [INCH]</p> <p>INCH</p> <p>THIRD ANGLE PROJECTION</p> <p>UNLESS OTHERWISE SPECIFIED DIMENSIONS ARE IN METRIC [INCHES]</p> <p>TOLERANCES</p> <p>ANGLES ± .5°</p> <p>DECIMALS</p> <p>.XX ± .25 [.010]</p> <p>.X ± .5 [.020]</p> | <p>DRAWN</p> <p>HA NGUYEN</p> | <p>DATE</p> <p>06/24/04</p> | <p>STE TE Connectivity</p> | | |
| | <p>CHECKED</p> | | | | <p>TITLE</p> <p>SOCKET CONNECTOR, CROWNEDGE STRAIGHT, 2 SEG, 16 SIGNAL, COMPLIANT PN: 287-0022-11300</p> |
| | <p>APPROVED</p> | | | | |
| | <p>APPROVED</p> <p>D. CHAU</p> | <p>06/25/04</p> | <p>SIZE</p> <p>B</p> | <p>DWG NUMBER</p> <p>C = 6650534</p> | |
| | <p>DCA APPROVED</p> <p>M. ALIM</p> | <p>07/21/04</p> | <p>ACAD FILE NUMBER C6650534A.DWG</p> | | <p>DWG SCALE 2=1</p> |

4

3

2

1

| REVISIONS | | | |
|-------------|-----|-------------|------|
| EC | REV | DESCRIPTION | DATE |
| SEE SHEET 1 | | | |

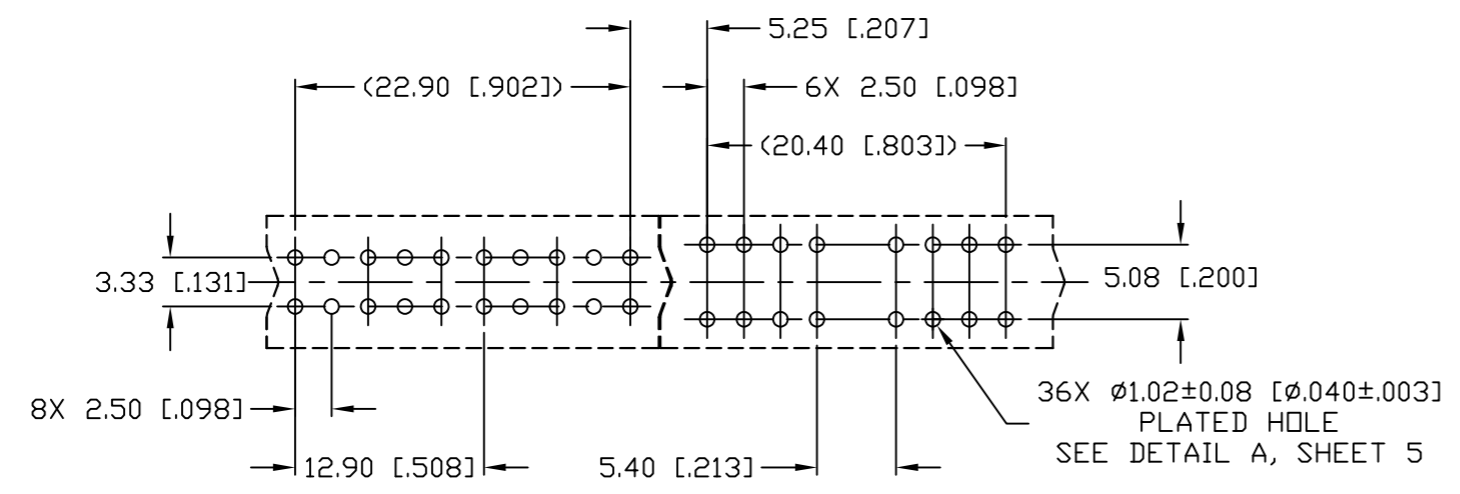
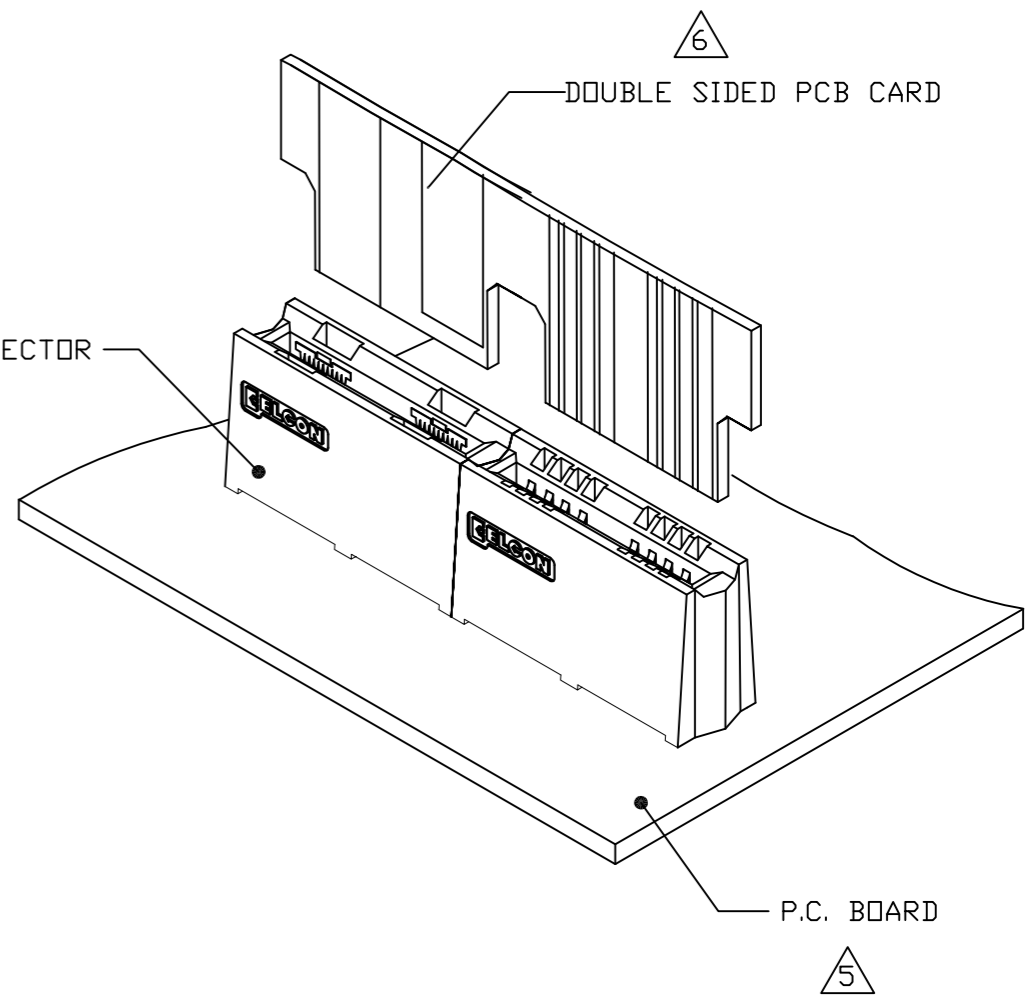
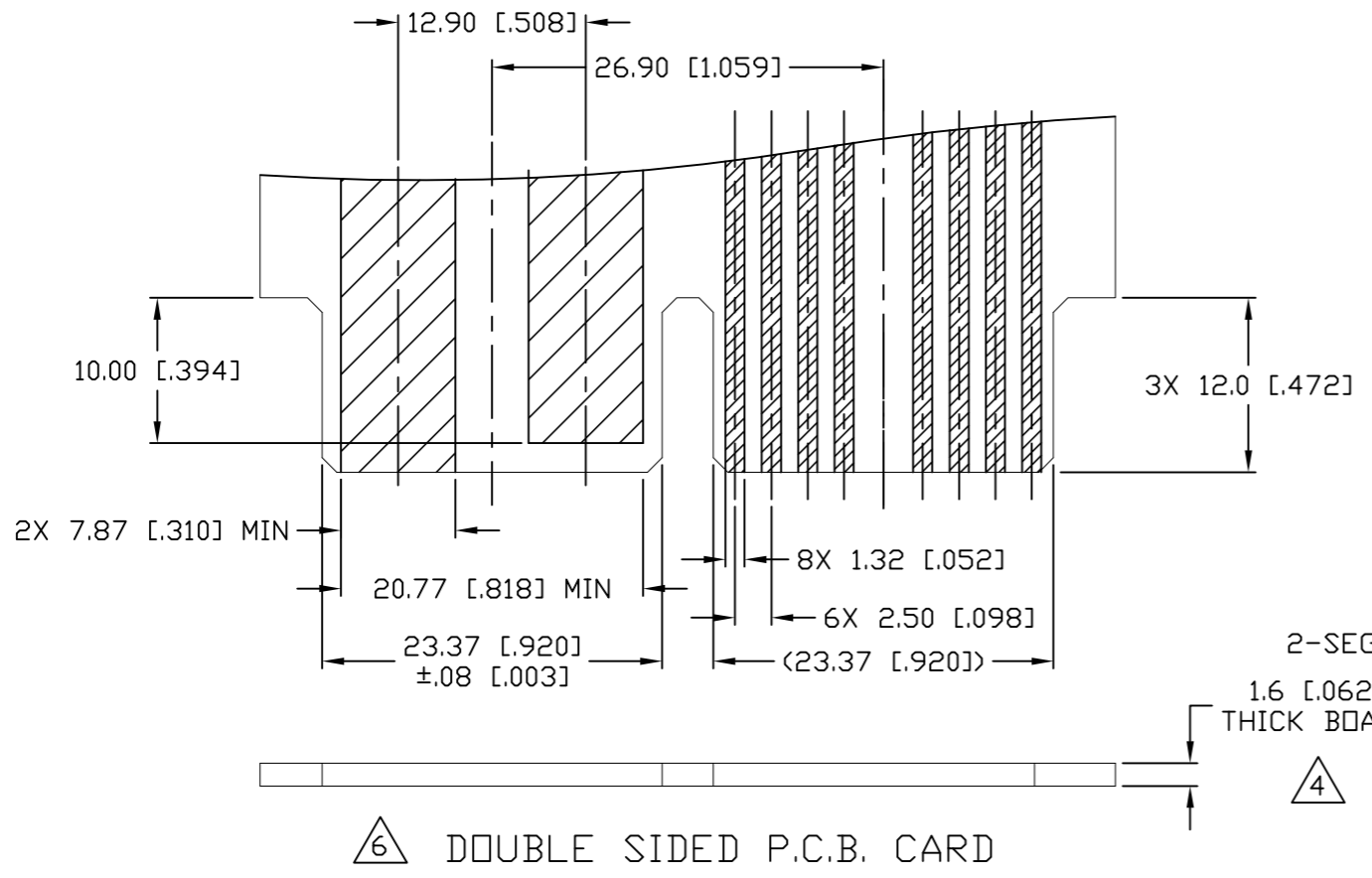

5 RECOMMENDED P.C. BOARD LAYOUT

← MM OR MM [INCH]
 INCH

 THIRD ANGLE PROJECTION
 UNLESS OTHERWISE SPECIFIED DIMENSIONS ARE IN METRIC [INCHES]
 TOLERANCES
 ANGLES ± .5'
 DECIMALS
 .XX ± .25 [.010]
 .X ± .5 [.020]

| | | | |
|------------------|---------------|------|----------|
| DRAWN | HA NGUYEN | DATE | 06/24/04 |
| CHECKED | | | |
| APPROVED | | | |
| APPROVED | D. CHAU | DATE | 06/25/04 |
| DCA APPROVED | M. ALIM | DATE | 07/21/04 |
| ACAD FILE NUMBER | C6650534A.DWG | | |

TE Connectivity
 TITLE
 USER INFORMATION
 RECOMMENDED PC BOARD LAYOUT
 CROWNEDGE
 SIZE DWG NUMBER REV.
 B C = 6650534 A2
 DWG SCALE 2=1 SH 4 OF 5

4

3

2

1

REVISIONS

| EC | REV | DESCRIPTION | DATE |
|----|-----|-------------|------|
| | | SEE SHEET 1 | |

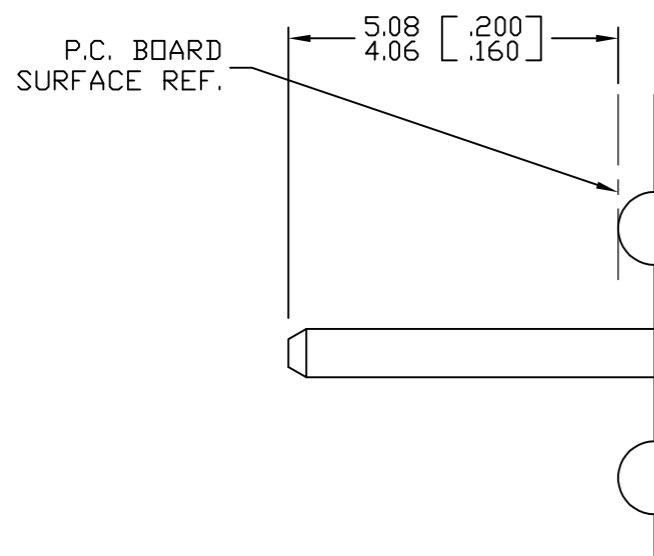

SOLDER PIN DETAIL
SCALE: 10 : 1

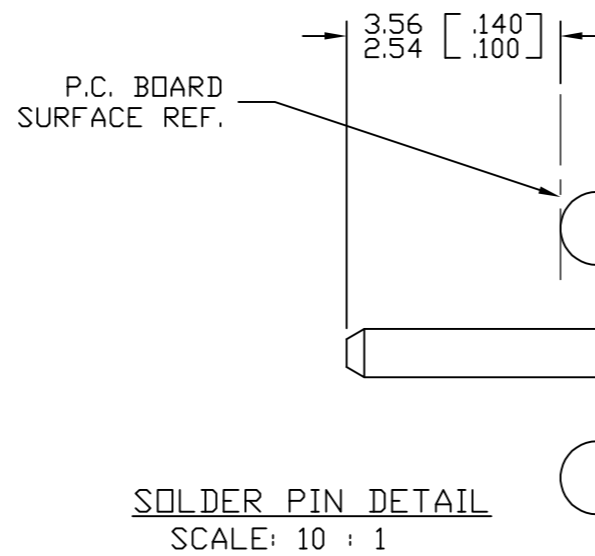

SOLDER PIN DETAIL
SCALE: 10 : 1

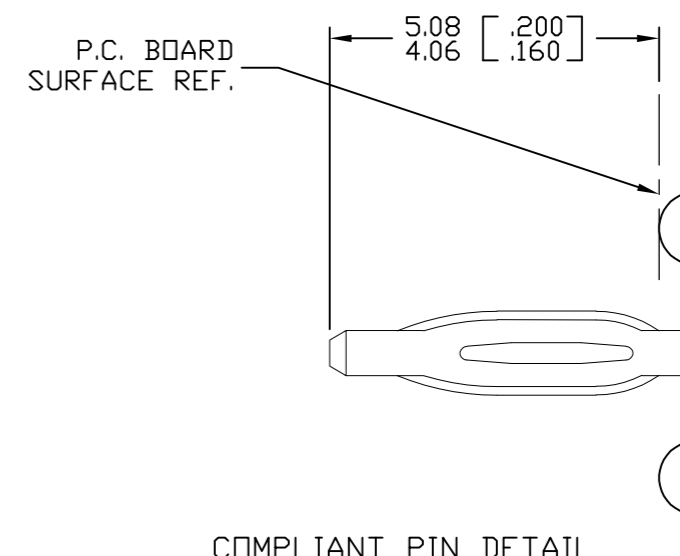

COMPLIANT PIN DETAIL
SCALE: 10 : 1

INSERTION/EXTRACTION FORCES
 MAXIMUM PUSH IN: 133.3N PER PIN
 [30 LBS]
 MINIMUM PUSH OUT: 44.4N PER PIN
 [10 LBS]

RECOMMENDED PRINTED CIRCUIT HOLE
 SOLDER OR COMPLIANT PRESS FIT
 FINISHED HOLE: $\phi 1.02$ [.040] ± 0.08 [.003]
 DRILLED HOLE: $\phi 1.15$ [.0453] ± 0.013 [.0005]
 COPPER PLATE: .025 [.0010] MINIMUM (PER SURFACE)
 TIN PLATE: .008 [.0003] MINIMUM (PER SURFACE)

DETAIL A

| | | | |
|---|-----------------------------------|------------------|---|
| $\frac{MM}{INCH}$ OR MM [INCH] THIRD ANGLE PROJECTION UNLESS OTHERWISE SPECIFIED DIMENSIONS ARE IN METRIC [INCHES] TOLERANCES ANGLES $\pm .5^\circ$ DECIMALS .XX $\pm .25$ [.010] .X $\pm .5$ [.020] | DRAWN HA NGUYEN | DATE 06/24/04 | TE Connectivity TITLE USER INFORMATION SOLDER & COMPLIANT TERMINATION CROWNEDGE |
| | CHECKED | | |
| | APPROVED | | |
| | APPROVED D. CHAU | 06/25/04 | SIZE B |
| | DCA APPROVED M. ALIM | 07/21/04 | DWG NUMBER C = 6650534 |
| | ACAD FILE NUMBER C6650534A.DWG | | REV. A2 |
| | | | DWG SCALE 2=1 SH 5 OF 5 |