

LOC		DIST		REVISIONS			
CM	00	REV	DATE	BY	CHK	APPV	
A		REVISED PER ECO-12-007807	06AUG12	KH	SM		

- 1 UNIT ACCEPTS 1.14 [.045] SQUARE OR ROUND POST.
- 2 UNIT ACCEPTS STANDARD SL-156 CONTACTS.
- 3 UNIT ACCEPTS KEYING PLUG 640254-1 AND KEYING PIN 640255-1.
- 4 CIRCUIT I.D. NUMBER(S) TO BE LOCATED SEQUENTIALLY AS SHOWN OR ONLY NO. 1 CIRCUIT PLACED ON TOP OF HOUSING.
- 5 DIMENSIONS IN BRACKETS ARE IN INCHES.

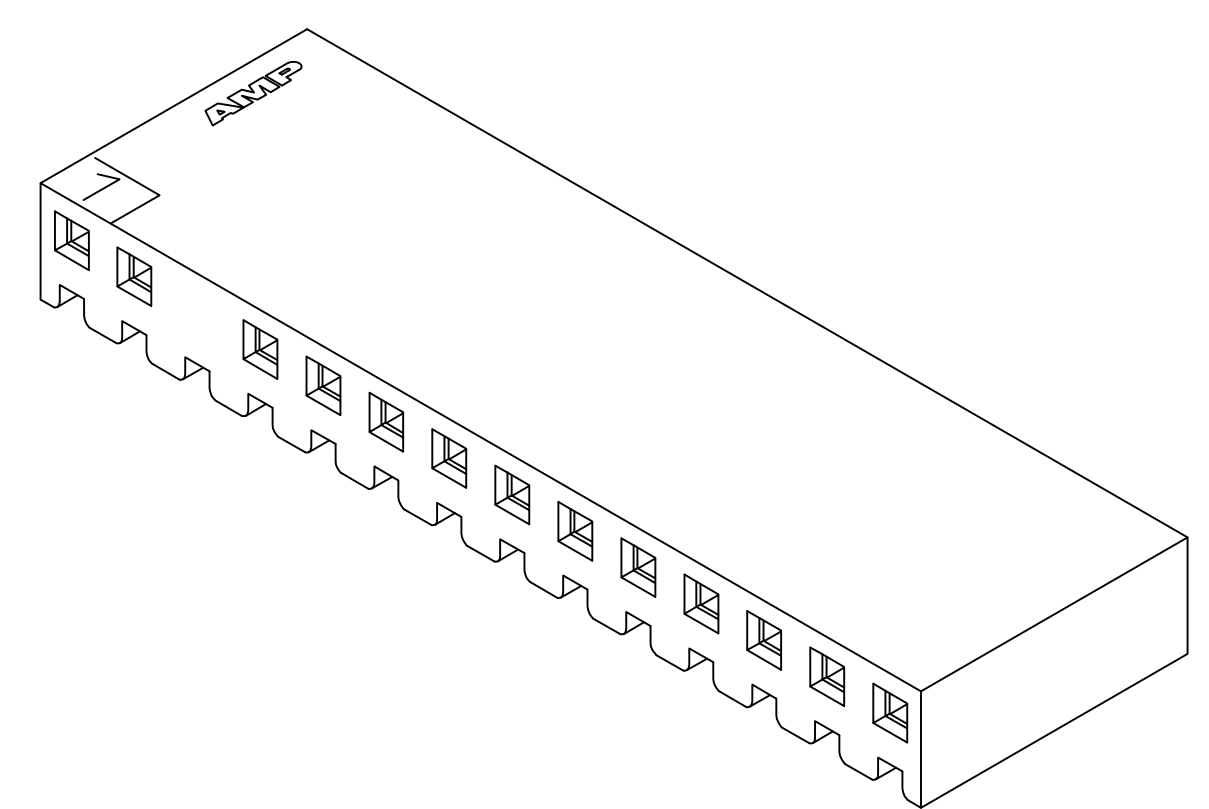
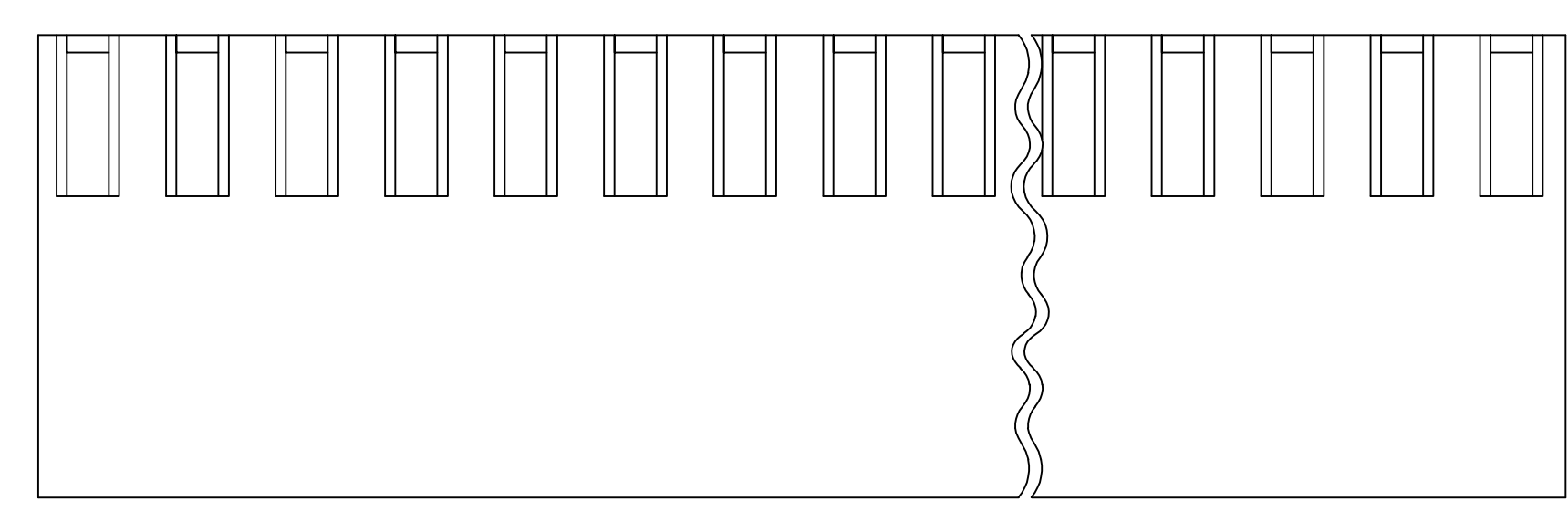
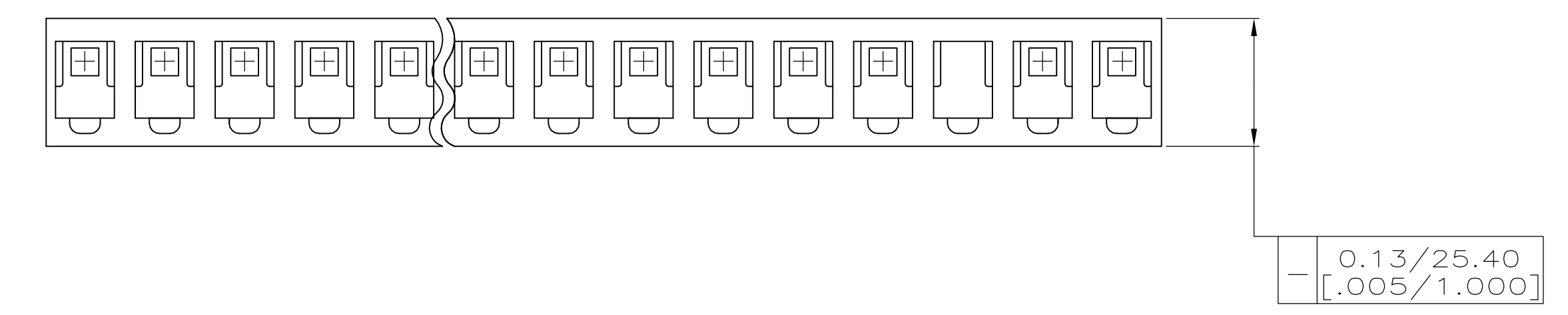
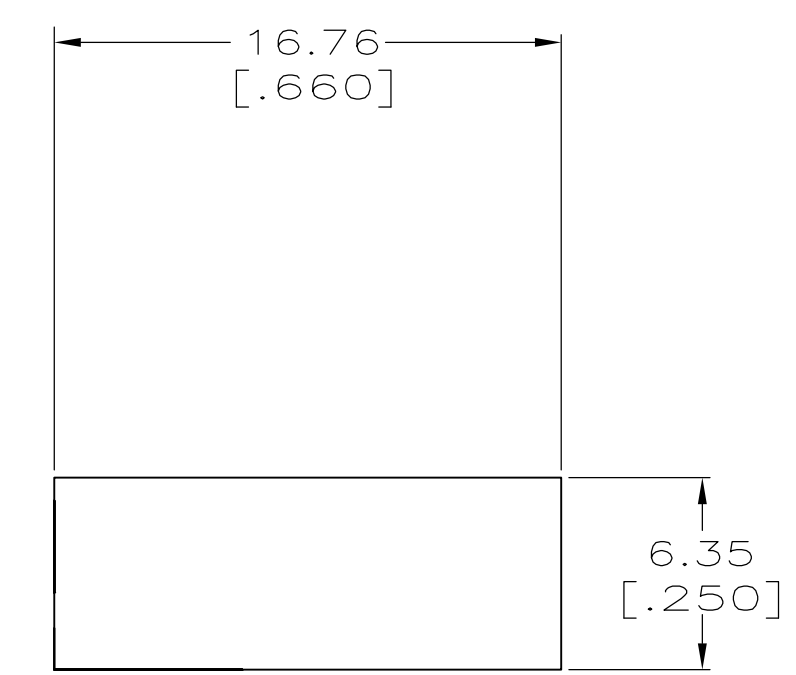
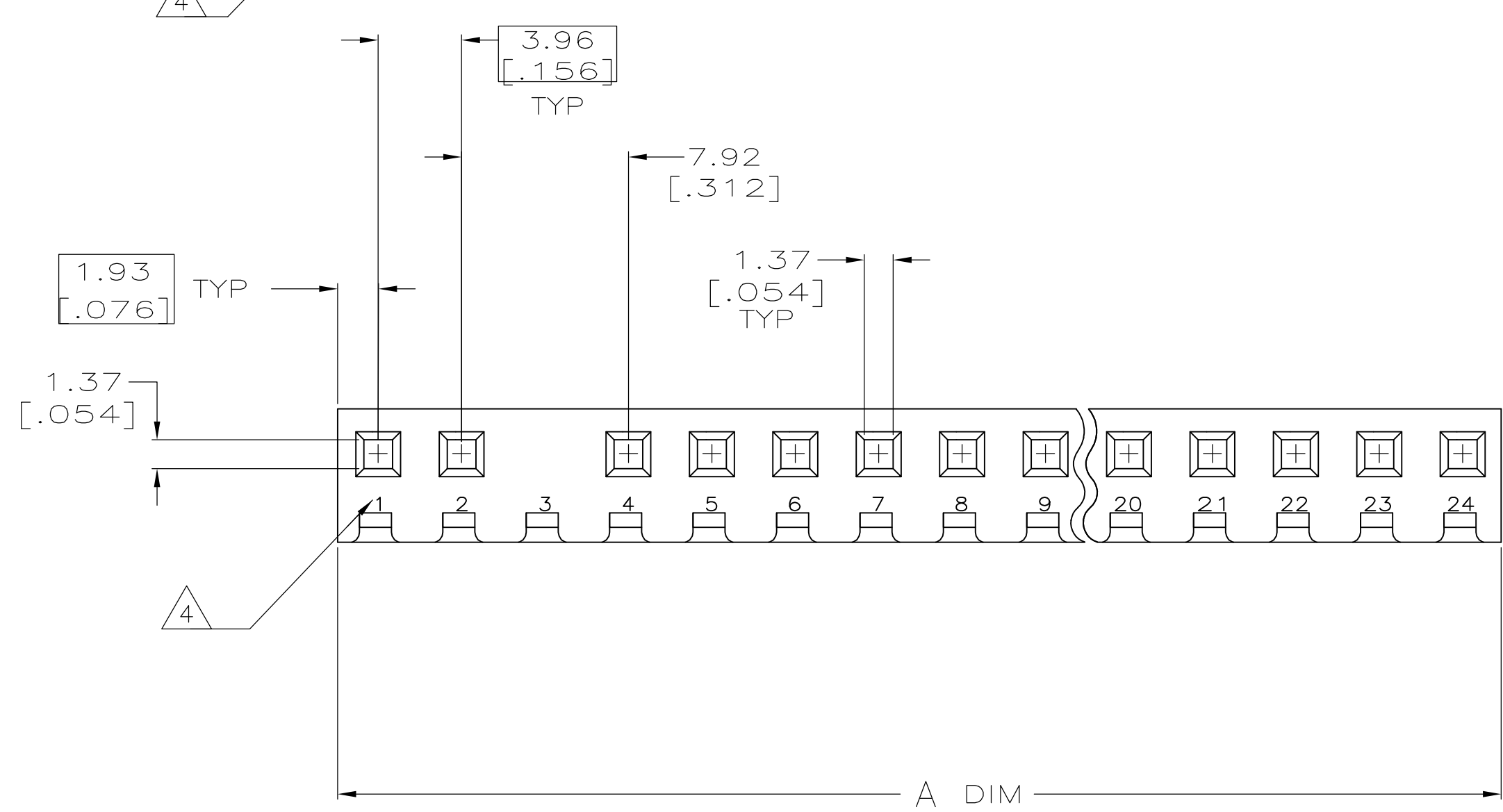
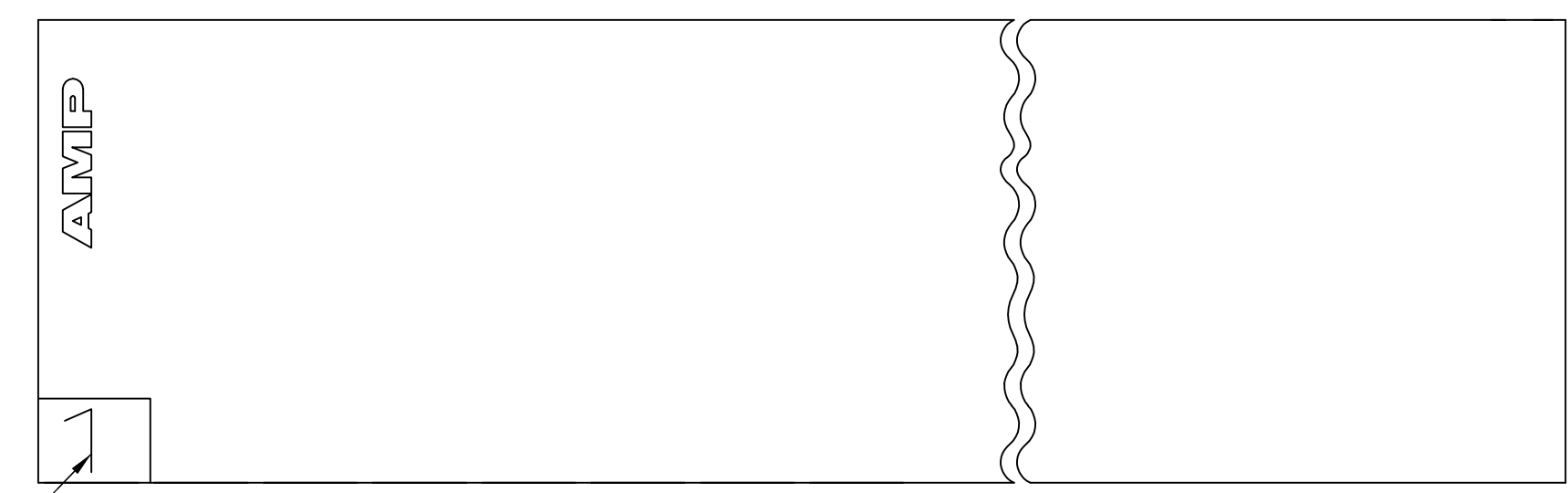

3-DIMENSIONAL MODEL NTS

27.69 [1.090]	7	647370-7
A #0.25 [.010]	NO. OF CIRCUITS	PART NUMBER
DIN L. McEACHIN 14-JUN-2000 CHK J. ELLIS 14-JUN-2000 APVD J. ELLIS 14-JUN-2000 PRODUCT SPEC		<b>STE</b> TE Connectivity
DIMENSIONS: mm [INCHES] TOLERANCES UNLESS OTHERWISE SPECIFIED: 0. PLC ± - 1. PLC ± - 2. PLC ± - 3. PLC ± 0.13 [.005] 4. PLC ± - ANGLES ± -		NAME SL-156 HOUSING, SPECIAL, CIRCUIT 3 BLOCKED, BLACK APPLICATION SPEC SIZE CAGE CODE DRAWING NO. RESTRICTED TO WEIGHT A1 00779 C=647370
MATERIAL NYLON, UL 94V-0 FINISH -		CUSTOMER DRAWING SCALE 4:1 SHEET 1 OF 1 REV A