

## DETAILS

<b>Product Number</b>	C13556_BRIDGET-M-UNI
<b>Family</b>	Bridget
<b>Type</b>	Reflector
<b>Color</b>	metal
<b>Diameter</b>	22,6 mm
<b>Height</b>	12,8 mm
<b>Style</b>	hexag
<b>Optic Material</b>	PC
<b>Holder Material</b>	
<b>Fastening</b>	glue
<b>Status</b>	production ready
<b>ROHS Compliant</b>	Yes
<b>Date Updated</b>	11/12/2015

## OPTICAL PROPERTIES

LED	Viewing	Light	Effi-	cd/lm	Connector
	Angle	Beam	ciency		
BXRA ES Star	48 deg	Medium	84 %	1.200	-
CLL02x/CLU02x (LES10)	52 deg	Medium	84 %	1.100	-
CLU700/701	34 deg	Medium	85 %	1.700	-
CXA/B 15xx	47 deg	Medium	84 %	1.200	-
XP-L HI	20 deg	Medium	86 %	3.000	-
CXM-9	53 deg	Medium	85 %	1.020	-
Soleriq P6	35 deg	Medium	80 %	1.660	-
Soleriq P9	50 deg	Medium	84 %	1.200	-
Soleriq S9	sim: 51	Medium	sim: 88 %	sim: 1.200	-
COB D Series LES 9.8 mm	53 deg	Medium	86 %	1.000	-
Mini Zenigata (GW5BM)	49 deg	Medium	84 %	1.200	-
SLE G5 LES6	30 deg	Medium	84 %	1.850	-
SLE G5 LES11	56 deg	Medium	83 %	0.950	-



Relative intensity of C13556\_BRIDGET-M-UNI\_(XP-L\_HI)

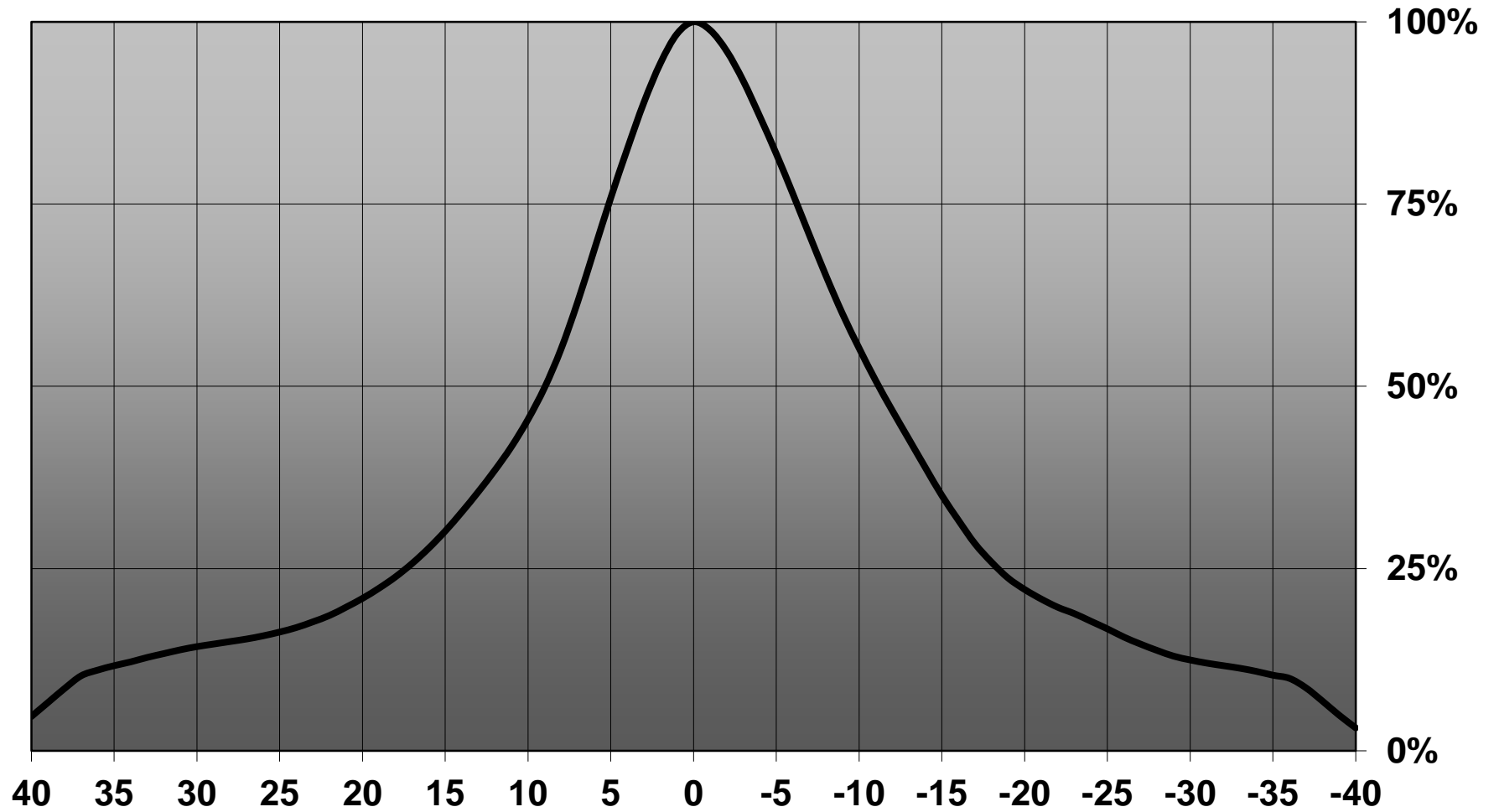

Relative intensity of C13556\_BRIDGET-M-UNI\_(Soleriq P6)

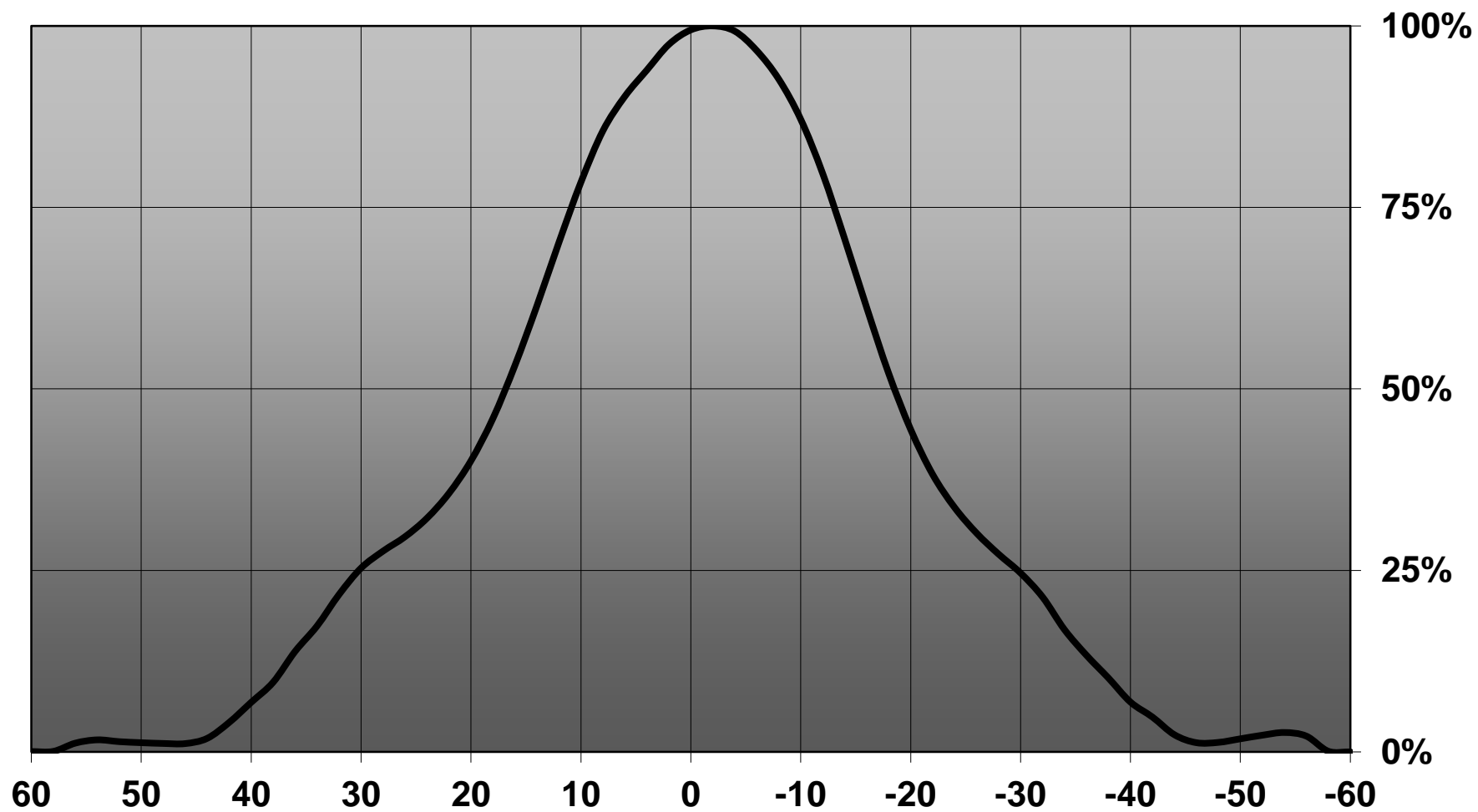

Relative intensity of C13556\_BRIDGET-M-UNI\_(Soleriq P9)

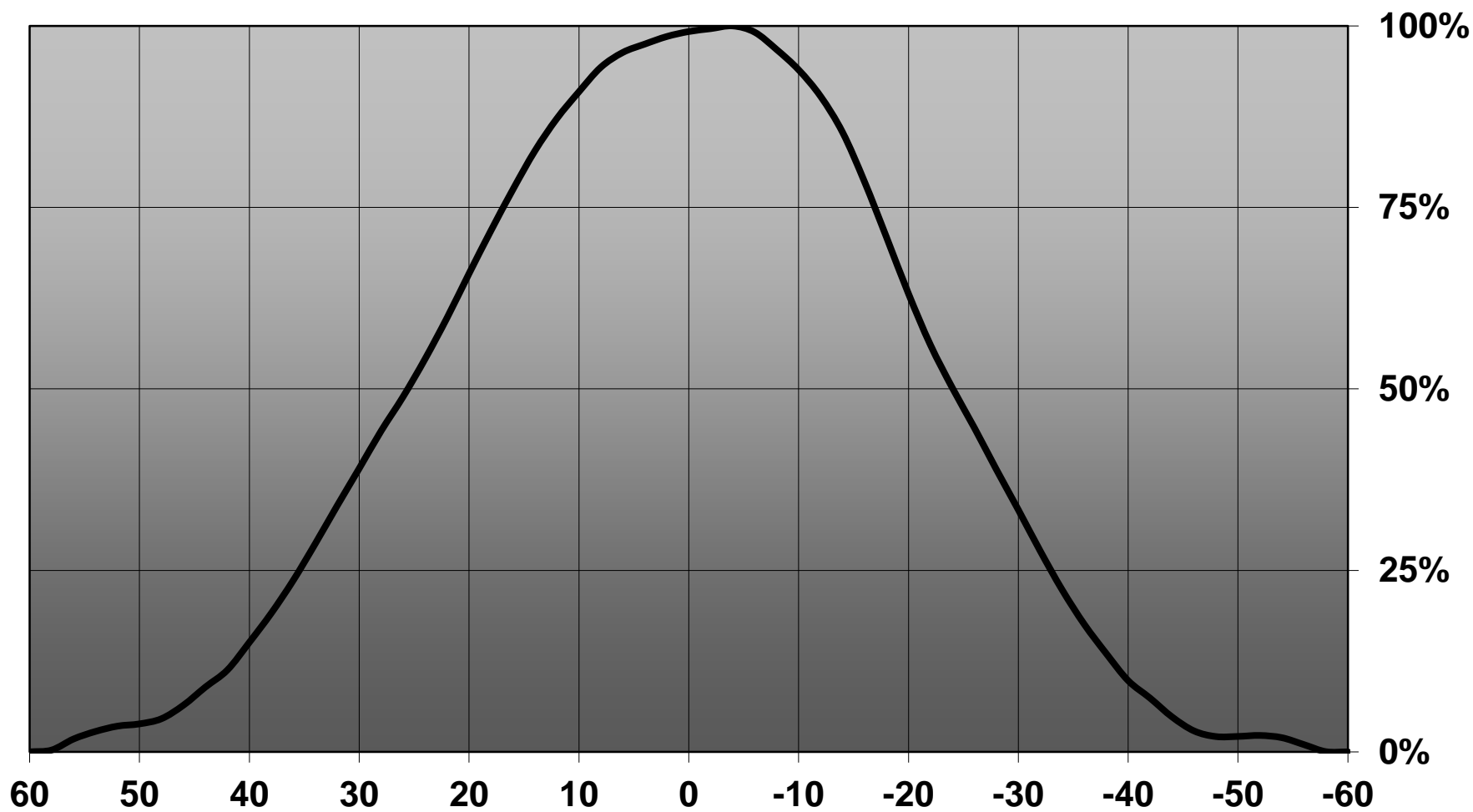

D

C

B

A

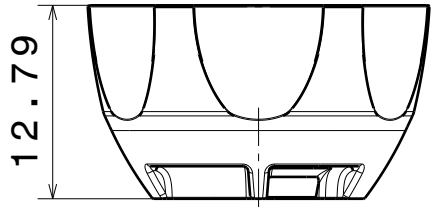

Front view

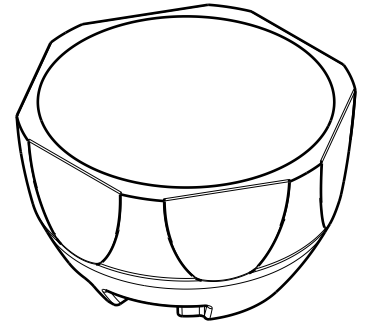

Isometric view

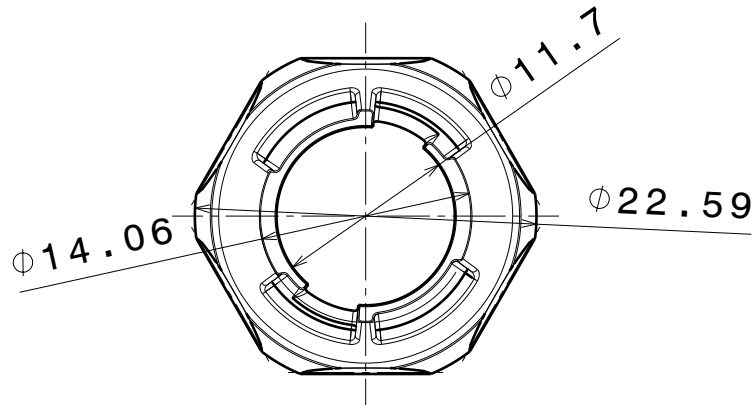

Bottom view

Tolerances if not otherwise shown  
 According to DIN ISO 2768-1  
 Linear measures:  
 Up to 30mm class M, otherwise class C.  
 According to DIN ISO 2768-2  
 Form and position: class L

LEDiL

Ledil Oy  
 Salorankatu 10  
 FIN 24240 SALO  
 Finland

THIRD ANGLE PROJECTION:

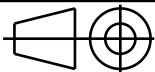

DRAWING TITLE

BRIDGET\_UNI\_Datasheet

This drawing is the property  
 of LEDiL Oy. It may not be  
 reproduced, copied or  
 communicated without a written  
 agreement with LEDiL Oy."

SIZE	PART NUMBER
A4	-

SCALE	2:1	WEIGHT	-
-------	-----	--------	---

SHEET	1/1
-------	-----

D

A

Luminaire: LEDil Oy C13556\_BRIDGET-M-UNI\_(BXRA\_ES\_STAR) Efficiency=84%  
Lamps: 1 x Bridgelux BXRA ES Star (C0402) 203lm @ 250mA CCT=7300K P=2.2W I=250mA

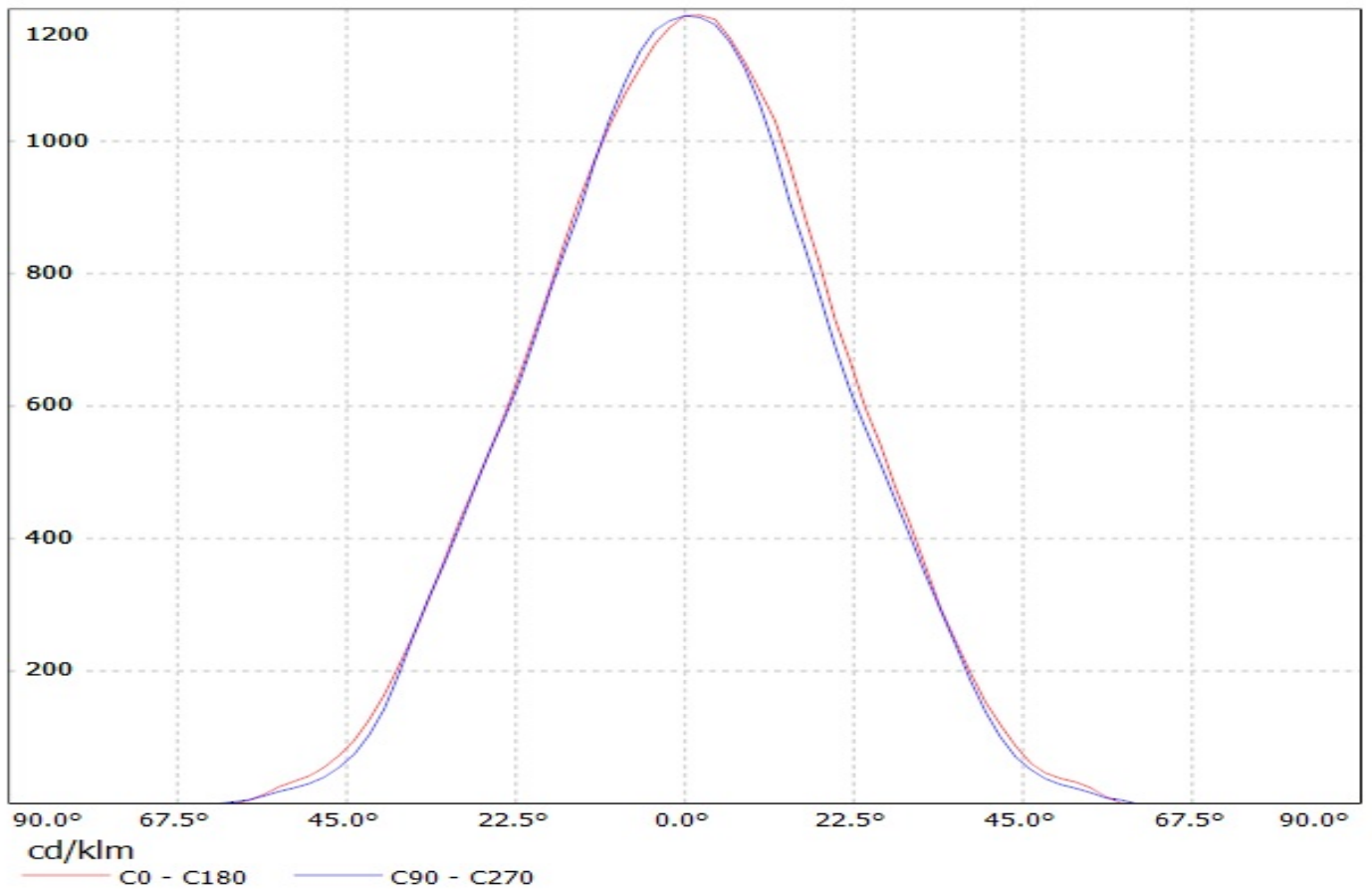

Luminaire: LEDil Oy C13556\_BRIDGET-M-UNI\_(CLL020) Efficiency=84%  
Lamps: 1 x Citizen CLL020 (CLL020.1202A5-303H1A7) 515lm @ 250mA CCT=3000K P=9.3W I=250mA

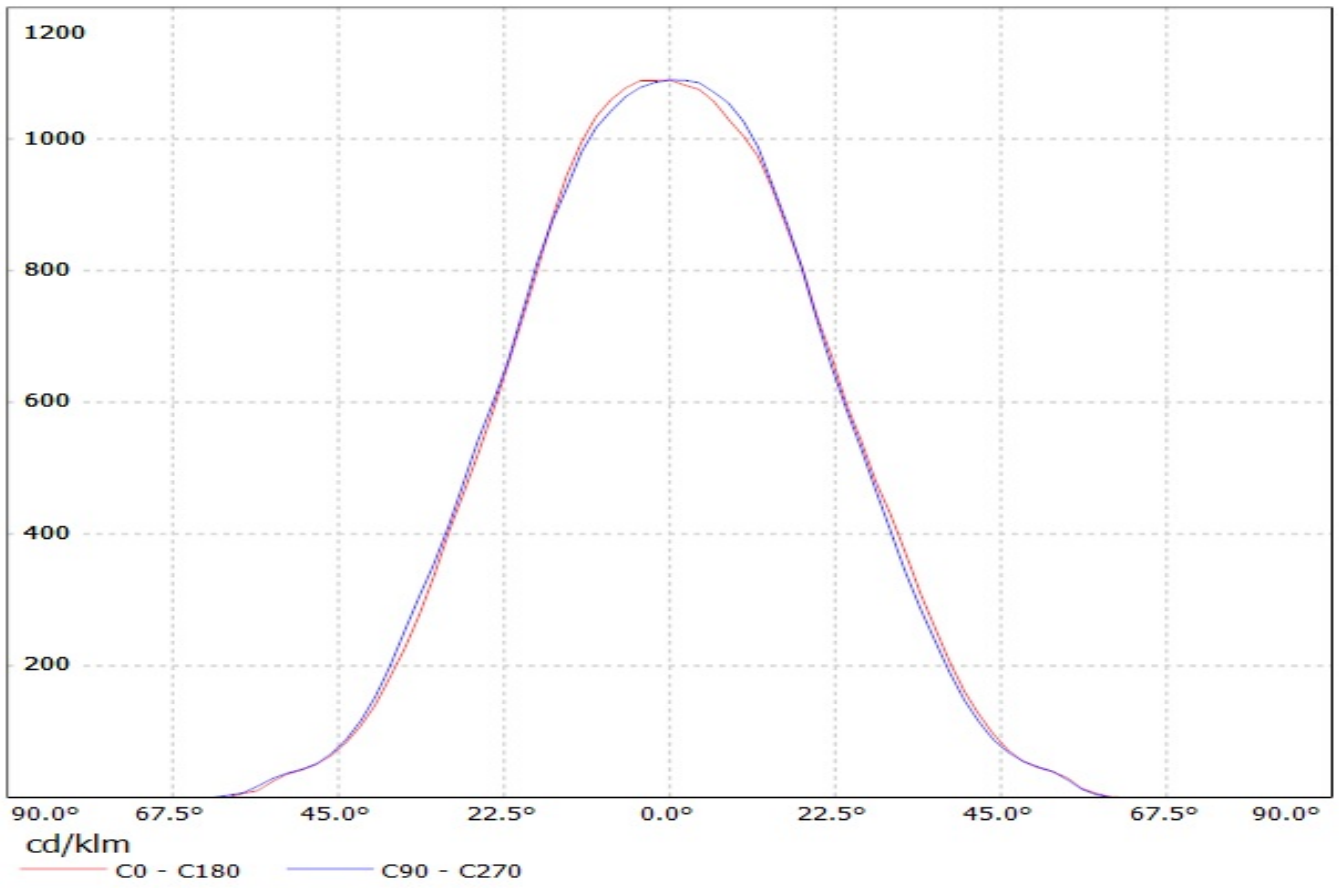

Luminaire: Ledil C13556\_BRIDGET-M-UNI\_(CLU700)  
Lamps: 1 x Citizen\_CLU700\_394.637lm@100mA\_P=2.8W\_I=0.10A

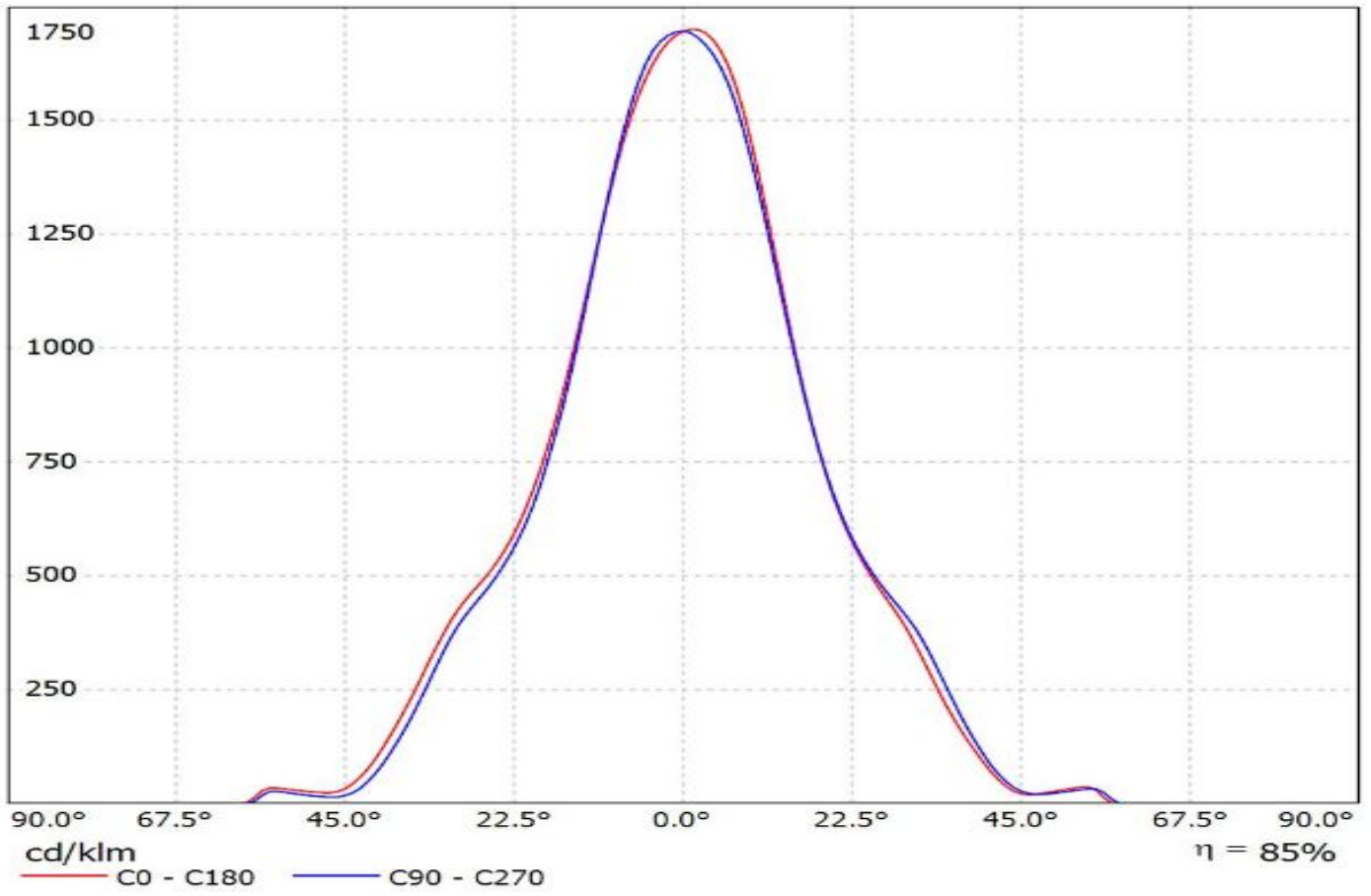



Luminaire: LEDil Oy C13556\_BRIDGET-M-UNI\_(CXA15) Efficiency=84%  
Lamps: 1 x Cree CXA15 (CXA1507-30F-F2-N0A-00000) 218lm @ 50mA CCT=3100K P=1.7W I=50mA

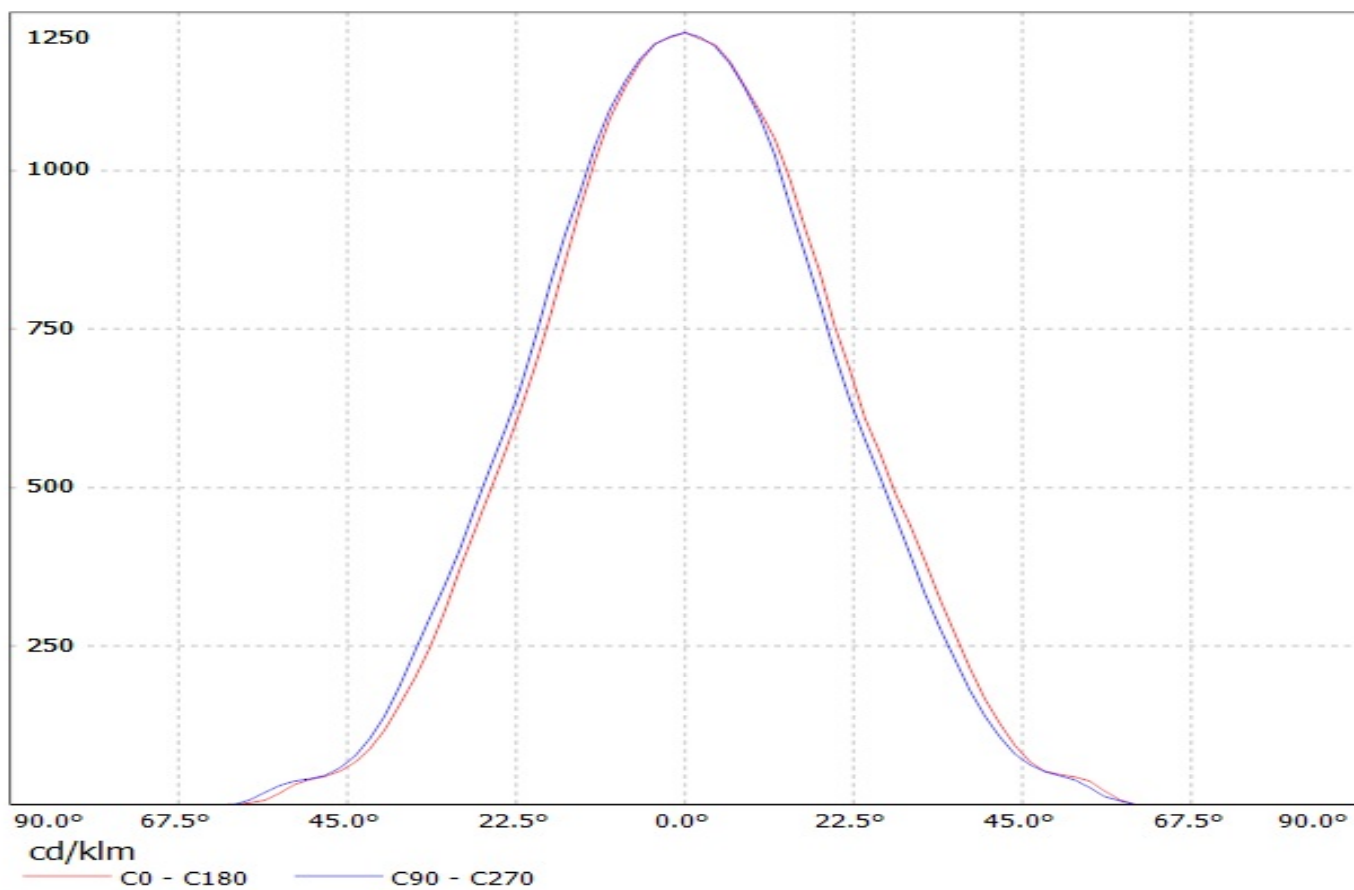

Luminaire: LEDiL Oy C13556\_BRIDGET-M-UNI\_(CXM-9)

Lamps: 1 x Luminus\_XNOVA\_CXM-9\_(AA00)\_977.302lm@240mA\_P=8.28264W\_I=240mA

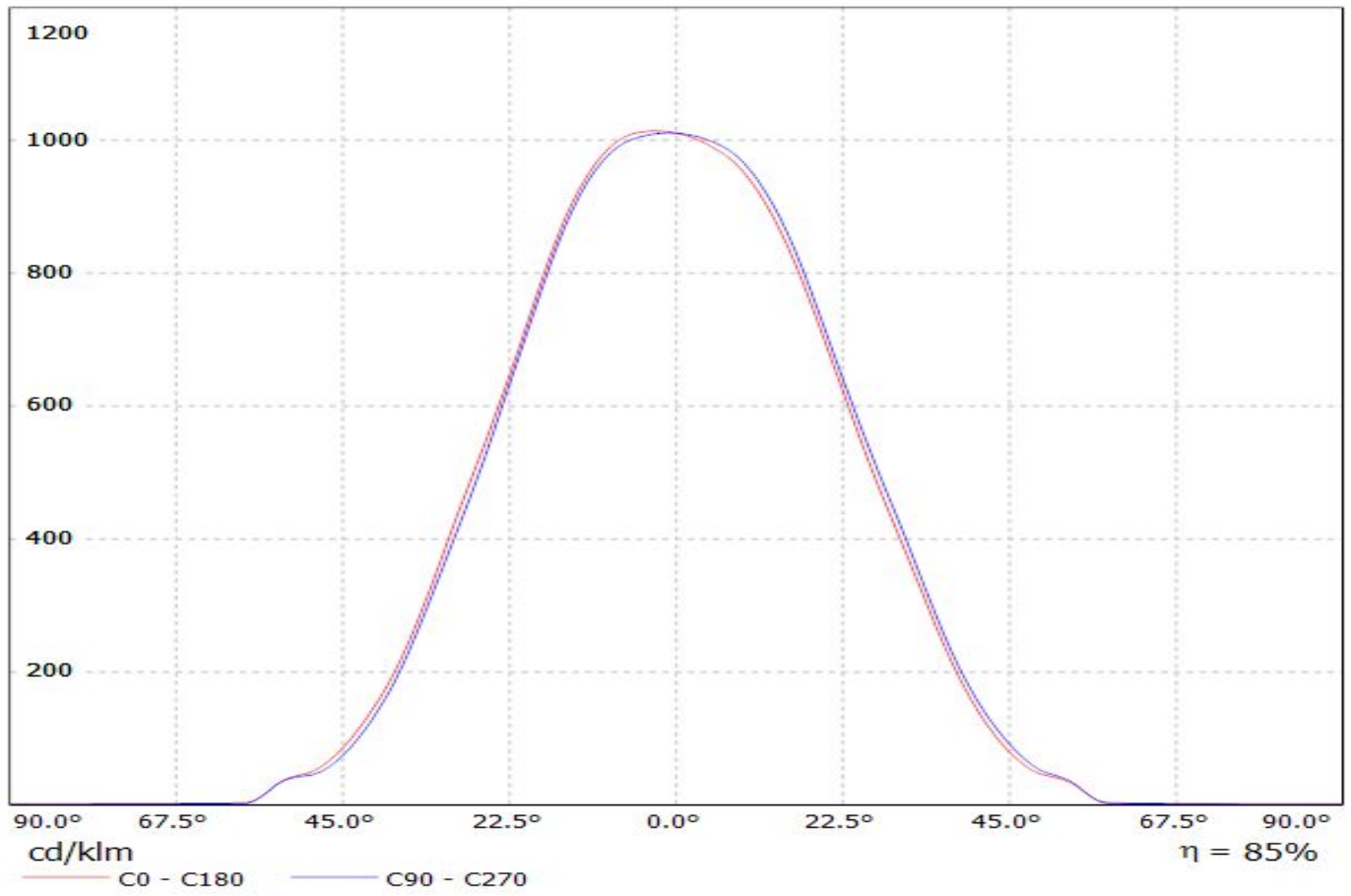

Luminaire: Ledil Oy C13556\_BRIDGET-M-UNI\_(Soleriq\_S9)\_SIMULATED  
Lamps: 1 x Osram Soleriq S9 (GW KAFJB3.EM)

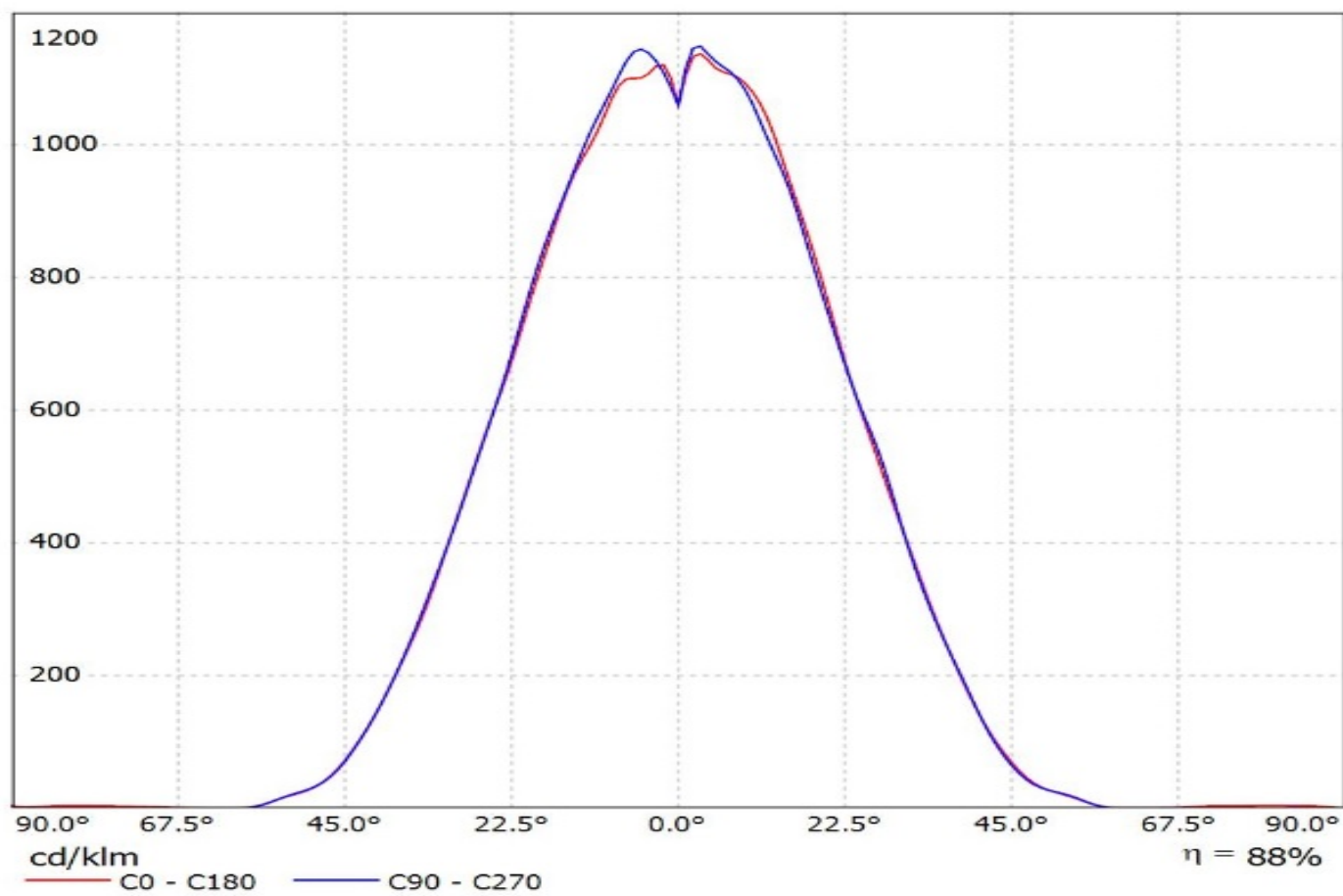

Luminaire: LEDiL Oy C13556\_BRIDGET-M-UNI\_(COB\_D\_LES\_9.8mm)  
Lamps: 1 x Samsung\_COB\_D\_series\_LES\_9.8mm\_LC013D\_534.999lm@100mA\_P=3.1948W\_I=0.100A

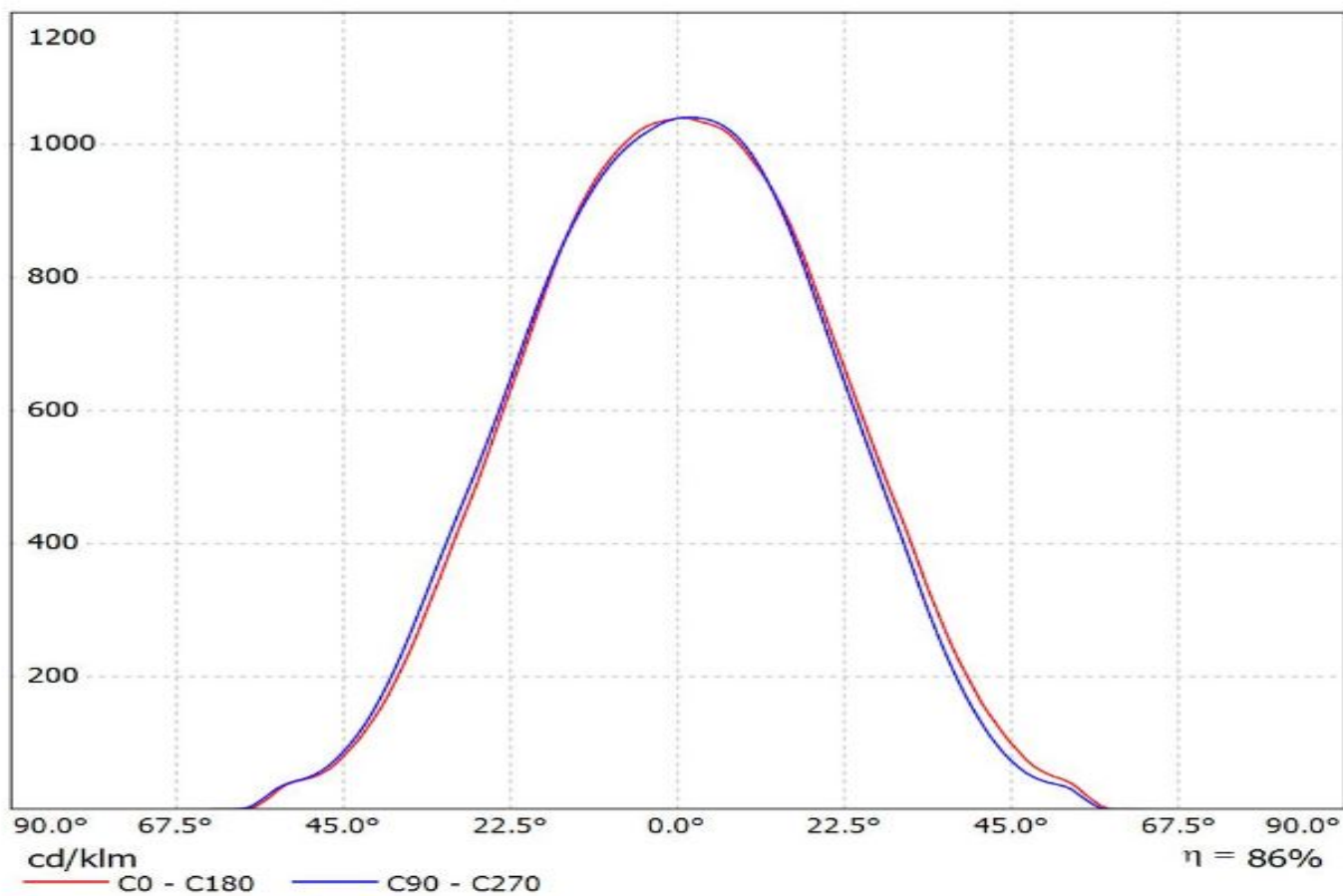

Luminaire: LEDil Oy C13556\_BRIDGET-M-UNI\_(Mini\_Zenigata\_GW5BJT) Efficiency=84%  
Lamps: 1 x Sharp Mini Zenigata (GW5BTJ) 378lm @ 250mA CCT=4100K P=4.5W I=250mA

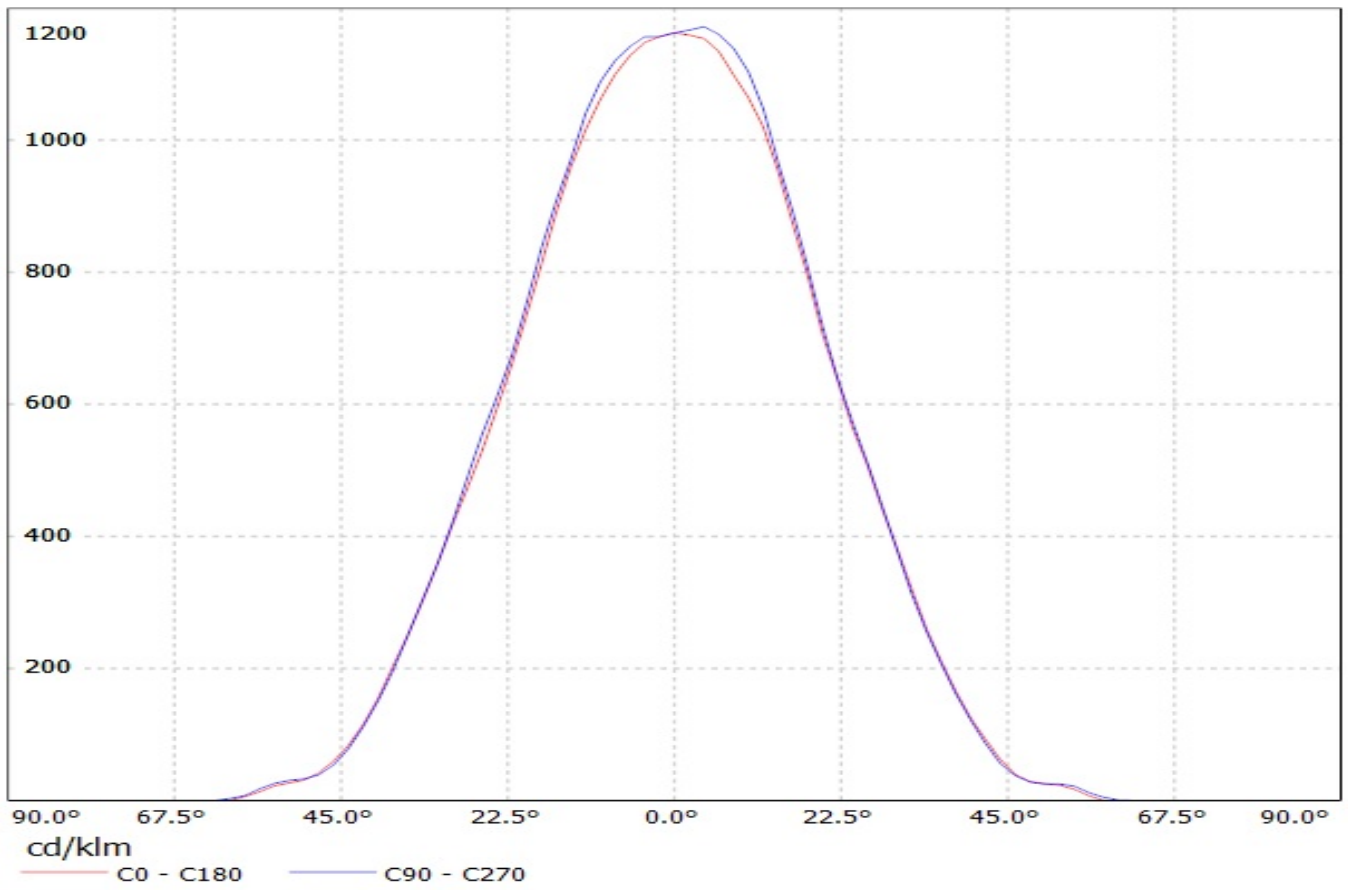

Luminaire: LEDiL Oy C13556\_BRIDGET-M-UNI\_(SLE-G5\_LES-6)  
Lamps: 1 x Tridonic\_SLE-G5\_LES-6\_470.59lm@100mA\_P=3.3748W\_I=0.100A

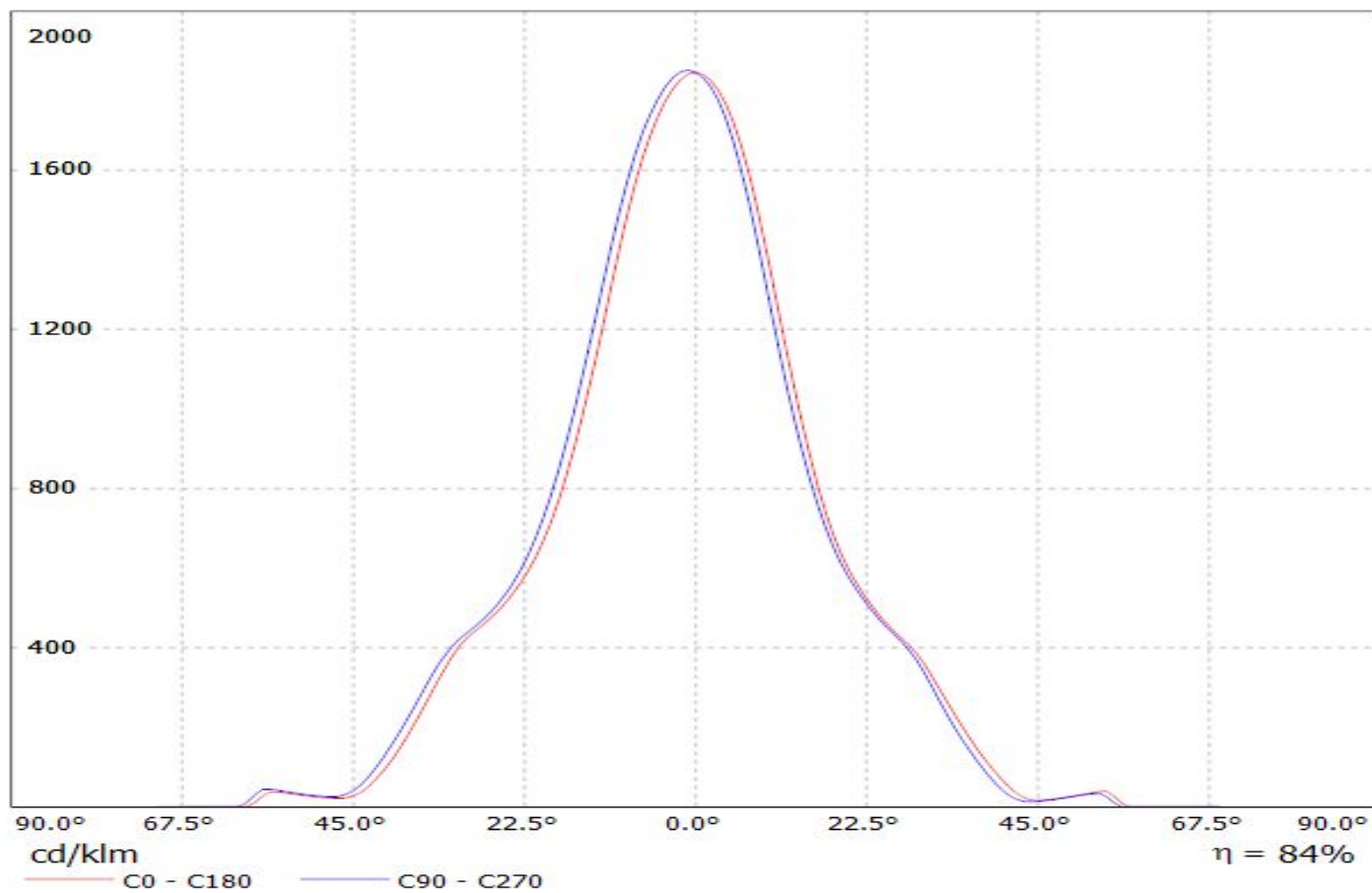

Luminaire: LEDiL Oy C13556\_BRIDGET-M-UNI\_(SLE-G5\_LES-11)

Lamps: 1 x Tridonic\_SLE-G5\_LES-11\_1168.86lm@250mA\_P=8.3243W\_I=0.250A

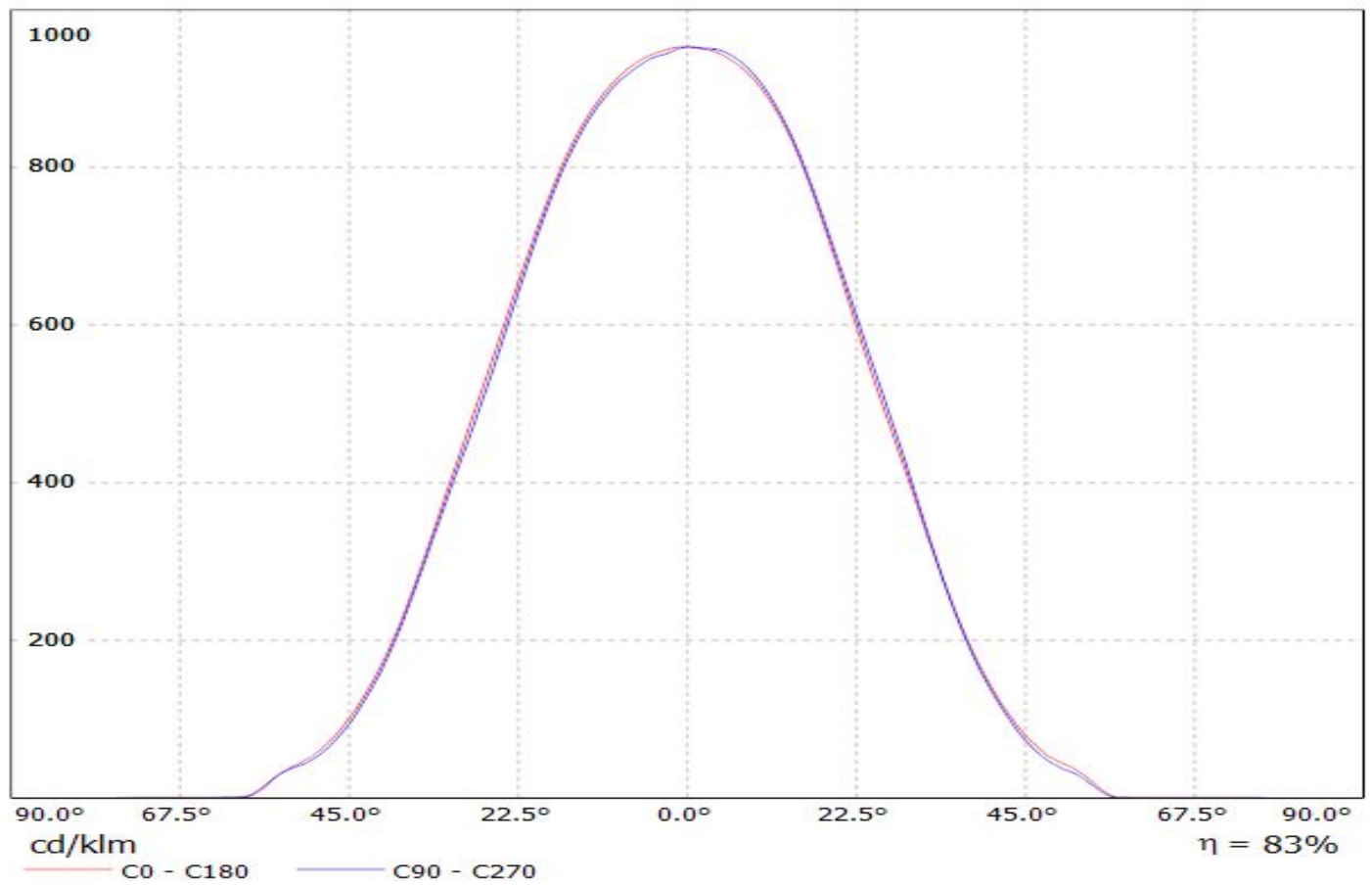

Luminaire: LEDil Oy C13556\_BRIDGET-M-UNI\_(BXRA\_ES\_STAR) Efficiency=84%  
Lamps: 1 x Bridgelux BXRA ES Star (C0402) 203lm @ 250mA CCT=7300K P=2.2W I=250mA

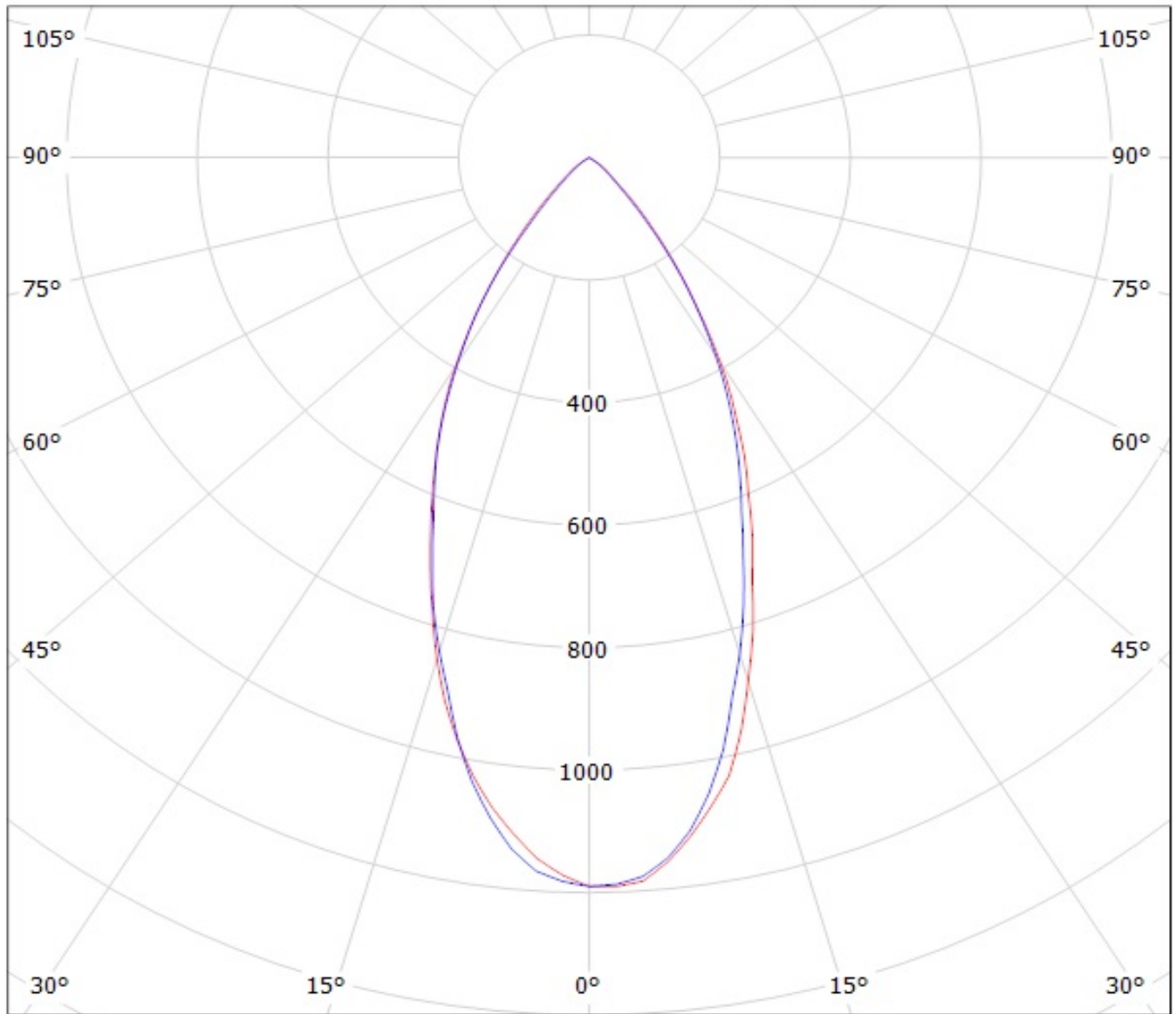

cd/klm

— C0 - C180    — C90 - C270



Luminaire: LEDil Oy C13556\_BRIDGET-M-UNI\_(CLL020) Efficiency=84%

Lamps: 1 x Citizen CLL020 (CLL020.1202A5-303H1A7) 515lm @ 250mA CCT=3000K P=9.3W I=250mA

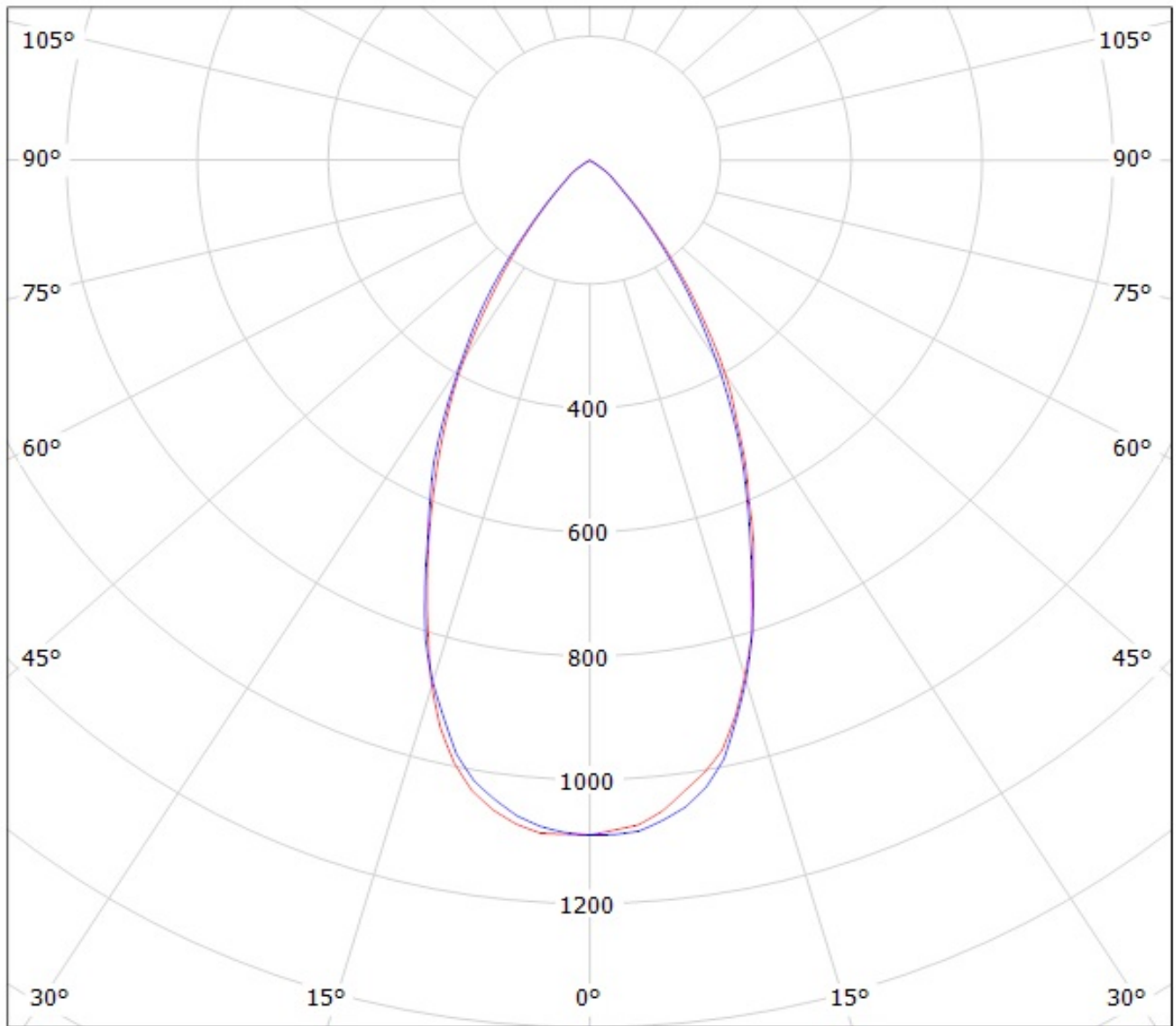

cd/klm

— C0 - C180

— C90 - C270

Luminaire: Ledil C13556\_BRIDGET-M-UNI\_(CLU700)  
Lamps: 1 x Citizen\_CLU700\_394.637lm@100mA\_P=2.8W\_I=0.10A

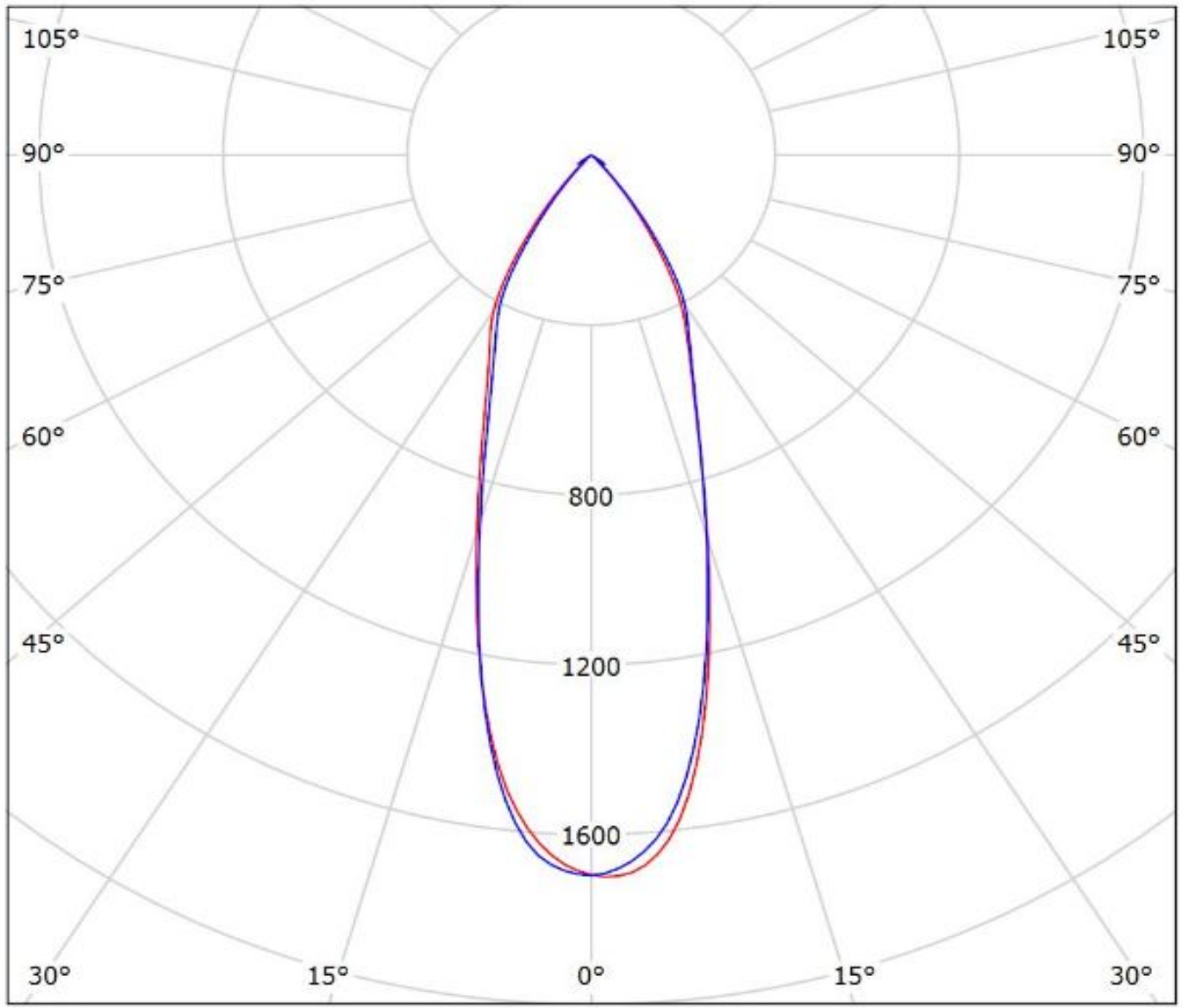

cd/klm  
— C0 - C180 — C90 - C270

$\eta = 85\%$

Luminaire: LEDil Oy C13556\_BRIDGET-M-UNI\_(CXA15) Efficiency=84%

Lamps: 1 x Cree CXA15 (CXA1507-30F-F2-N0A-00000) 218lm @ 50mA CCT=3100K P=1.7W I=50mA

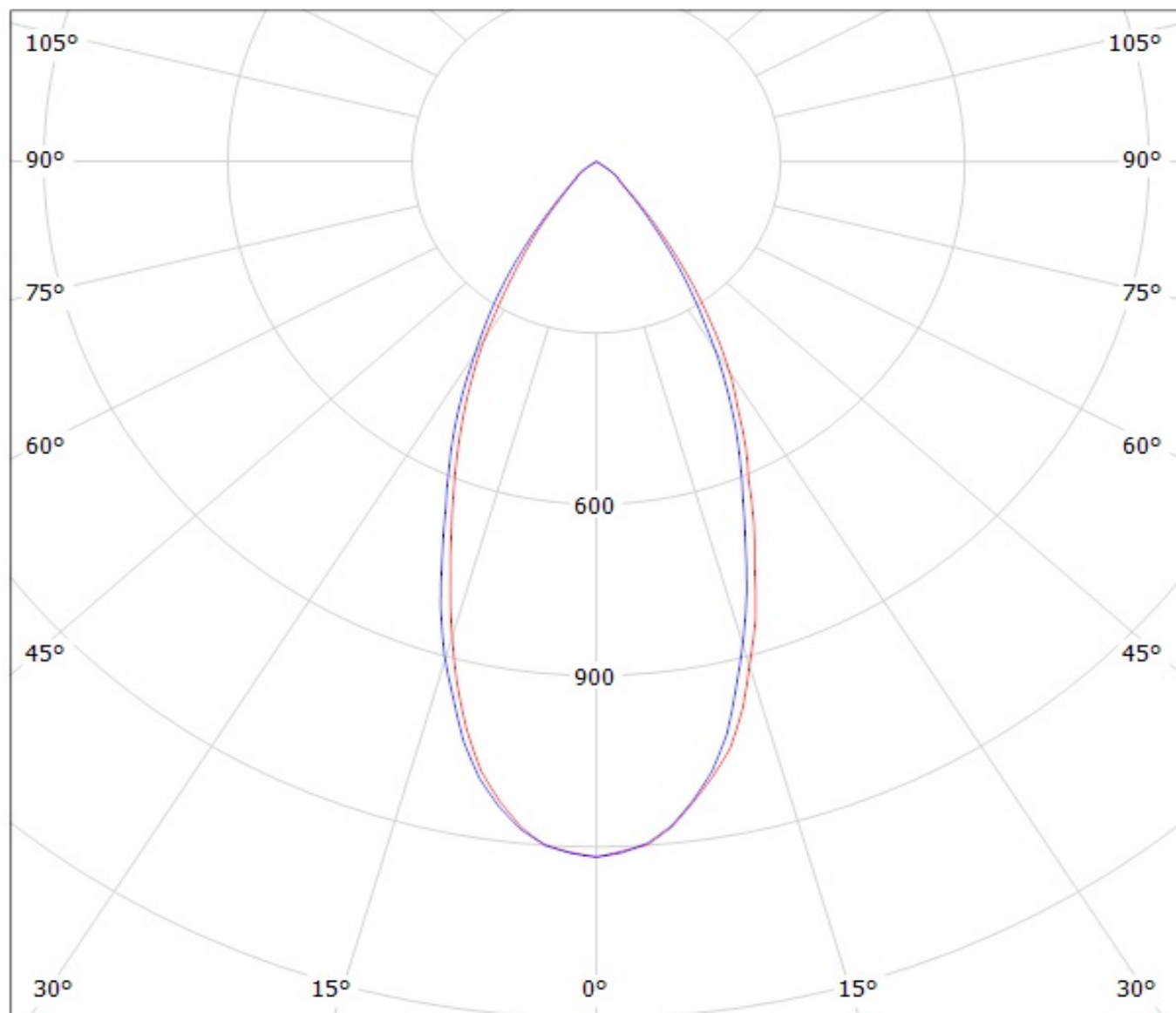

cd/klm

— C0 - C180

— C90 - C270

Luminaire: LEDiL Oy C13556\_BRIDGET-M-UNI\_(CXM-9)

Lamps: 1 x Luminus\_XNOVA\_CXM-9\_(AA00)\_977.302lm@240mA\_P=8.28264W\_I=240mA

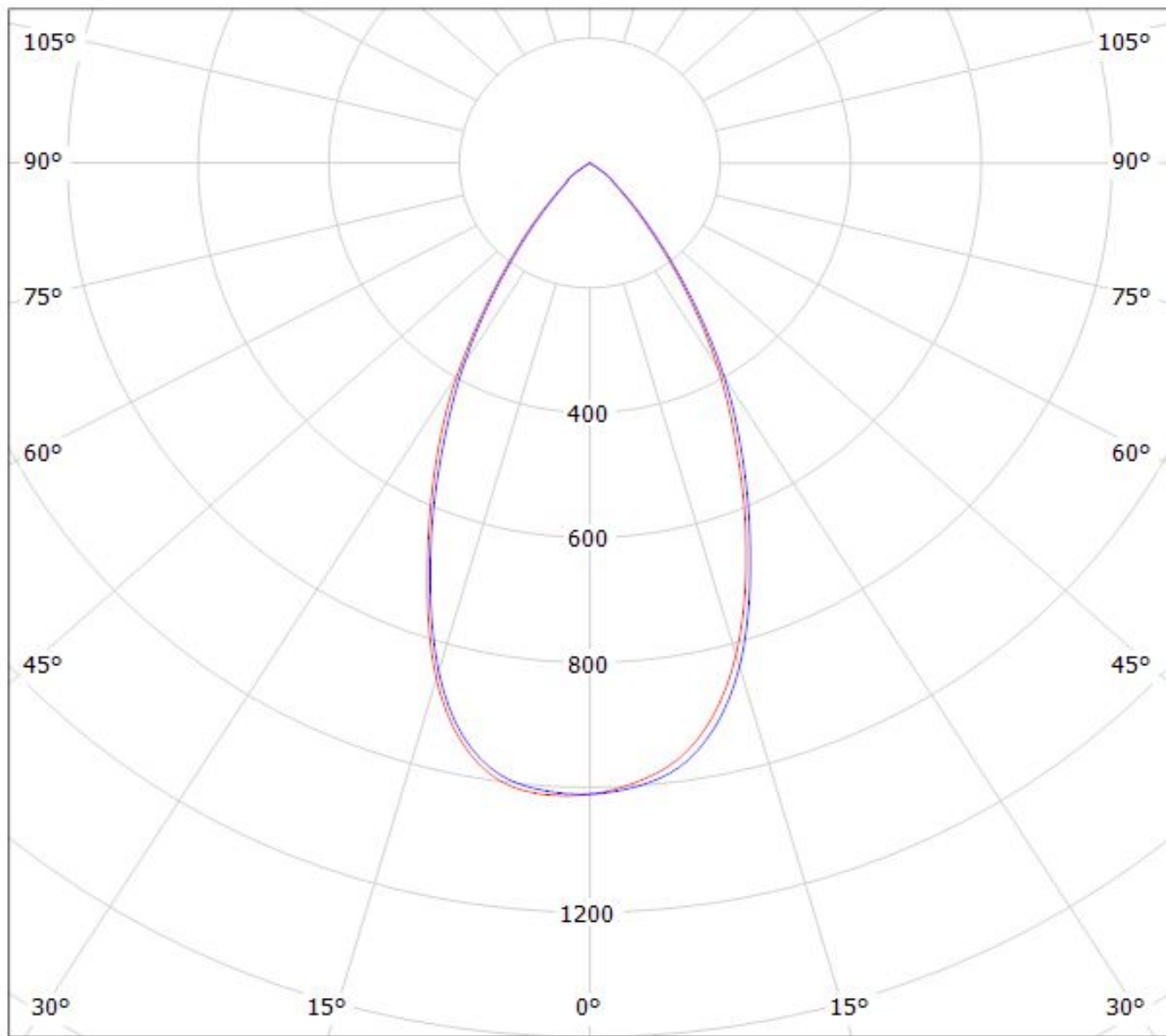

cd/klm

$\eta = 85\%$

— C0 - C180

— C90 - C270

Luminaire: Ledil Oy C13556\_BRIDGET-M-UNI\_(Soleriq\_S9)\_SIMULATED  
Lamps: 1 x Osram Soleriq S9 (GW KAFJB3.EM)

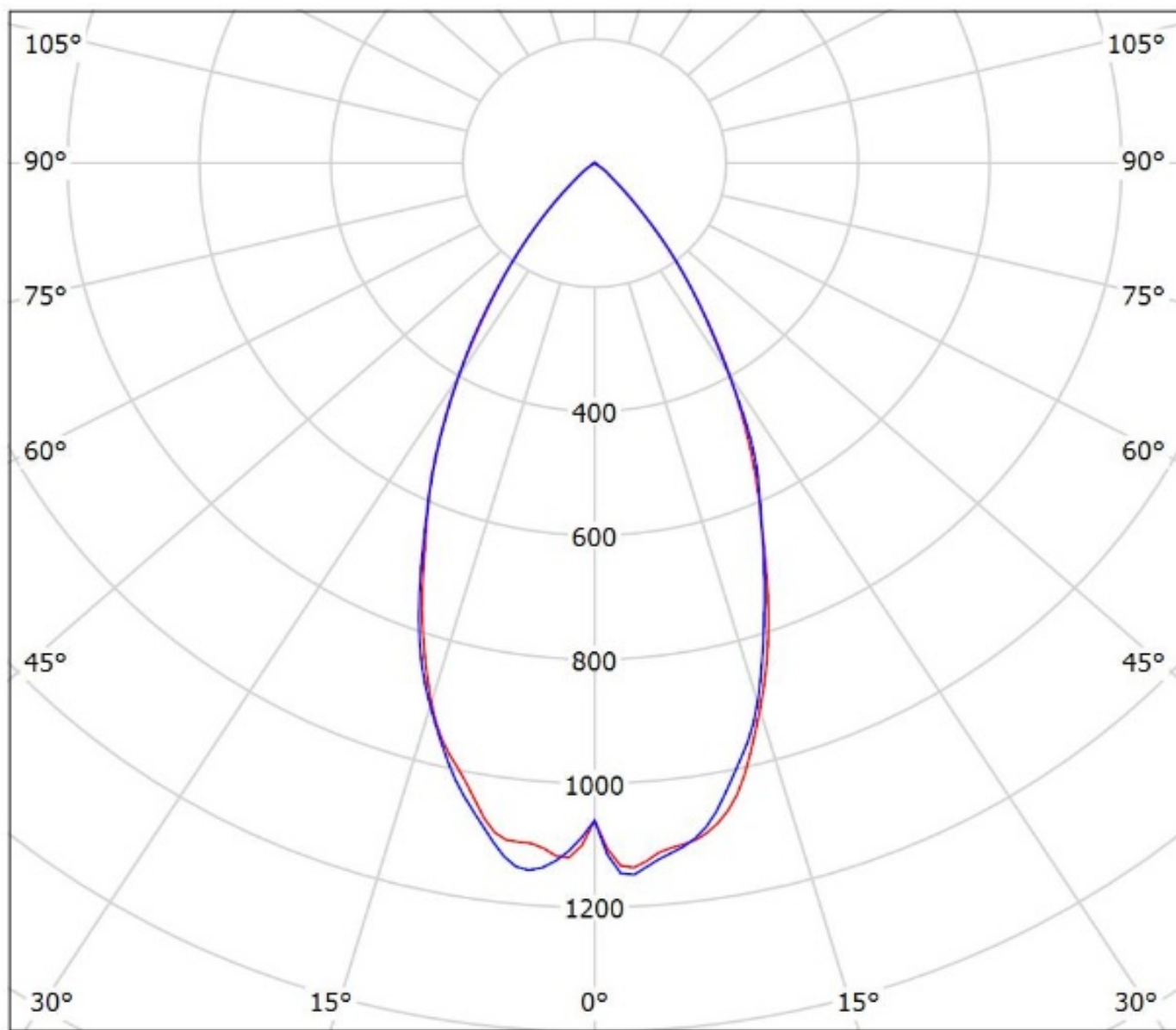

cd/klm  
— C0 - C180 — C90 - C270

$\eta = 88\%$

Luminaire: LEDiL Oy C13556\_BRIDGET-M-UNI\_(COB\_D\_LES\_9.8mm)

Lamps: 1 x Samsung\_COB\_D\_series\_LES\_9.8mm\_LC013D\_534.999lm@100mA\_P=3.1948W\_I=0.100A

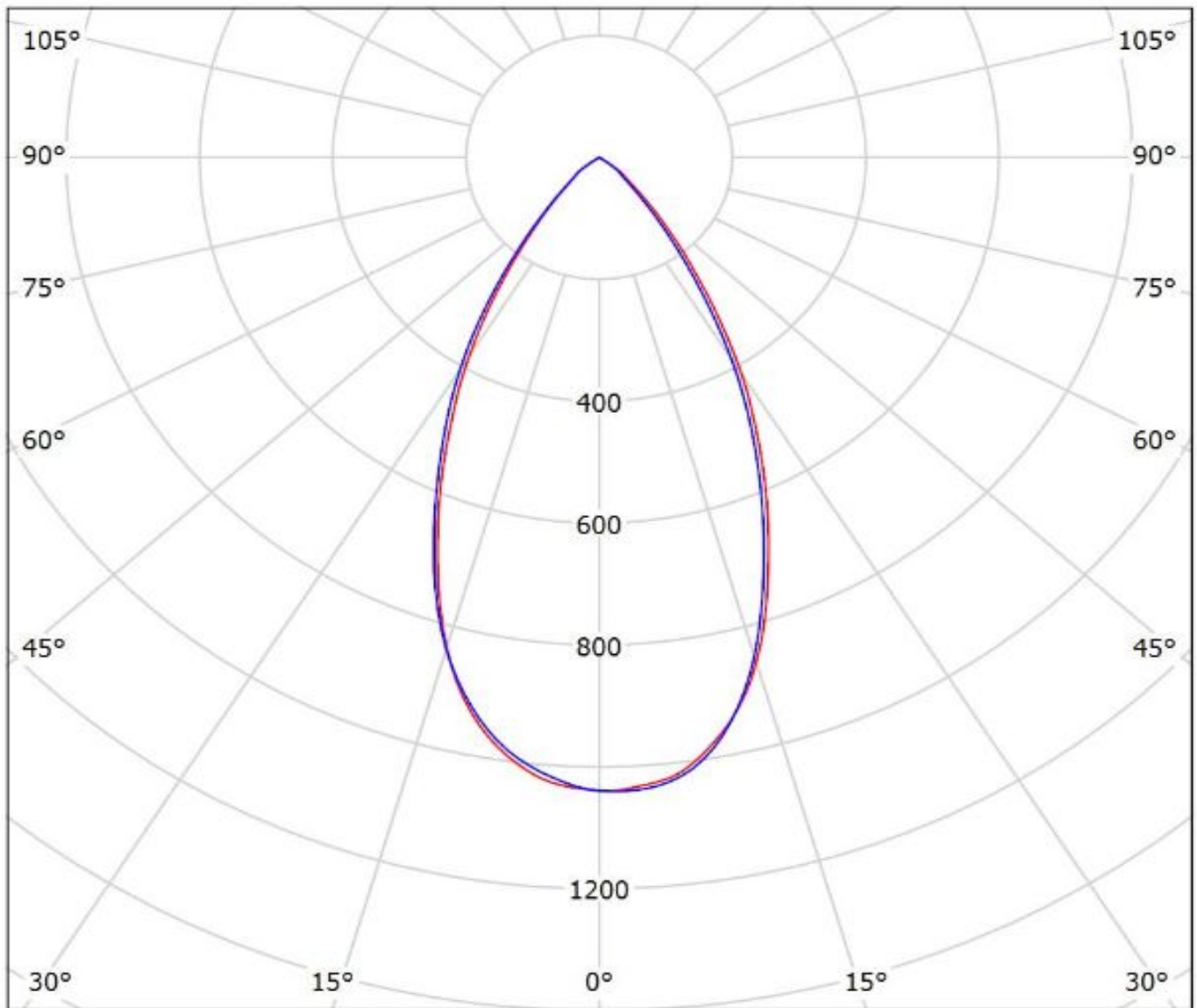

cd/klm

— C0 - C180 — C90 - C270

$\eta = 86\%$

Luminaire: LEDil Oy C13556\_BRIDGET-M-UNI\_(Mini\_Zenigata\_GW5BJT) Efficiency=84%  
Lamps: 1 x Sharp Mini Zenigata (GW5BTJ) 378lm @ 250mA CCT=4100K P=4.5W I=250mA

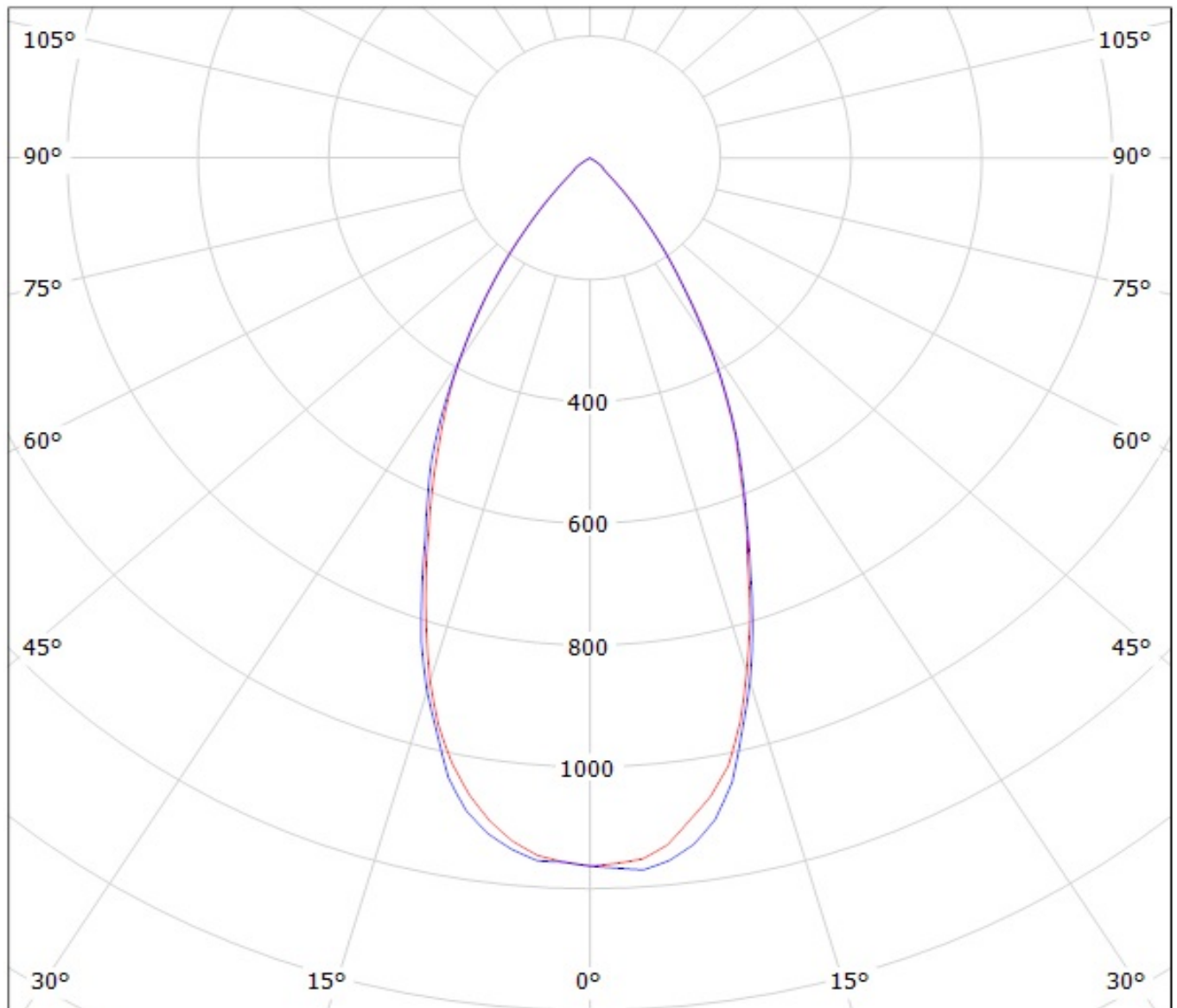

cd/klm

— C0 - C180

— C90 - C270

Luminaire: LEDiL Oy C13556\_BRIDGET-M-UNI\_(SLE-G5\_LES-6)

Lamps: 1 x Tridonic\_SLE-G5\_LES-6\_470.59lm@100mA\_P=3.3748W\_I=0.100A

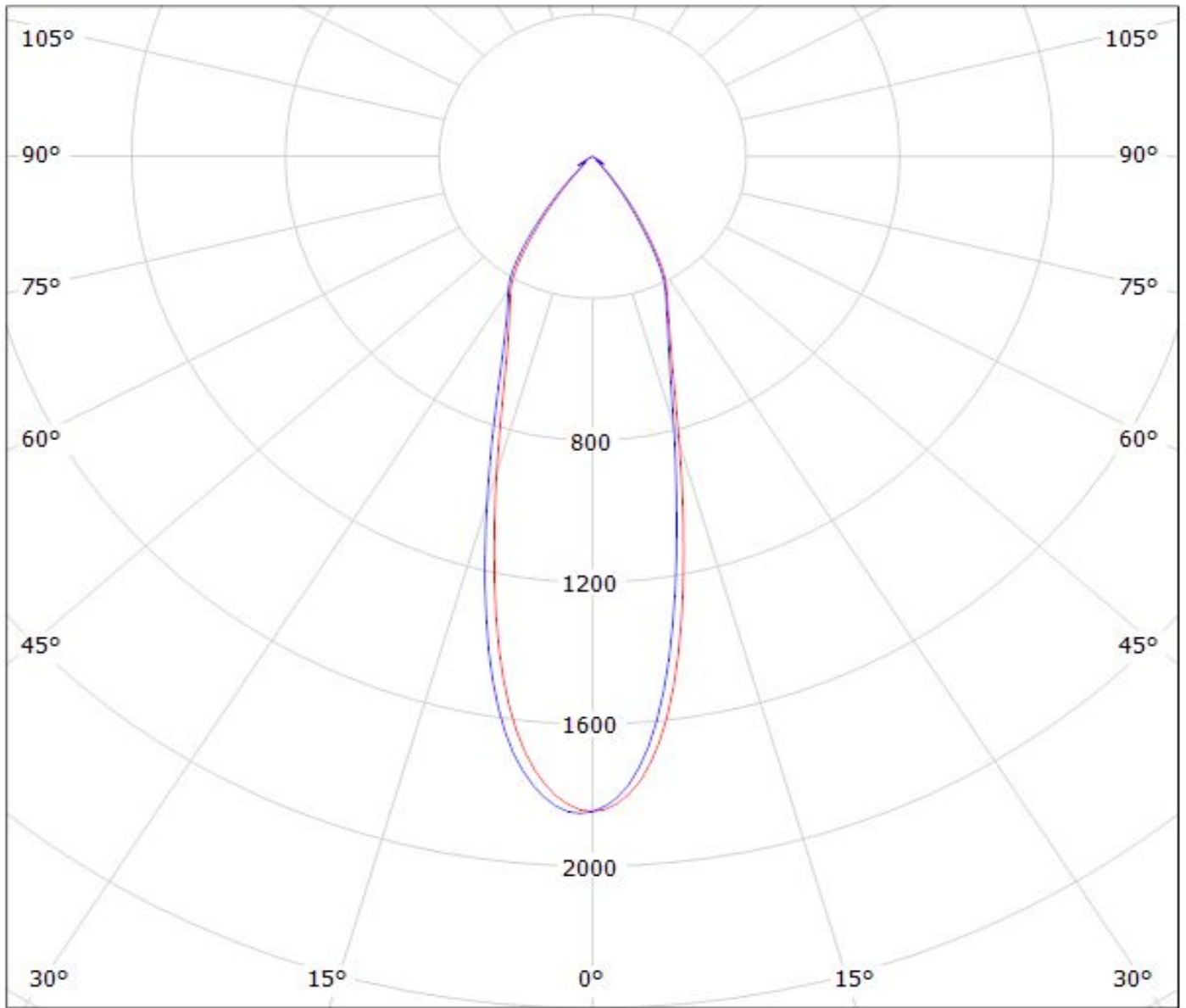

cd/klm

$\eta = 84\%$

— C0 - C180    — C90 - C270



Luminaire: LEDiL Oy C13556\_BRIDGET-M-UNI\_(SLE-G5\_LES-11)

Lamps: 1 x Tridonic\_SLE-G5\_LES-11\_1168.86lm@250mA\_P=8.3243W\_I=0.250A

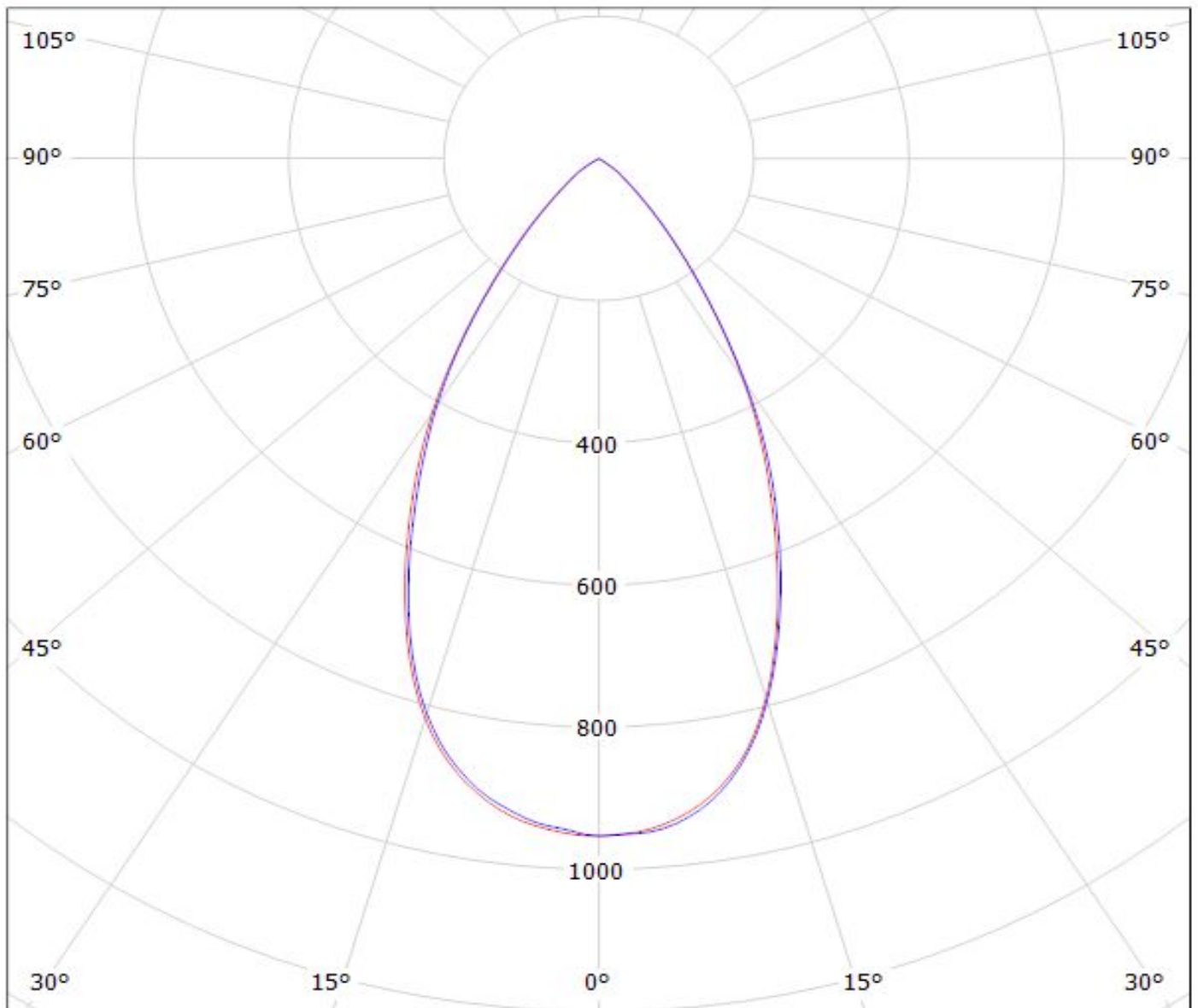

cd/klm

— C0 - C180    — C90 - C270

$\eta = 83\%$

**NOTE: The typical divergence will be changed by different color, chip size and chip position tolerance. The typical total divergence is the full angle measured where the luminous intensity is half of the peak value.**

### **GENERAL INFORMATION**

- Product series especially designed & optimized for series of LEDs.
- Special care taken to make light distribution as uniform as possible.

Note! Due to use of high power COB's with this product, special attention to proper thermal design is highly recommended. LEDiL has no liability for direct, indirect or consecutive damages arising from the LEDiL products being used outside of the recommended temperature range.